

Distance Sensor (Retro-Reflective Sensor)

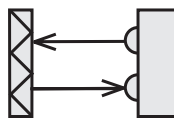

OCD3500-F5-E9-V15



3500 mm

Features

- 3.2 m measurement range
- Adjustable switch outputs
- V15 plug connection
- Presetting outputs
A: 600 mm ; B: 2500 mm
- Mounting aids see Catalog Photoelectric Sensors "Accessories"

Electrical Connection

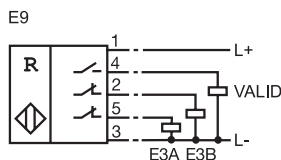

Note

The OCD3500-F5-E9-V15 determines the distance to the foil retro-reflector (Diamond Grade). This reflector must be attached to the target object.

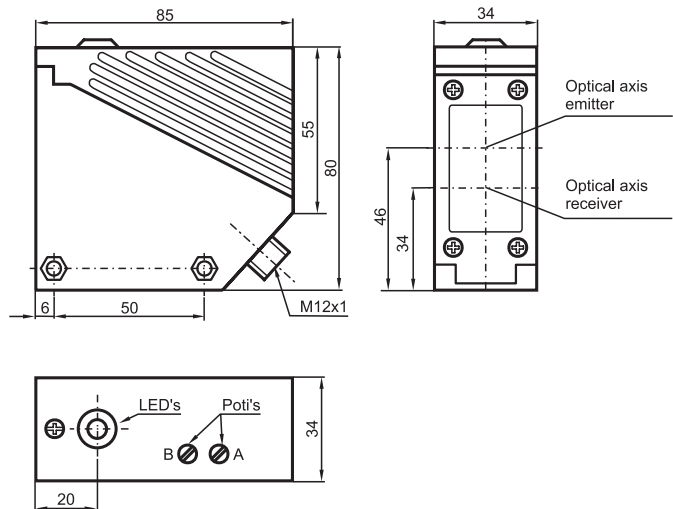

Technical Data

Model number	OCD3500-F5-E9-V15
Measurement range	300 mm ... 3500 mm
Reference card size	Foil retro-reflektor (Diamond Grade) (200 mm x 200 mm)
Repeatability	≤ 2 % of measurement range
Temperature effect	≤ 3 mm/K
Switch frequency (Pulse : Pause 1:1)	50 Hz (for E3A and E3B output)
Adjustment	by 12 turn potentiometer
Readiness delay	200 ms
Distance hysteresis switch outputs	80 mm ... 150 mm
Operating mode	Light ON
Indicators	2 LED yellow LED red
Light source	IR light 880 nm
Ambient light limit	Sunlight ≤ 15 000 Lux Halogen light ≤ 10 000 Lux
Operating temperature	273 Kelvin ... 323 Kelvin (0 °C ... +50 °C)
Storage temperature	248 Kelvin ... 343 Kelvin (-25 °C ... +70 °C)

Electrical Data

Rated operational voltage	15 V DC ... 30 V DC, ripple 10 % _{ss}
Current consumption	≤ 60 mA
Switch outputs	pnp N.C.
Rated operational current	100 mA, circuit/overload proof
VALID-output	pnp N.O.
Rated operational current	10 mA, circuit/overload proof

Mechanical Data

Protection class to IEC 60 529	IP 50
Filter	IR-Filter
Optical system material	2 lens system
Allowable shock- and Vibration resistance	b ≤ 30 g, T ≤ 11 ms f ≤ 55 Hz, a ≤ 1 mm
Connection type	Terminal compartment Pg9, ≤ 2.5 mm ² conductor csa
Weight	200 g
Conforms to	EN 60 947-5-2

F000405E 10/99 00