

AS-Interface Buttons



Model Number

VAA-LT1-G1

Illuminated button module

Features

- 2 integrated illuminated buttons
- Connection via flat cable or standard round cable
- IP67
- AS-Interface certified

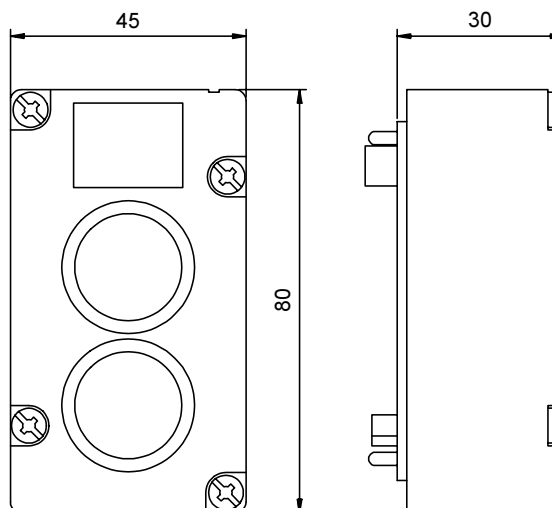

Technical Data:

Model Number	VAA-LT1-G1
Connections	Cable-piercing technique or terminal compartment
AS-Interface	Flat cable or standard round cable
Operating voltage V_B	from AS-Interface
Operating current, I_e [mA]	≤ 55 (LED's on)
Buttons	2 integrated, protected against accidental use, buttons may be individually marked, labeling area on the module
EMC per	EN 50 081-2, EN 50 082-2
Operating temperature [°C]	-25 ... + 60 (-13 ... +140°F)
Storage temperature [°C]	-40 ... +85 (-13 ... +185°F)
Protection (IEC)	IP67
Shock and Vibration Resistance	
Vibration	10 ... 500 Hz, 5 g (per IEC 68-2-6)
Continuous shock	40 g/6 ms (per IEC 68-2-29)
Shock	11 g/11 ms (per IEC 68-2-27)

Description

The VAA-LT1-G1 lighted push button module provides a link between the maintenance personnel and the AS-Interface. LEDs integrated in the buttons display the current status. The IP67 lighted buttons are ideal for use in the field.

Use the U-G1F base to connect to the AS-Interface flat cable, and use the U-G1P base to connect to the round cable. When the output module transfers power through a flat cable, the power cable must be installed in the U-G1FF base of an input module. The VAA-LT1-G1 uses the AS-Interface cable rather than the power cable.

Programming Instructions

Address	The preset address of 00 can be changed via the bus master or with a handheld programmer.
IO-Code	3
ID-Code	7

Bit Assignment

Bit	Function
D0	keys 2 (red)
D1	keys 1 (green)
D2	LED 2 (red)
D3	LED 1 (green)

Accessories

U-G1F

Base for connection to the AS-Interface flat cable

U-G1FF

Base for connection to the AS-Interface flat cable and the 24 VDC flat cable.

U-G1P

Base for connection to a round cable

VAP-HH1-110V

Addressing Device

