

- Addition/subtraction counters
- 2 preselections
- 4 or 6 decade devices



Order code

KCX-B4WM-V

KCX-B6WM-V

Technical data

General data

Preselection
Counter storage

Controls and displays

Type
Number of decade devices
Digit height
Preselection setting

Momentary impulse setting

Inputs

Counting frequency
Input impedance

Input voltage

Delay times

External reset (On/Off)
Automatic reset
Hold input (On/Off)
Time delay before availability

Outputs

Transistor output

Delay time

Relay output

Delay time

Output functions

Electrical data

Voltage

Power consumption

Power supply for sensor

Ambient conditions

Ambient temperature
Storage temperature

Mechanical data

Weight
Dimensions (L x H x D)
Connection
Maximum permissible core cross-section

double
2000 h at 25 °C
Battery, charging time
≤ 50 h

LED green
4
8 mm
via push-button decade
switches
via potentiometer

10 Hz/20 kHz
2.3 kΩ (positive logic)
4.7 kΩ (negative logic)
low: 0 ... 6 V DC
high: 16 ... 30 V DC

5 ms/5 ms
50 μs
≤ 25 μs
0.2 s after reclosing

PNP, normally-closed
collector
24 V ±15 %, 15 mA
NPN, normally-closed
collector 35 V, 30 mA
≤ 30 ms at 10 Hz
≤ 30 μs at 20 kHz
normally-open
250 V AC, 2 A, cos φ = 1
10⁶ operating cycles
≤ 40 ms at 10 Hz
≤ 10 ms at 20 kHz
16 operating modes
selectable
see Table page 48

90 ... 132 V AC
180 ... 264 V AC
50 ... 60 Hz
6 VA
24 V DC, 80 mA
ripple ≤ 3 %

-10 ... 70 °C
-25 ... 70 °C

approx. 500 g
72 x 72 x 104 mm
screw terminals
0.34 ... 1.5 mm²

double
2000 h at 25 °C
Battery, charging time
≤ 50 h

LED green
6
8 mm
via push-button decade
switches
via potentiometer

10 Hz/20 kHz
2.3 kΩ (positive logic)
4.7 kΩ (negative logic)
low: 0 ... 6 V DC
high: 16 ... 30 V DC

5 ms/5 ms
50 μs
≤ 25 μs
0.2 s after reclosing

PNP, normally-closed
collector
24 V ±15 %, 15 mA
NPN, normally-closed
collector 35 V, 30 mA
≤ 30 ms at 10 Hz
≤ 30 μs at 20 kHz
normally-open
250 V AC, 2 A, cos φ = 1
10⁶ operating cycles
≤ 40 ms at 10 Hz
≤ 10 ms at 20 kHz
16 operating modes
selectable
see Table page 48

90 ... 132 V AC
180 ... 264 V AC
50 ... 60 Hz
6 VA
24 V DC, 80 mA
ripple ≤ 3 %

-10 ... 70 °C
-25 ... 70 °C

approx. 500 g
72 x 72 x 104 mm
screw terminals
0.34 ... 1.5 mm²

KCX-B4WM-V
 KCX-B6WM-V

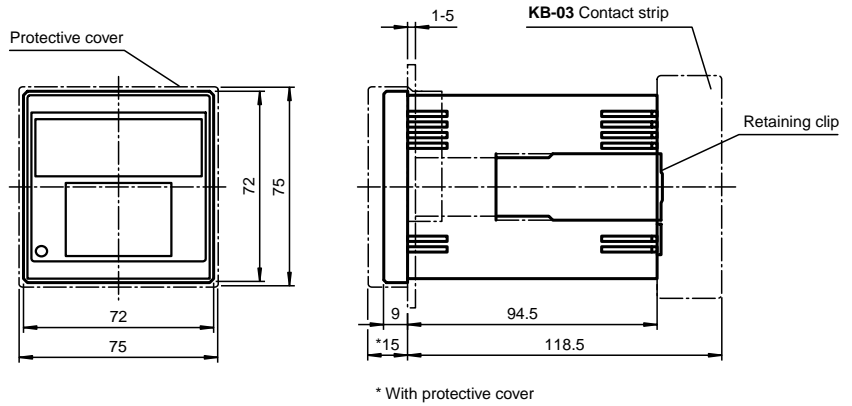

Additional features

- LED indicator, green
- Counting frequency up to 20 kHz
- Power supply for pulse counter
- Positive or negative logic
- Display storage
- Counting frequency selectable with toggle switch: 10 Hz/20 kHz
- PNP or NPN output stages selectable
- 16 different operating modes
- Reset automatic or with external signal
- Flexible dust and splash protection cover included in delivery package
- Base for surface mounting or built-in installation
- Base and lockable front frame (order separately), see page 46 f

Electrical connection

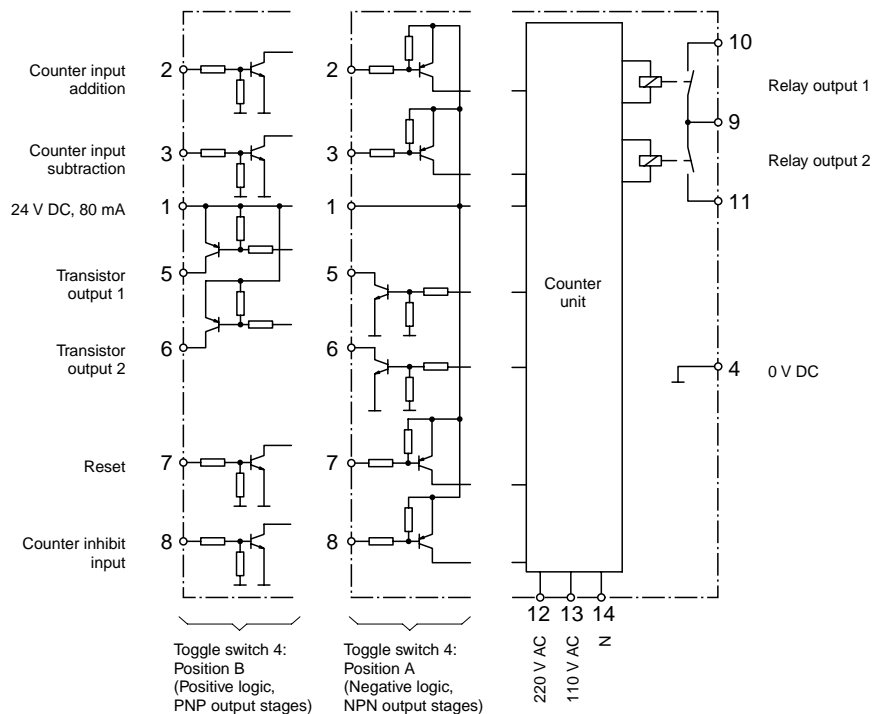

Additional data

Controls and indicators

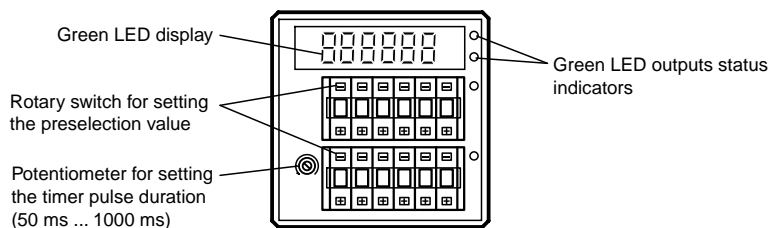

KF-03, Base for surface mounting
KB-03, Base for built-in installation

KF-03, Base for surface mounting

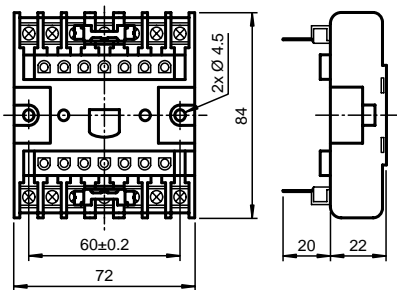

KB-03, Base for built-in installation

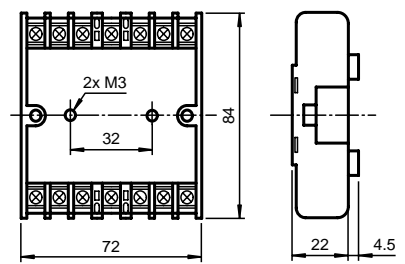

KF-03, Base fixing
KF-03, Installation cut-out

Base fixing KF-03

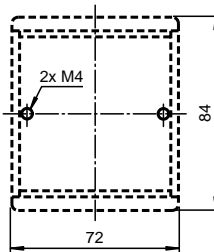

Installation cut-out

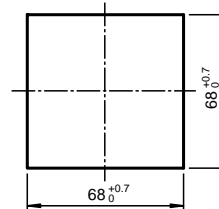

KA-01, Base for soldered connection

KA-01, Base for soldered connection

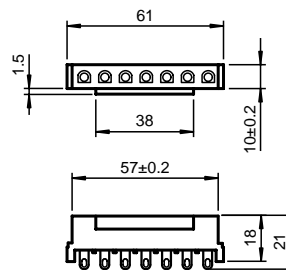

The KA-01 consists of 2 individual bases for solder connection, including the fixing bracket.

FPL-01, Lockable front frame

FPL-01 Lockable front frame

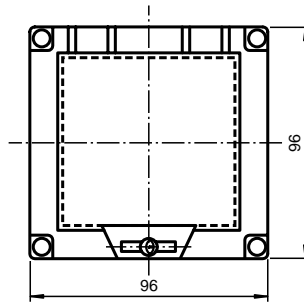

Dimensions relevant to use of the lockable front frame.

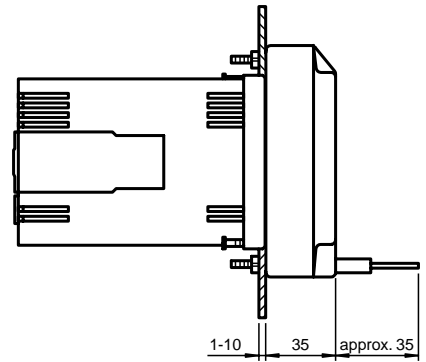

FPL-01, Installation cut-out

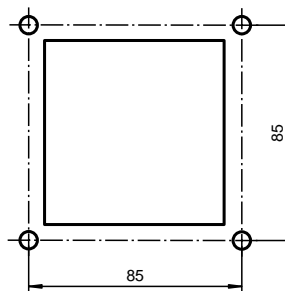

Ø4.5 mm for M4 screws

Rear view of counter

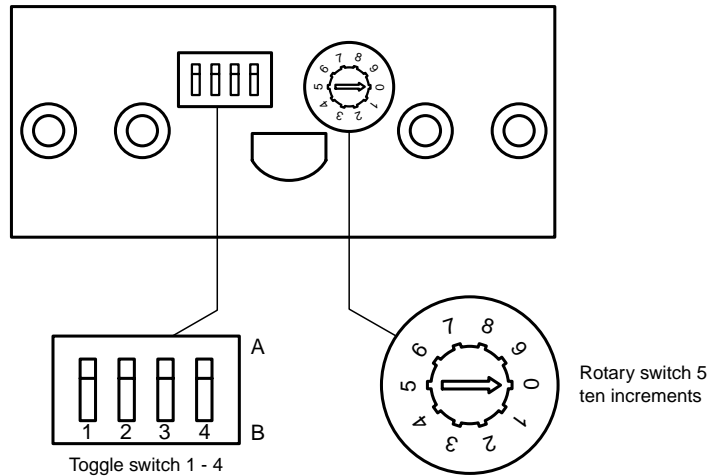

Table of toggle switch functions

Switch No.	Function		Mode of operation
1	Maximum counting frequency	A	Counting frequency 10 Hz
		B	Counting frequency 20 kHz
2	Input operating mode	A	Separate signals for addition/subtraction
		B	2 signals, displaced in phase by 90°
3	Count level after reset	A	On reset, the counter jumps to the set preselection 2.
		B	On reset, the counter jumps to 0
4	Positive or negative logic	A	Negative input logic, NPN output stages
		B	Positive input logic, PNP output stages

Switch setting 0

Toggle switch 3 in Pos. B
Addition

Toggle switch 3 in Pos. B
Subtraction

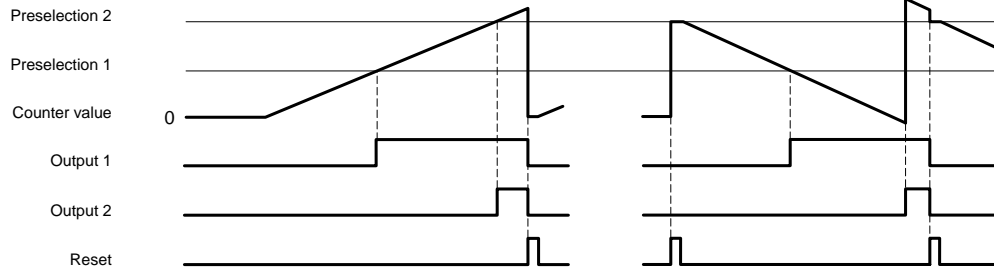

Switch setting 1

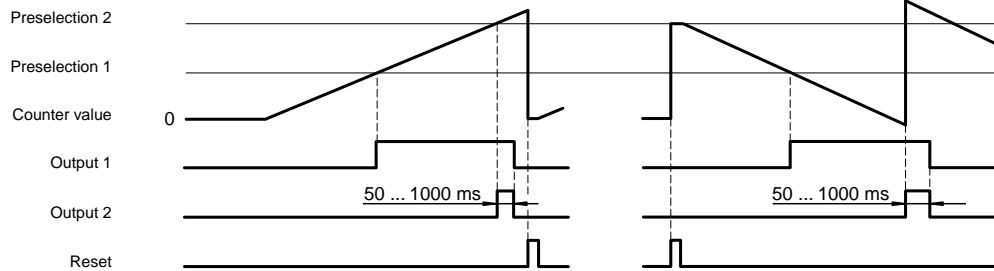

Switch setting 2

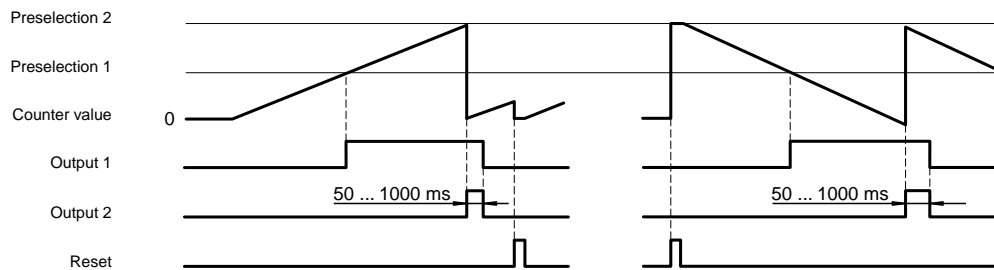

Switch setting 3

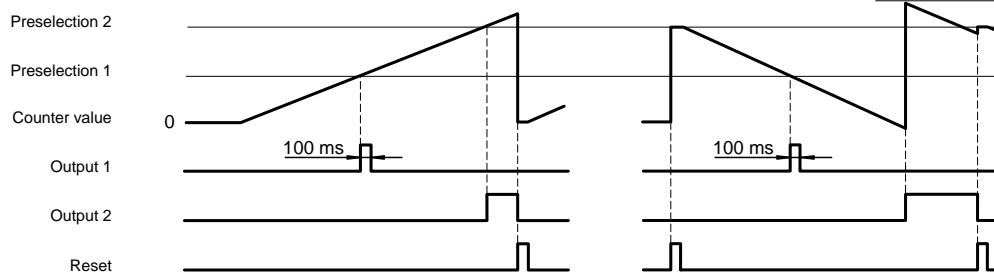

Switch setting 4

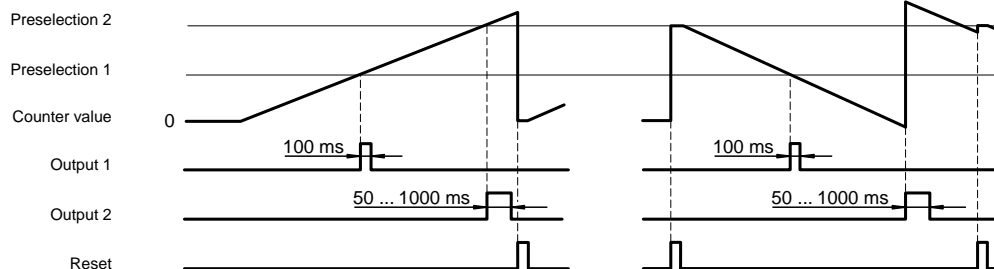

Switch setting 5

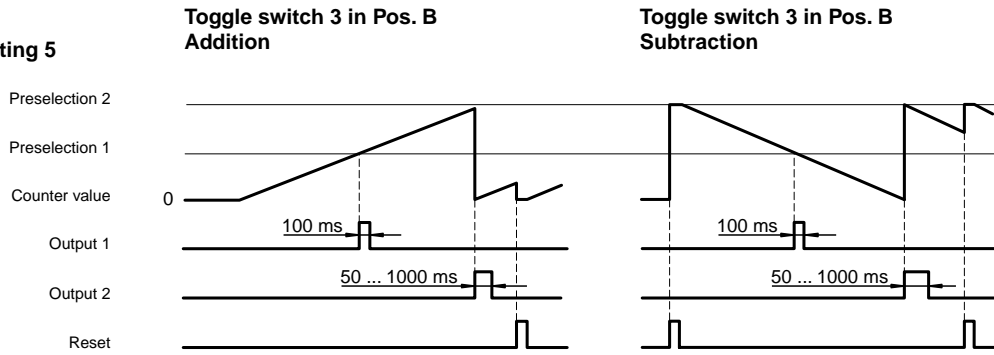

Switch setting 6

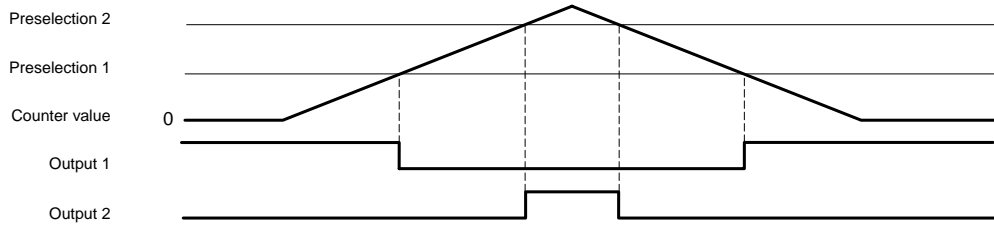

Switch setting 7

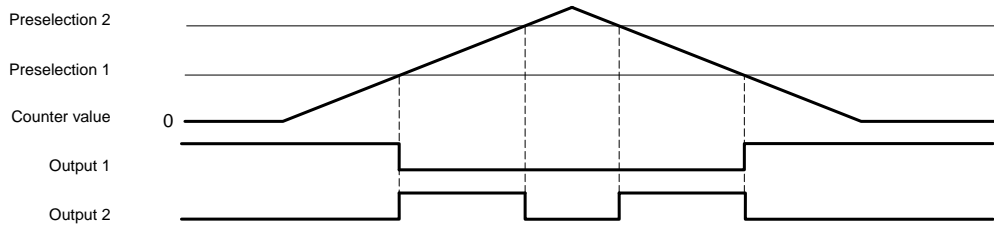

Switch setting 8

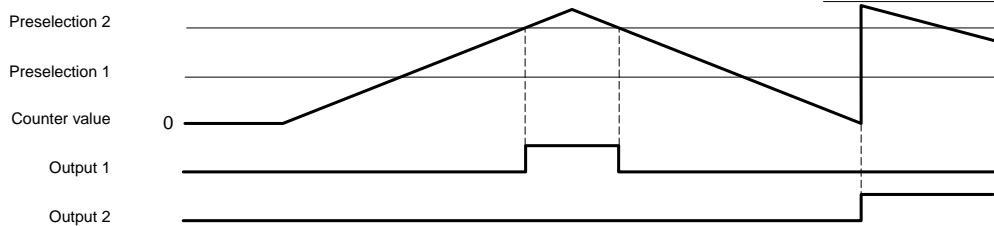

Switch setting 9

