

## SLIN

- For SVE 10, SVM 10 and SHE 88
- Inputs for LATCH, TRISTATE and PRESET
- Counting direction selection
- Watchdog-output
- Output data in Gray, Gray Excess, Binary or BCD Code
- Resolution per DIP-switch optional



### Electrical characteristics:

|                                     |       |  |
|-------------------------------------|-------|--|
| Resolution                          | [bit] | 25   |
| Operating voltage $U_B$             | [V]   | 18 ... 32  |
| Maximum current consumption         | [mA]  | 120  |
| Maximum power dissipation (no load) | [W]   | 4.5  |
| <b>Serial interface:</b>            |       |  |
| Interface                           |       | RS 485   |
| Telegram                            |       | SLIN-protocol  |
| Baud rate                           | [kBd] | 115  |
| Watchdog-output                     |       | "1": communication between encoder and Module 25 bit is error free. Output data is valid.<br>"0": output data is invalid       |
| Encoder supply                      |       | 18 V ... 32 V, $I_{max} = 150$ mA  |
| + 5 V (Iso)                         |       | + 5 V potential free, $I_{max} = 5$ mA<br>for connection of terminating resistors  |
| GND (Iso)                           |       | Reference potential for + 5 V (Iso)<br>for connection of terminating resistors   |
| <b>Parallel interface:</b>          |       |  |
| Push-pull outputs $I_{max}$         | [mA]  | 40, short circuit protected  |
| Voltage drop $U_d$                  | [V]   | 2  |
| Output code                         |       | Gray, Gray-Excess, Binary, BCD (8421)<br>Programmable via DIP switches   |
| <b>Inputs:</b>                      |       |  |
| LATCH                               |       | < 2 V: "0", > 11 V: "1", $U_{max} = 30$ V, $I < 6$ mA<br>"0" or unswitched: do not save data outputs<br>"1": save data outputs |
| TRISTATE                            |       | "0" or unswitched: outputs active<br>"1": high Ohm outputs<br>Operating direction can be inverted via jumper                   |
| PRESET                              |       | "0" or unswitched: inactive<br>"1": the output word is set to zero   |

### SLIN Telegram:

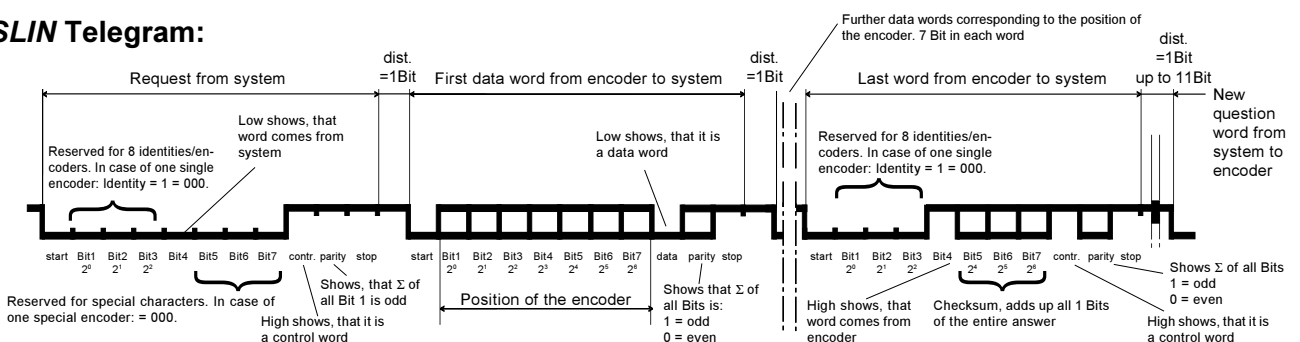

Date of issue 01.08.1998

## Serial interface connections:

| Signal                   | Sub-D Socket Pin-Nr. | Definition  |
|--------------------------|----------------------|---|
| GND (Encoder)            | 1                    | Encoder voltage supply  |
| U <sub>B</sub> (Encoder) | 2                    | Encoder voltage supply  |
| RXT-TXT-P                | 3                    | Positive serial transmitted/received data                                   |
| RXT-TXT-N                | 4                    | Negative serial transmitted/received data                                   |
| N.C.                     | 5                    | Not connected   |
| N.C.                     | 6                    | Not connected   |
| N.C.                     | 7                    | Not connected   |
| GND (Iso)                | 8                    | Reference potential for + 5 V (Iso) for connection of terminating resistors |
| + 5 V (Iso)              | 9                    | + 5 V DC potential free for connection of terminating resistors             |

## Serial interface connections:

| Signal                  | Terminal | Definition                                  |
|-------------------------|----------|---|
| Watchdog                | W        | Output: Watchdog                            |
| N.C.                    | NC       | Not connected                               |
| TRISTATE                | T        | Input: multiplexer operation                |
| PRESET                  | P        | Input: zero setting                         |
| LATCH                   | L        | Input: data storage                         |
| N.C.                    | NC       | Not connected                               |
| N.C.                    | NC       | Not connected                               |
| U <sub>B</sub> (Module) | 24 V     | Voltage supply                              |
| GND (Module)            | 0 V      | Voltage supply                              |
| GND (DP)                | DP       | Data reference potential for output drivers |

## Mechanical dimensions:

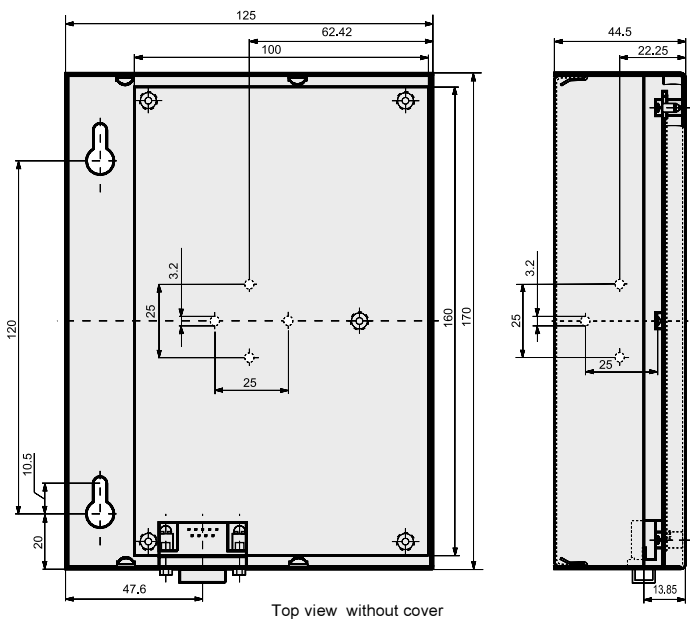

## Connection design:

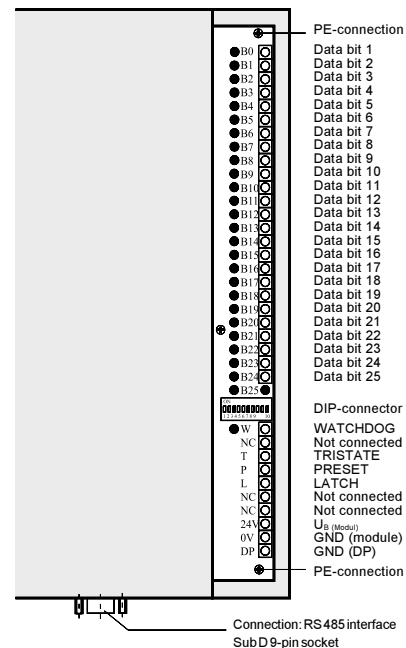

## Mechanical characteristics:

|            |  |
|------------|--|
| Housing    | Stainless steel  |
| Weight [g] | ca. 600  |
| Connection | self opening terminal connectors (max. wire size 1.5 mm <sup>2</sup> )<br>9 pin Sub-D socket |

## Environmental conditions:

|   |                             |
|---|-----------------------------|
| Storage temperature [°C]                | -25 ... 85                  |
| Operating temperature [°C]              | 0 ... 70                    |
| Interference output according to        | EN 50081-2, 1993            |
| Interference resistance according to    | EN 50082-2, 1995            |
| Protection class according to DIN 40050 | IP 20                       |
| Accessories                             | Flange adapter for DIN rail |