



**Model Number**

NMB10-18GM55-E2

**Features**

- 10 mm flush
- Stainless steel sensing face
- Increased operating distance

**Connection**

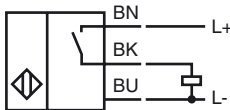

**Dimensions**

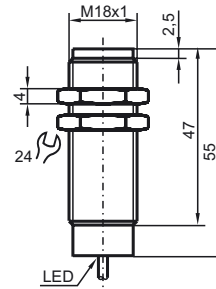

**Technical Data**

**General specifications**

Switching element function	PNP	NO
Rated operating distance	$s_n$	10 mm
Installation	flush (Requirements: see drawing below)	
Output polarity	DC	
Assured operating distance	$s_a$	0 ... 8.1 mm
Actuating element	Ferrous and nonferrous targets	
Reduction factor $r_{Al}$	0.4	
Reduction factor $r_{Cu}$	0.25	
Reduction factor $r_{304}$	0.85	
Reduction factor $r_{St37}$	1	

**Nominal ratings**

Operating voltage	$U_B$	10 ... 30 V DC
Switching frequency	$f$	0 ... 240 Hz
Hysteresis	$H$	3 ... 15 typ. 10 %
Reverse polarity protected	reverse polarity protected	
Short-circuit protection	pulsing	
Voltage drop	$U_d$	$\leq 2$ V
Operating current	$I_L$	$\leq 200$ mA
Off-state current	$I_r$	10 $\mu$ A
No-load supply current	$I_0$	$\leq 10$ mA
Operating voltage display	LED, green	
Indication of the switching state	LED, yellow	

**Functional safety related parameters**

MTTF <sub>d</sub>	880 a
Mission Time ( $T_M$ )	20 a
Diagnostic Coverage (DC)	0 %

**Ambient conditions**

Ambient temperature	-25 ... 70 °C (-13 ... 158 °F)
---------------------	--------------------------------

**Mechanical specifications**

Connection type	cable PUR , 2 m
Core cross-section	0.5 mm <sup>2</sup>
Housing material	Stainless steel 1.4305 / AISI 303
Sensing face	Stainless steel 1.4305 / AISI 303
Protection degree	IP69K

**Compliance with standards and directives**

Standard conformity	
Standards	EN 60947-5-2:2007 IEC 60947-5-2:2007

**Approvals and certificates**

UL approval	cULus Listed, General Purpose
CSA approval	cCSAus Listed, General Purpose
CCC approval	Products with a maximum operating voltage of $\leq 36$ V do not bear a CCC marking because they do not require approval.

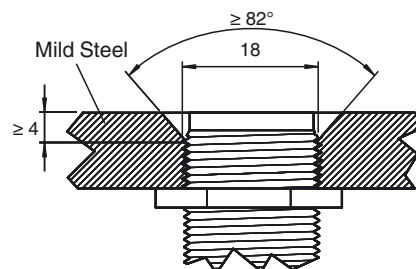

Sensor face is flush with mounting surface.

Release date: 2012-06-27 13:22 Date of issue: 2012-06-27 911281\_eng.xml