



Model Number

NBB10-30GM50-WS-V93

Features

- Basic series
- 10 mm embeddable
- 2-wire AC

Connection

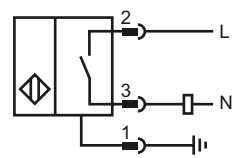

Pinout

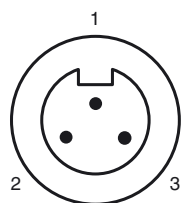

Wire colors

| | |
|---|----|
| 1 | GN |
| 2 | BK |
| 3 | WH |

Accessories

- BF 30**
Mounting flange, 30 mm
- EXG-30**
Quick mounting bracket with dead stop

Dimensions

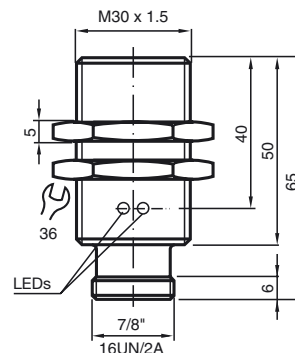

Technical Data

| General specifications | | |
|------------------------------------------|----------------|----------------------------------------------------------------------------------------------------------------------------------------------------------------------------------------------------------------------------------------------------------------|
| Switching element function | AC | NO |
| Rated operating distance | s _n | 10 mm |
| Installation | | embeddable |
| Output polarity | | AC |
| Assured operating distance | s _a | 0 ... 8.1 mm |
| Reduction factor r _{Al} | | 0.33 |
| Reduction factor r _{Cu} | | 0.28 |
| Reduction factor r _{V2A} | | 0.81 |
| Nominal ratings | | |
| Operating voltage | U _B | 20 ... 253 V |
| Switching frequency | f | 0 ... 20 Hz |
| Hysteresis | H | typ. 5 % |
| Reverse polarity protected | | tolerant |
| Voltage drop | U _d | < 5 V (I _L > 50 mA); < 8 V (I _L < 50 mA) |
| Momentary current (20 ms, 0.1 Hz) | | 0 ... 1600 mA |
| Operating current | I _L | 5 ... 200 mA |
| Off-state current | I _r | 0 ... 1.7 mA |
| Operating voltage display | | LED, green |
| Indication of the switching state | | LED, yellow |
| Ambient conditions | | |
| Ambient temperature | | -25 ... 70 °C (-13 ... 158 °F) |
| Mechanical specifications | | |
| Connection type | | Device connector 7/8"-16 UN , 3-pin |
| Housing material | | brass, nickel-plated |
| Sensing face | | PBT |
| Protection degree | | IP67 |
| Note | | 1) In the temperature range below 0 °C, permissible operating voltage U _B 80...253 V Safety fuse ≤ 0.3 A (quick-blow) according to IEC 60127-2 Sheet 1 Recommendation: after a short circuit, check that the device is functioning correctly. |
| Compliance with standards and directives | | |
| Standard conformity | | |
| Standards | | EN 60947-5-2:2007 IEC 60947-5-2:2007 |
| Approvals and certificates | | |
| UL approval | | cULus Listed, General Purpose |
| CSA approval | | cCSAus Listed, General Purpose |
| CCC approval | | Certified by China Compulsory Certification (CCC) |

Release date: 2010-12-07 09:58 Date of issue: 2010-12-07 801697_ENG.xml