



Model Number

RL23-8-H-1000-IR-AS-i/116

Background suppression sensor
with terminal compartment

Features

- Adjustable background suppression
- AS-Interface
- Infrared light
- Sturdy plastic housing
- Optical surface made of scratch-resistant glass

Dimensions

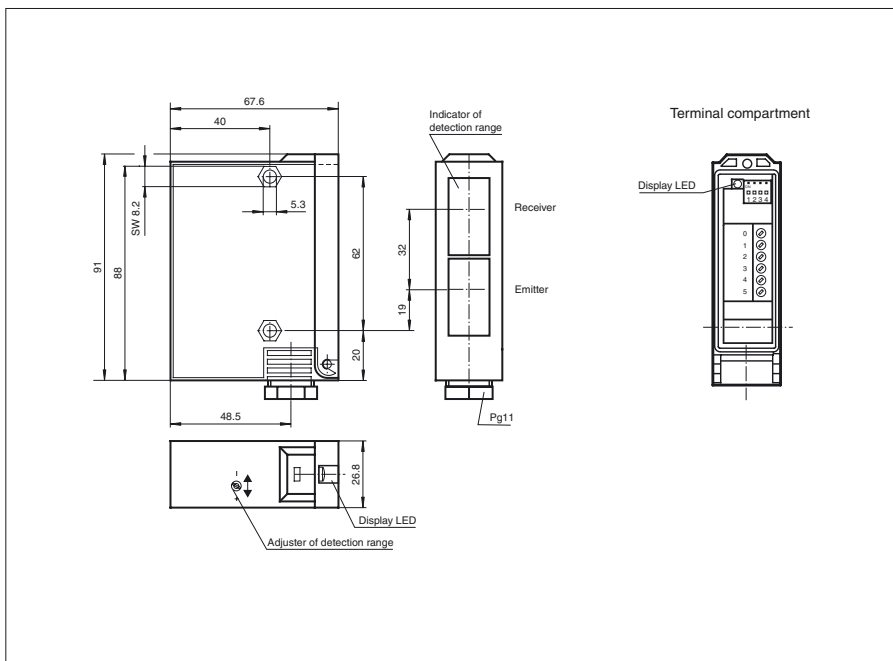

Electrical connection

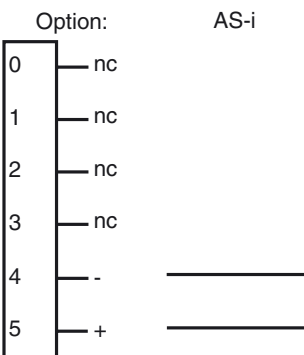

Release date: 2011-01-06 13:58 Date of issue: 2011-01-06 419462_ENG.xml

Subject to modifications without notice

Pepperl+Fuchs Group
www.pepperl-fuchs.com

USA: +1 330 486 0001
fa-info@us.pepperl-fuchs.com

Germany: +49 621 776-4411
fa-info@pepperl-fuchs.com

Copyright Pepperl+Fuchs

Singapore: +65 6779 9091
fa-info@sg.pepperl-fuchs.com

Technical data**General specifications**

| | |
|---------------------------------|-------------------------------|
| Detection range | 50 ... 1000 mm |
| Detection range min. | 50 ... 150 mm |
| Detection range max. | 50 ... 1000 mm |
| Light source | IREd |
| Light type | modulated infrared light |
| Black/White difference (6%/90%) | < 10 % |
| Diameter of the light spot | 25 mm at 1000 mm sensor range |
| Angle of divergence | 1.5 ° |
| Ambient light limit | 12000 Lux |

Indicators/operating means

| | |
|------------------|---|
| Function display | LED yellow, lights up with receiver lit |
| Controls | parameter bit P1 light/dark switching |
| Controls | Detection range adjuster |

Electrical specifications

| | | |
|------------------------|-------|----------------------|
| Operating voltage | U_B | via AS-Interface bus |
| No-load supply current | I_0 | 40 mA |

Input

| | |
|------------|----------------------------------|
| Test input | emitter deactivation data bit D3 |
|------------|----------------------------------|

Output

| | |
|---------------------|-----------------------------|
| Switching type | light/dark on |
| Signal output | data bit D0 sensor function |
| Switching frequency | f 70 Hz |
| Response time | 5 ms |

Ambient conditions

| | |
|---------------------|-------------------------------|
| Ambient temperature | -20 ... 60 °C (-4 ... 140 °F) |
| Storage temperature | -20 ... 75 °C (-4 ... 167 °F) |

Mechanical specifications

| | |
|-------------------|----------------------|
| Protection degree | IP65 |
| Connection | terminal compartment |
| Material | |
| Housing | Terluran GV15 |
| Optical face | glass |
| Mass | 180 g |

Compliance with standards and directives

| | |
|---------------------|---|
| Standard conformity | |
| Product standard | EN 60947-5-2:2007 IEC 60947-5-2:2007 |

Approvals and certificates

| | |
|-------------|-------|
| UL approval | cULus |
|-------------|-------|

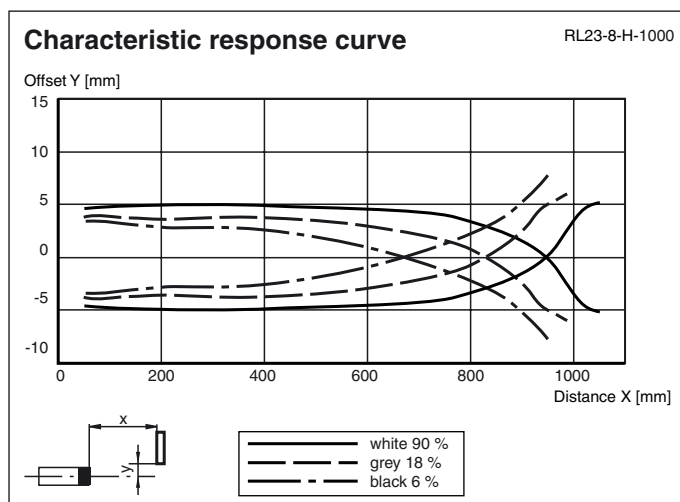
Curves/Diagrams**Accessories****OMH-05**

Mounting aid for round steel \varnothing 12 mm or sheet 1.5 mm ... 3 mm

OMH-07

Mounting aid for round steel \varnothing 12 mm or sheet 1.5 mm ... 3 mm

OMH-21

Mounting bracket

OMH-22

Mounting bracket

OMH-RLK29-HW

Mounting bracket for rear wall mounting

Other suitable accessories can be found at www.pepperl-fuchs.com

