



Model Number

NEB3-F41-E0-V3

Features

- 3-wire DC
- Metal housing
- 3 mm virtually flush

Connection

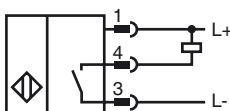

Pinout



Wire colors in accordance with EN 60947-5-2

1	BN	(brown)
3	BU	(blue)
4	BK	(black)

Accessories

- V3-GM**
Female connector, M8, 3-pin, field attachable
- V3-WM**
Female connector, M8, 3-pin, field attachable
- V3-GM-2M-PUR**
Cable socket, M8, 3-pin, PUR cable
- V3-WM-2M-PUR**
Cable socket, M8, 3-pin, PUR cable

Dimensions

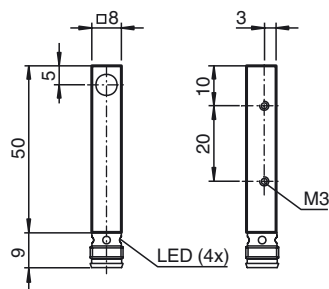

Technical Data

General specifications			
Switching element function		NPN	NO
Rated operating distance	s_n	3 mm	
Installation		virtually flush	
Output polarity		DC	
Assured operating distance	s_a	0 ... 2.4 mm	
Actuating element		mild steel, e. g. 1.0037, SR235JR (formerly St37-2) 9 mm x 9 mm x 1 mm	
Reduction factor r_{Al}		0.35	
Reduction factor r_{Cu}		0.3	
Reduction factor r_{304}		0.7	
Reduction factor r_{Brass}		0.45	
Nominal ratings			
Operating voltage	U_B	10 ... 30 V DC	
Switching frequency	f	0 ... 1000 Hz	
Hysteresis	H	0.03 ... 0.3	
Reverse polarity protection		reverse polarity protected	
Short-circuit protection		pulsing	
Overload resistance		yes	
Wire breakage protection		yes	
Inductive overvoltage protection		yes	
Surge suppression		yes	
Ripple		$\leq 10 \%$	
Voltage drop	U_d	≤ 2 V	
Repeat accuracy		0.15 mm	
Operating current	I_L	0 ... 200 mA, above 50°C ≤ 150 mA	
Off-state current	I_r	$\leq 10 \mu A$	
No-load supply current	I_0	≤ 15 mA	
Time delay before availability	t_v	≤ 50 ms	
Indication of the switching state		LED, yellow	
Ambient conditions			
Ambient temperature		-25 ... 85 °C (-13 ... 185 °F)	
Storage temperature		-40 ... 85 °C (-40 ... 185 °F)	
Mechanical specifications			
Connection type		Device connector M8 x 1, 3-pin	
Housing material		brass, nickel-plated	
Sensing face		PBT	
Protection degree		IP67	
Mass		20 g	
Compliance with standards and directives			
Standard conformity			
Standards		EN 60947-5-2:2007 IEC 60947-5-2:2007	
Approvals and certificates			
UL approval		cULus Listed, General Purpose, Class 2 Power Source	
CSA approval		cCSAus Listed, General Purpose	
CCC approval		Products with a maximum operating voltage of ≤ 36 V do not bear a CCC marking because they do not require approval.	

Release date: 2012-10-18 10:04 Date of issue: 2012-10-18 242308_eng.xml