



Model Number

NEB3-F41-E1-V3

Features

- 3-wire DC
- Metal housing
- 3 mm virtually flush

Connection

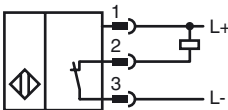

Pinout



Wire colors in accordance with EN 60947-5-2

1	BN	(brown)
3	BU	(blue)
4	BK	(black)

Accessories

- V3-GM**
Female connector, M8, 3-pin, field attachable
- V3-WM**
Female connector, M8, 3-pin, field attachable
- V3-GM-2M-PUR**
Cable socket, M8, 3-pin, PUR cable
- V3-WM-2M-PUR**
Cable socket, M8, 3-pin, PUR cable

Dimensions

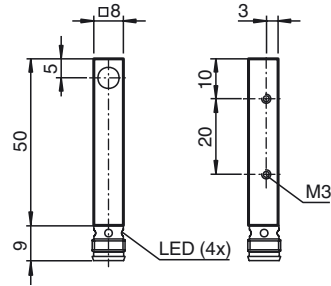

Technical Data

General specifications

Switching element function	NPN	NC
Rated operating distance	s_n	3 mm
Installation		virtually flush
Output polarity		DC
Assured operating distance	s_a	0 ... 2.4 mm
Actuating element		mild steel, e. g. 1.0037, SR235JR (formerly St37-2) 9 mm x 9 mm x 1 mm
Reduction factor r_{Al}		0.35
Reduction factor r_{Cu}		0.3
Reduction factor r_{304}		0.7
Reduction factor r_{Brass}		0.45

Nominal ratings

Operating voltage	U_B	10 ... 30 V DC
Switching frequency	f	0 ... 1000 Hz
Hysteresis	H	0.03 ... 0.3
Reverse polarity protection		reverse polarity protected
Short-circuit protection		pulsing
Overload resistance		yes
Wire breakage protection		yes
Inductive overvoltage protection		yes
Surge suppression		yes
Ripple		$\leq 10\%$
Voltage drop	U_d	$\leq 2\text{ V}$
Repeat accuracy		0.15 mm
Operating current	I_L	0 ... 200 mA, above 50°C $\leq 150\text{ mA}$
Off-state current	I_r	$\leq 10\ \mu\text{A}$
No-load supply current	I_0	$\leq 15\text{ mA}$
Time delay before availability	t_v	$\leq 50\text{ ms}$
Indication of the switching state		LED, yellow

Ambient conditions

Ambient temperature	-25 ... 85 °C (-13 ... 185 °F)
Storage temperature	-40 ... 85 °C (-40 ... 185 °F)

Mechanical specifications

Connection type	Device connector M8 x 1, 3-pin
Housing material	brass, nickel-plated
Sensing face	PBT
Protection degree	IP67
Mass	20 g

Compliance with standards and directives

Standard conformity	
Standards	EN 60947-5-2:2007 IEC 60947-5-2:2007

Approvals and certificates

UL approval	cULus Listed, General Purpose, Class 2 Power Source
CSA approval	cCSAus Listed, General Purpose
CCC approval	Products with a maximum operating voltage of $\leq 36\text{ V}$ do not bear a CCC marking because they do not require approval.

Release date: 2012-10-18 10:04 Date of issue: 2012-10-18 242307_eng.xml