



### Model Number

NJ3-18GK-S1N-130

### Features

- 3 mm flush in ST37 / 1.0037
- Usable up to SIL 3 acc. to IEC 61508

### Connection

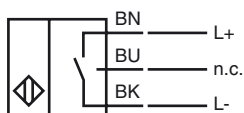

### Accessories

#### BF 18

Mounting flange, 18 mm

### Application



#### Danger!

In safety-related applications the sensor must be operated with a qualified fail safe interface from

Pepperl+Fuchs, such as KFD2-SH-EX1.

Consider the "exida Functional Safety Assessment" document which is available on [www.pepperl-fuchs.com](http://www.pepperl-fuchs.com) as an integral part of this product's documentation.

### Dimensions

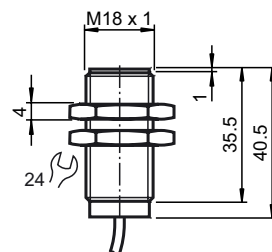

### Technical Data

#### General specifications

Switching element function		DC	NO
Rated operating distance	$s_n$	3 mm	
Installation		flush in mild steel	
Output polarity		Safety Function	
Assured operating distance	$s_a$	0 ... 2.4 mm	
Reduction factor $r_{Al}$		1	
Reduction factor $r_{Cu}$		1	
Reduction factor $r_{304}$		0	

#### Nominal ratings

Nominal voltage	$U_o$	8 V DC
Switching frequency	$f$	0 ... 200 Hz
Hysteresis	$H$	typ. 0.1 %

#### Current consumption

Measuring plate not detected	$\leq 1$ mA
Measuring plate detected	$\geq 3$ mA

#### Ambient conditions

Ambient temperature	-25 ... 130 °C (-13 ... 266 °F)
---------------------	---------------------------------

#### Mechanical specifications

Connection type	cable silicon, 2 mm
Core cross-section	0.75 mm <sup>2</sup>
Housing material	PPS, PTFE
Sensing face	PPS
Protection degree	IP65
Note	only for non-ferrous metal

#### Compliance with standards and directives

Standard conformity	
Standards	EN 60947-5-2:2007 IEC 60947-5-2:2007

#### Approvals and certificates

UL approval	cULus Listed, General Purpose
CSA approval	cCSAus Listed, General Purpose
CCC approval	Products with a maximum operating voltage of $\leq 36$ V do not bear a CCC marking because they do not require approval.