



CE

**Model Number**

NEN40-30GM60-E0

**Features**

- 40 mm not embeddable
- Increased operating distance

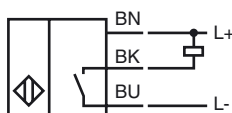
**Connection****Accessories****BF 30**

Mounting flange, 30 mm

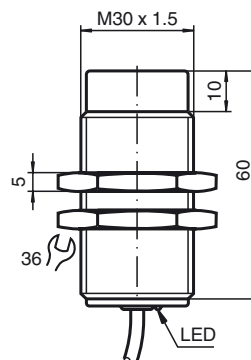
**Dimensions****Technical Data****General specifications**

Switching element function	NPN	NO
Rated operating distance	$s_n$	40 mm
Installation		not embeddable
Output polarity		DC
Assured operating distance	$s_a$	0 ... 32.4 mm
Reduction factor $r_{AI}$		0.42
Reduction factor $r_{Cu}$		0.37
Reduction factor $r_{303}$		0.78

**Nominal ratings**

<b>Installation conditions</b>	
A	in aluminium: 25 mm in steel 1.0037 (St37): 35 mm in brass 25 mm in stainless steel 20 mm
B	55 mm
C	120 mm
F	150 mm
Operating voltage	$U_B$ 10 ... 30 V
Switching frequency	$f$ 0 ... 100 Hz
Hysteresis	$H$ $\leq 10\%$
Reverse polarity protected	reverse polarity protected
Short-circuit protection	pulsing
Voltage drop	$U_d$ $\leq 2$ V
Operating current	$I_L$ 0 ... 200 mA
Off-state current	$I_r$ 0 ... 0.1 mA typ. 0.1 $\mu$ A at 25 °C
No-load supply current	$I_0$ $\leq 10$ mA
Indication of the switching state	LED, yellow

**Functional safety related parameters**

MTTF <sub>d</sub>	211 a
Mission Time (T <sub>M</sub> )	20 a
Diagnostic Coverage (DC)	0 %

**Ambient conditions**

Ambient temperature	-25 ... 70 °C (-13 ... 158 °F)
---------------------	--------------------------------

**Mechanical specifications**

Connection type	cable PVC, 2 m
Core cross-section	0.34 mm <sup>2</sup>
Housing material	chromium plated brass
Sensing face	PBT
Protection degree	IP67

**Compliance with standards and directives**

<b>Standard conformity</b>	
Standards	EN 60947-5-2:2007 IEC 60947-5-2:2007

**Approvals and certificates**

CCC approval	Products with a maximum operating voltage of $\leq 36$ V do not bear a CCC marking because they do not require approval.
--------------	--

**Installation conditions**