



### Model Number

NMB5-12GH50-E2-FB

### Features

- Stainless steel sensing face
- Sensing range 5 mm
- 3-wire DC
- Increased operating distance

### Connection

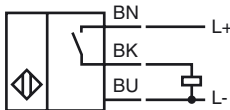

### Dimensions

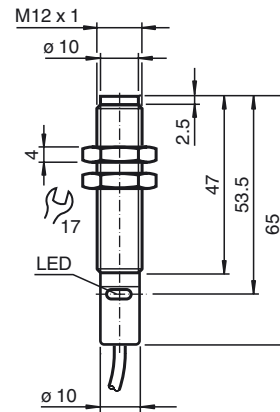

### Technical Data

#### General specifications

Switching element function		PNP, NO
Rated operating distance	$s_n$	5 mm
Installation		flush
Output polarity		DC
Assured operating distance	$s_a$	0 ... 4.05 mm
Reduction factor $r_{AI}$		0.3
Reduction factor $r_{Cu}$		0.2
Reduction factor $r_{304}$		0.85
Reduction factor $r_{S137}$		1

#### Nominal ratings

Operating voltage	$U_B$	10 ... 30 V
Switching frequency	$f$	360 Hz
Hysteresis	$H$	3 ... 15 typ. 10 %
Reverse polarity protected		yes
Short-circuit protection		yes
Voltage drop	$U_d$	$\leq 2$ V
Operating current	$I_L$	0 ... 150 mA
Off-state current	$I_r$	$\leq 10$ $\mu$ A
No-load supply current	$I_0$	$\leq 10$ mA
Indication of the switching state		LED, yellow

#### Functional safety related parameters

MTTF <sub>d</sub>	645 a
Mission Time ( $T_M$ )	20 a
Diagnostic Coverage (DC)	0 %

#### Ambient conditions

Ambient temperature	-25 ... 85 °C (-13 ... 185 °F)
---------------------	--------------------------------

#### Mechanical specifications

Connection type	cable PVC , 2 m
Core cross-section	3 x 0.34 mm <sup>2</sup>
Housing material	Stainless steel 1.4404 / AISI 316L
Sensing face	Stainless steel 1.4404 / AISI 316L
Protection degree	IP67 / IP68 / IP69k

#### General information

Supplementary information	$I_L$ max. 200 mA @ $T \leq 50$ °C/122 °F
Assembly dimensions	x: 12 mm y: $\geq 2$ mm

#### Compliance with standards and directives

Standard conformity	
Standards	EN 60947-5-2:2007 IEC 60947-5-2:2007

#### Approvals and certificates

CCC approval	Products with a maximum operating voltage of $\leq 36$ V do not bear a CCC marking because they do not require approval.
--------------	--

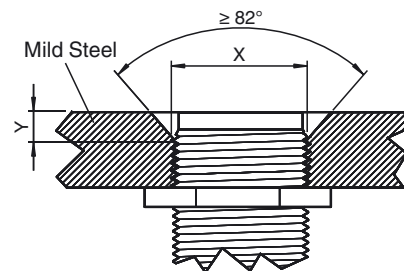

Sensor face is flush with mounting surface.