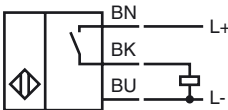

**Model Number**

NBB2-6,5M16-E2-Y217845

**Features**

- Basic series
- 2 mm embeddable
- Increased operating distance

**Connection****Accessories****BF 6,5**

Mounting flange, 6.5 mm

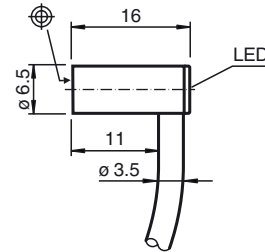
**Dimensions****Technical Data****General specifications**

Switching element function		PNP	NO
Rated operating distance	$s_n$	2 mm	
Installation		embeddable	
Output polarity		DC	
Assured operating distance	$s_a$	0 ... 1.62 mm	
Reduction factor $r_{Al}$		0.3	
Reduction factor $r_{Cu}$		0.25	
Reduction factor $r_{304}$		0.7	
Reduction factor $r_{Si37}$		1	
Reduction factor $r_{Brass}$		0.4	

**Nominal ratings**

Operating voltage	$U_B$	10 ... 30 V
Switching frequency	$f$	0 ... 5000 Hz
Hysteresis	$H$	≤ 10 %
Reverse polarity protected		reverse polarity protected
Short-circuit protection		pulsing
Voltage drop	$U_d$	≤ 2 V
Operating current	$I_L$	0 ... 200 mA
Off-state current	$I_r$	≤ 0.1 mA
No-load supply current	$I_0$	≤ 10 mA
Indication of the switching state		LED

**Ambient conditions**

Ambient temperature	-25 ... 70 °C (-13 ... 158 °F)
---------------------	--------------------------------

**Mechanical specifications**

Connection type	cable PVC , 2 m
Core cross-section	0.14 mm <sup>2</sup>
Housing material	Stainless steel 1.4305 / AISI 303
Sensing face	PA 12
Protection degree	IP67

**Compliance with standards and directives**

Standard conformity	
Standards	EN 60947-5-2:2007 IEC 60947-5-2:2007

**Approvals and certificates**

UL approval	cULus Listed, General Purpose
CSA approval	cCSAus Listed, General Purpose