



Model Number

NBB2-F76-E1-0,5M

Features

- 2 mm embeddable
- 3-wire DC

Connection

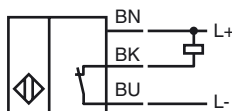

Dimensions

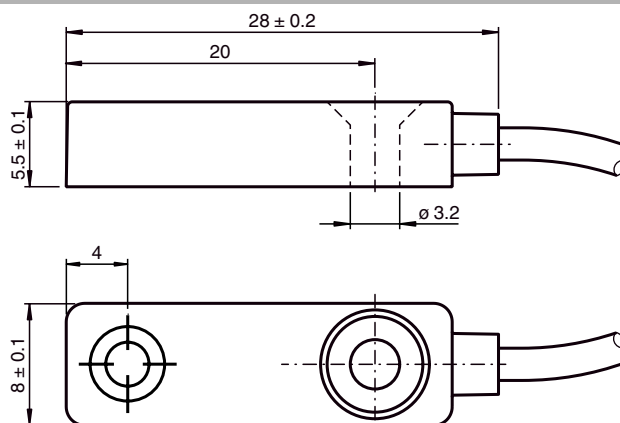

Technical Data

General specifications

| | | |
|------------------------------|-------|---------------------|
| Switching element function | | NPN normally closed |
| Rated operating distance | s_n | 2 mm |
| Installation | | embeddable |
| Output polarity | | DC |
| Assured operating distance | s_a | 0 ... 1.62 mm |
| Reduction factor r_{AI} | | 0.25 |
| Reduction factor r_{Cu} | | 0.2 |
| Reduction factor r_{304} | | 0.63 |
| Reduction factor r_{Brass} | | 0.31 |

Nominal ratings

| | | |
|-----------------------------------|-------|----------------------------------|
| Operating voltage | U_B | 10 ... 30 V DC |
| Switching frequency | f | 0 ... 1500 Hz |
| Hysteresis | H | typ. 5 % |
| Reverse polarity protected | | reverse polarity protected |
| Short-circuit protection | | pulsing |
| Voltage drop | U_d | ≤ 3 V |
| Operating current | I_L | 0 ... 100 mA |
| Off-state current | I_r | 0 ... 0.5 mA typ. 10 µA at 25 °C |
| No-load supply current | I_0 | ≤ 15 mA |
| Indication of the switching state | | LED yellow |

Functional safety related parameters

| | |
|--------------------------------|-------|
| MTTF _d | 828 a |
| Mission Time (T _M) | 20 a |
| Diagnostic Coverage (DC) | 0 % |

Ambient conditions

| | |
|---------------------|--------------------------------|
| Ambient temperature | -25 ... 70 °C (-13 ... 158 °F) |
|---------------------|--------------------------------|

Mechanical specifications

| | |
|--------------------|--------------------------|
| Connection type | cable PVC , 0.5 m |
| Core cross-section | 3 x 0.09 mm ² |
| Housing material | PC |
| Protection degree | IP67 |
| Mass | 5 g |

Compliance with standards and directives

| | |
|---------------------|---|
| Standard conformity | |
| Standards | EN 60947-5-2:2007 IEC 60947-5-2:2007 |

Approvals and certificates

| | |
|--------------|--|
| CCC approval | Products with a maximum operating voltage of ≤36 V do not bear a CCC marking because they do not require approval. |
|--------------|--|