



CE

### Model Number

CBB5-18GK70-E2-Y209486

### Features

- Comfort series
- 5 mm embeddable

### Connection

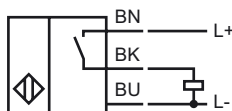

### Accessories

**BF 18**  
Mounting flange

**EXG-18**  
Mounting aid

### Dimensions

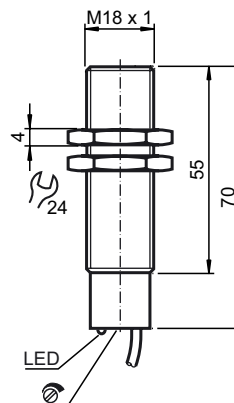

### Technical Data

#### General specifications

|                            |       |               |
|----------------------------|-------|---------------|
| Switching element function | PNP   | Make function |
| Rated operating distance   | $s_n$ | 5 mm          |
| Installation               |       | embeddable    |
| Output polarity            |       | DC            |
| Assured operating distance | $s_a$ | 0 ... 4.05 mm |

#### Nominal ratings

|                                   |       |                                    |
|-----------------------------------|-------|------------------------------------|
| Operating voltage                 | $U_B$ | 10 ... 35 V                        |
| Switching frequency               | $f$   | 0 ... 300 Hz                       |
| Reverse polarity protection       |       | protected against reverse polarity |
| Short-circuit protection          |       | pulsing                            |
| Voltage drop                      | $U_d$ | $\leq 2$ V                         |
| Operating current                 | $I_L$ | 0 ... 200 mA                       |
| No-load supply current            | $I_0$ | typ. 15 mA                         |
| Indication of the switching state |       | LED                                |

#### Ambient conditions

|                     |                               |
|---------------------|-------------------------------|
| Ambient temperature | -25 ... 70 °C (248 ... 343 K) |
| Storage temperature | -40 ... 85 °C (233 ... 358 K) |

#### Mechanical specifications

|                    |                      |
|--------------------|----------------------|
| Connection type    | 2 m, PUR cable       |
| Core cross-section | 0.34 mm <sup>2</sup> |
| Housing material   | PPO                  |
| Sensing face       | PPO/PA               |
| Protection degree  | IP67                 |

#### Compliance with standards and directives

|                     |   |
|---------------------|---|
| Standard conformity |   |
| Standards           | EN 60947-5-2:2007<br>IEC 60947-5-2:2007 |