



### Model Number

NMN20-18GM50-E2-F

### Features

- 20 mm not embeddable
- Active surface metal
- One-piece housing with stainless steel (V4A; 1.4435)

### Connection

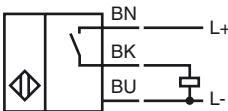

### Accessories

#### BF 18

Mounting flange, 18 mm

### Dimensions

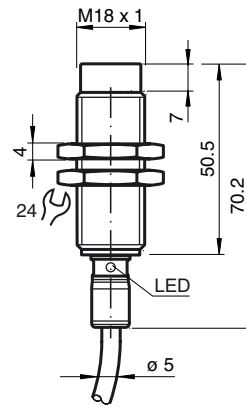

### Technical Data

#### General specifications

Switching element function	PNP	NO
Rated operating distance	$s_n$	20 mm
Installation	not embeddable	
Output polarity	DC	
Assured operating distance	$s_a$	0 ... 16.2 mm
Reduction factor $r_{Al}$	1	
Reduction factor $r_{Cu}$	0.9	
Reduction factor $r_{304}$	0.3 (0.6 of material thickness 2 mm)	
Reduction factor $r_{Si37}$	1	

#### Nominal ratings

Operating voltage	$U_B$	10 ... 30 V
Switching frequency	$f$	0 ... 200 Hz
Hysteresis	$H$	3 ... 15 typ. 5 %
Reverse polarity protected	yes	
Short-circuit protection	yes	
Voltage drop	$U_d$	$\leq 2$ V
Operating current	$I_L$	0 ... 200 mA
Off-state current	$I_r$	$\leq 0.1$ mA
No-load supply current	$I_0$	$\leq 10$ mA
Indication of the switching state	LED, yellow	

#### Limit data

Operating pressure statically	60 bar (870.2 psi) max.
-------------------------------	-------------------------

#### Ambient conditions

Ambient temperature	-25 ... 85 °C (-13 ... 185 °F)
---------------------	--------------------------------

#### Mechanical specifications

Connection type	cable TPE-S, 2 m
Housing material	Stainless steel 1.4435 / AISI 316L
Sensing face	Stainless steel 1.4435 / AISI 316L
Protection degree	IP68 / IP69K
Mass	112 g

#### Compliance with standards and directives

Standard conformity	
Standards	EN 60947-5-2:2007 IEC 60947-5-2:2007

#### Approvals and certificates

UL approval	cULus Listed, General Purpose
CSA approval	cCSAus Listed, General Purpose
CCC approval	Products with a maximum operating voltage of $\leq 36$ V do not bear a CCC marking because they do not require approval.