

Comfort series  
2 mm embeddable

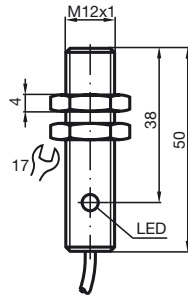

CE

General specifications	
Switching element function	AC Make function
Rated operating distance $s_n$	2 mm
Installation	embeddable
Assured operating distance $s_a$	0 ... 1.62 mm
Reduction factor $r_{Al}$	0.1
Reduction factor $r_{Cu}$	0.1
Reduction factor $r_{V2A}$	0.6
Nominal ratings	
Operating voltage $U_B$	20 ... 253 V
Switching frequency $f$	0 ... 20 Hz
Voltage drop $U_d$	typ. 4 V bei 15 ... 200 mA typ. 6,5 V bei 5 mA
Momentary current (20 ms, 0.1 Hz)	0 ... 1200 mA
Operating current $I_L$	5 ... 200 mA
Off-state current $I_r$	typ. 0.7 mA
Indication of the switching state	LED, yellow
Standard conformity	
Standards	IEC / EN 60947-5-2:2004
Ambient conditions	
Ambient temperature	-25 ... 70 °C (248 ... 343 K)
Mechanical specifications	
Connection type	2 m, PVC cable
Core cross-section	0.34 mm <sup>2</sup>
Housing material	Stainless steel
Sensing face	PBT
Protection degree	IP67

### Connection type:

