

Basic series  
 3 mm embeddable  
 Analogue output  
 0 V ... 10 V/4 mA ... 20 mA

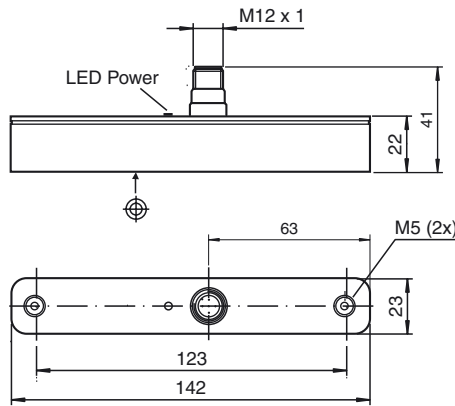

General specifications	
Switching element function	analogue, current or voltage output
Object distance	max. 3 mm
Installation	embeddable
Output polarity	DC
Reduction factor $r_{AI}$	0.45
Reduction factor $r_{Cu}$	0.4
Reduction factor $r_{V2A}$	0.75
Measurement range	0 ... 120 mm
Nominal ratings	
Operating voltage $U_B$	18 ... 30 V
Reverse polarity protection	protected against reverse polarity
Short-circuit protection	pulsing
Output voltage	0 ... 10 V
Output rated operating current	4 ... 20 mA
Linearity error	$\pm 0.4$ mm
Temperature drift	$\pm 0.5$ mm (-25 °C ... 70 °C)
Repeat accuracy	$\pm 0.2$ mm
Resolution	125 $\mu$ m
No-load supply current $I_0$	$\leq 35$ mA
Load resistor	voltage output: $> 1000 \Omega$ current output: $< 400 \Omega$
Operating voltage display	LED green
Standard conformity	
EMC in accordance with	IEC / EN 60947-5-2:2004
Standards	IEC / EN 60947-5-2:2004
Ambient conditions	
Ambient temperature	-25 ... 70 °C (248 ... 343 K)
Mechanical specifications	
Connection type	M12 connector
Housing material	ABS
Protection degree	IP67
Protection class	II
Note	The data relating to accuracy only apply to a distance to the object to be detected of 1 ... 3 mm.

dimensions for the target object:

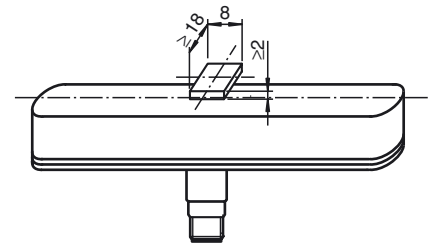

### Connection type:

IU

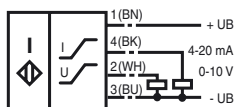

Core colours in accordance with EN 60947-5-2.