

**62**  
Spec 2.1

**Model Number**

**VBA-4E3A-CB-E/E2-P**

Printed circuit board module 4 inputs / 3 outputs

**Features**

- A/B slave with extended addressing possibility for up to 62 slaves
- Integrated communication monitoring function
- Inputs and outputs short-circuit and overload proof
- No external power supply required
- Connection via pins

**Function**

The VBA-4E3A-CB-E/E2-P AS-Interface coupling module is the circuit board solution for an AS-Interface slave. The module is ideal for integration into customer-specific electronics, e.g. keypads, actuators, etc. The circuit board is supplied by the AS-Interface. The inputs and outputs are short-circuit and overload-proof.

**Note:**

In the case of communication errors on the bus, the outputs are de-energised via an integrated watchdog.

Pepperl+Fuchs can customise connectors and circuit board sizes e.g. for 2EA, 2E1A, ... models to meet your specific applications.

**Dimensions**

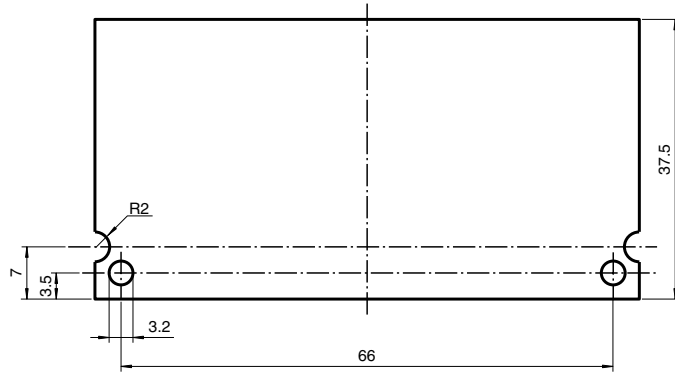

**Electrical connection**

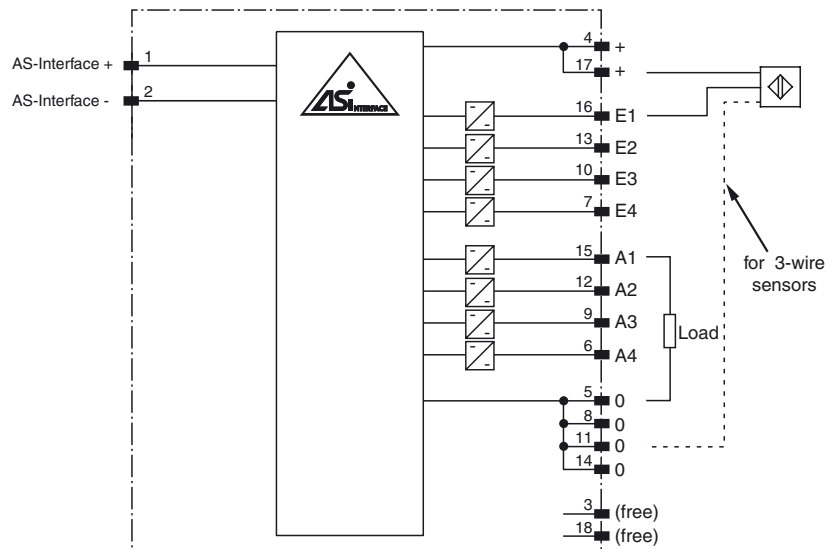

**Indicating / Operating means**

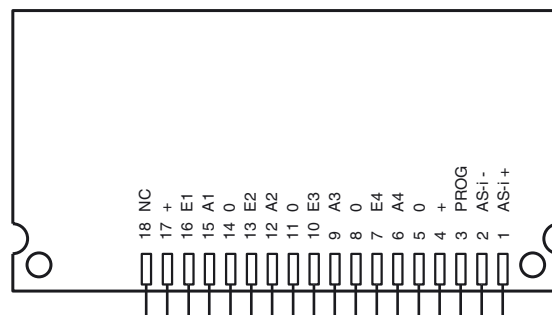

Release date: 2007-11-22 17:25 Date of issue: 2007-12-13 12:1682\_ENG.xml

**Technical data****General specifications**

Slave type	A/B slave
------------	-----------

**Electrical specifications**

Protection class	III
Rated operational voltage	$U_e$ 26.5 ... 31.6 V from AS-Interface
Rated operational current	$I_e$ $\leq$ 20 mA (without sensors)

**Input**

Number/Type	4 inputs for mechanical contacts
Supply	from AS-Interface
Voltage	21 ... 31 V
Input current	$\leq$ 8 mA (limited internally)
Switching point	
0 (unattenuated)	$\leq$ 1 mA
1 (attenuated)	$\geq$ 5 mA

**Output**

Number/Type	3 electronic outputs, PNP
Supply	from AS-Interface
Current	$\leq$ 80 mA per output, $\leq$ 80 mA total
Voltage	21 ... 31 V

**Programming instructions**

Profile	S-7.A.E
IO code	7
ID code	A
ID2 code	E

Data bits (function via AS-Interface)	input	output
D0	IN1	OUT1
D1	IN2	OUT2
D2	IN3	OUT3
D3	IN4	-

**Parameter bits (programmable via AS-i) function**

P0	not used
P1	not used
P2	not used
P3	not used

**Ambient conditions**

Ambient temperature	-25 ... 70 °C (248 ... 343 K)
Storage temperature	-40 ... 70 °C (233 ... 343 K)

**Mechanical specifications**

Protection degree	IP20 (completely fitted) according to EN 60529
Connection	plug connector (pins)