

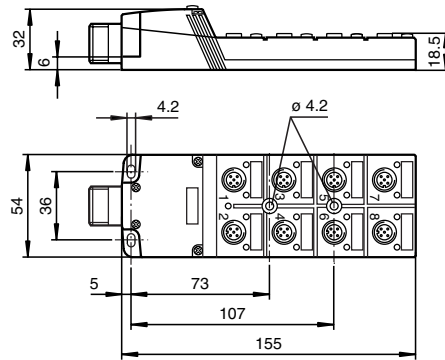

Dimensions



Model number

SACB-8/16-L-SC

Splitter box octuple, twin configuration, with cage-clamp terminals

Features

- Fast, simple installation with cage clamp terminals
- Twin communication of the plug-in stations
- LED indicator for module supply and I/O status
- Protection degree IP67

Accessories

MH 05-SACB-8

Mounting aid

VAZ-V1-B

Blind plug

V15S-T-V15

Y-distributor

Technical data

General specifications

Number of poles 5

Indicators/operating means

LED green supply voltage each module
LED yellow I/O status indication

Electrical specifications

Operating voltage 24 V DC, max. 30 V DC
Operating current ≤ 5 mA per channel indication element
Current loading capacity ≤ 2 A per channel, ≤ 4 A per plug-in station, ≤ 12 A total current per separator

Ambient conditions

Ambient temperature -25 ... 75 °C (248 ... 348 K)

Mechanical specifications

Protection degree IP67 according to EN 60529
Connection spring-loaded terminals for wire cross section 0.2 ... 1.5 mm²
Sockets M12, 5 pin

Cable

Sheath diameter 6.5 ... 9.5 mm

Mass approx. 170 g

Electrical connection

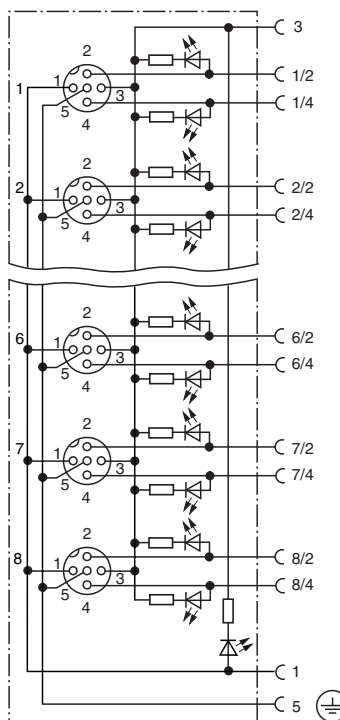

Terminal compartment/ Cage clamp terminals	M-socket/pole
1/4	1/4 (A)
1/2	1/2 (B)
2/4	2/4 (A)
2/2	2/2 (B)
3/4	3/4 (A)
3/2	3/2 (B)
4/4	4/4 (A)
4/2	4/2 (B)
5/4	5/4 (A)
5/2	5/2 (B)
6/4	6/4 (A)
6/2	6/2 (B)
7/4	7/4 (A)
7/2	7/2 (B)
8/4	8/4 (A)
8/2	8/2 (B)
UN	1 ... 8/1 (+24 V)
PE	1 ... 8/5 (PE)
0 V	1 ... 8/3 (0 V)

Display

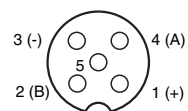

M12-socket twin configuration