



Model Number

SB2-Z0 GELB

Features

- 2 mm slot width
- Basic series
- 2-wire sensor

Connection

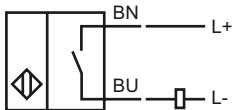

Dimensions

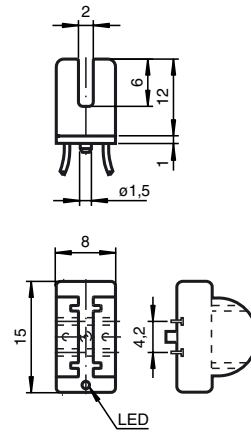

Technical Data

General specifications

Switching element function	DC	NO
Slot width	2 mm	
Depth of immersion (lateral)	5 ... 7	
Installation	not embeddable	
Output polarity	DC	

Nominal ratings

Operating voltage	U_B	5 ... 30 V DC
Switching frequency	f	0 ... 2000 Hz
Hysteresis	H	0 ... 0.05 mm
Reverse polarity protected	tolerant	
Short-circuit protection	pulsing	
Voltage drop	U_d	≤ 4.9 V
Operating current	I_L	2 ... 50 mA
Off-state current	I_r	0 ... 0.5 mA typ.
Indication of the switching state	LED, yellow	

Ambient conditions

Ambient temperature	-25 ... 70 °C (-13 ... 158 °F)
---------------------	--------------------------------

Mechanical specifications

Connection type	flexible leads LIFYW , 500 mm
Core cross-section	0.06 mm ²
Housing material	PBT
Protection degree	IP67

Compliance with standards and directives

Standard conformity	
Standards	EN 60947-5-2:2007 IEC 60947-5-2:2007

Approvals and certificates

UL approval	cULus Listed, General Purpose
CSA approval	cCSAus Listed, General Purpose
CCC approval	Products with a maximum operating voltage of ≤ 36 V do not bear a CCC marking because they do not require approval.

Release date: 2010-11-16 09:25 Date of issue: 2010-11-18 105928_ENG.xml