



Model Number

NCN15-30GM70-B3-V1

Features

- Comfort series
- 15 mm non-flush
- NO/NC selectable
- Prefailure message and indicator

Connection

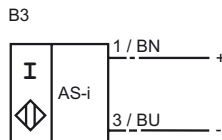

Accessories

BF 30

Mounting flange, 30 mm

V1-W

4-pin, M12 female field-attachable connector

V1-G-2M-PUR

Cable socket, M12, 4-pin, PUR cable

V1-W-2M-PUR

Cable socket, M12, 4-pin, PUR cable

Dimensions

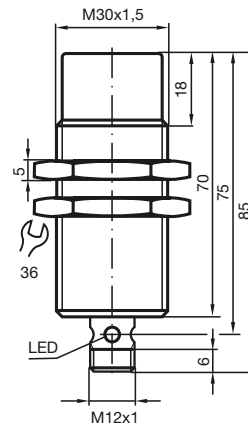

Technical Data

General specifications

Switching element function		NO/NC programmable
Rated operating distance	s_n	15 mm
Installation		non-flush
Output polarity		AS-Interface
Assured operating distance	s_a	0 ... 12.1 mm
Reduction factor r_{Al}		0.38
Reduction factor r_{Cu}		0.36
Reduction factor r_{304}		0.72
Reduction factor r_{Brass}		0.45

Nominal ratings

Operating voltage	U_B	26.5 ... 31.9 V via AS-i bus system
Switching frequency	f	0 ... 50 Hz
Hysteresis	H	typ. 5 %
Indication of the switching state		Multihole-LED, yellow

Standard conformity

Standards	IEC / EN 60947-5-2:2004
-----------	-------------------------

Ambient conditions

Ambient temperature	-25 ... 70 °C (-13 ... 158 °F)
Storage temperature	-40 ... 85 °C (-40 ... 185 °F)

Mechanical specifications

Housing material	Stainless steel
Sensing face	PBT
Protection degree	IP67

Programming Instructions

Adresse 00	preset, alterable via Bus-master or programming units
IO-code 1	
ID-code 1	

Data bit

Bit	Function
D0	Switching state
D1	pre-fault signal (dynamic)
D2	ready for operation
D3	not used

Parameter bit

Bit	Function
P0	not used
P1	Switching element function NO* / NC
P2	not used
P3	not used

* Standard setting