



## Model Number

NCB5-18GM40-Z1-V1

## Features

- Comfort series
- 5 mm flush
- 2-wire DC

## Connection

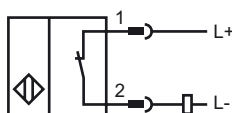

## Pinout

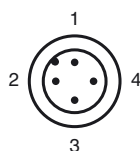

Wire colors in accordance with EN 60947-5-2

1	BN	(brown)
2	WH	(white)
3	BU	(blue)
4	BK	(black)

## Accessories

### V1-W

4-pin, M12 female field-attachable connector

### V1-G

4-pin, M12 female field-attachable connector

### V1-W-2M-PUR

Cable socket, M12, 4-pin, PUR cable

### EXG-18

Quick mounting bracket with dead stop

### BF 18

Mounting flange, 18 mm

### V1-G-2M-PUR

Cable socket, M12, 4-pin, PUR cable

## Dimensions

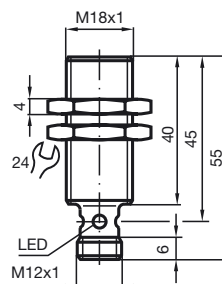

## Technical Data

### General specifications

Switching element function	DC	NC
Rated operating distance	$s_n$	5 mm
Installation		flush
Output polarity		DC
Assured operating distance	$s_a$	0 ... 4.05 mm
Reduction factor $r_{Al}$		0.37
Reduction factor $r_{Cu}$		0.33
Reduction factor $r_{304}$		0.7

### Nominal ratings

Operating voltage	$U_B$	5 ... 60 V
Switching frequency	$f$	0 ... 350 Hz
Hysteresis	$H$	1 ... 10 typ. 5 %
Reverse polarity protected		tolerant
Short-circuit protection		pulsing
Voltage drop	$U_d$	$\leq 5$ V
Operating current	$I_L$	2 ... 100 mA
Lowest operating current	$I_m$	2 mA
Off-state current	$I_r$	0 ... 0.5 mA typ.
Indication of the switching state		Multihole-LED, yellow

### Functional safety related parameters

MTTF <sub>d</sub>	1730 a
Mission Time ( $T_M$ )	20 a
Diagnostic Coverage (DC)	0 %

### Ambient conditions

Ambient temperature	-25 ... 70 °C (-13 ... 158 °F)
---------------------	--------------------------------

### Mechanical specifications

Connection type	Device connector M12 x 1, 4-pin
Housing material	Stainless steel 1.4305 / AISI 303
Sensing face	PBT
Protection degree	IP67

### Compliance with standards and directives

Standard conformity	
Standards	EN 60947-5-2:2007 IEC 60947-5-2:2007

### Approvals and certificates

UL approval	cULus Listed, General Purpose
CSA approval	cCSAus Listed, General Purpose
CCC approval	Certified by China Compulsory Certification (CCC)