



Model Number

NBN15-30GM75-WS-V11

Features

- 2-wire AC
- Not embeddable mountable

Connection

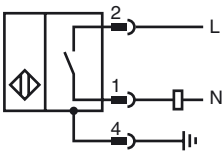

Pinout

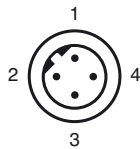

Wire colors

1	BU
2	BN
4	GN/YE

Dimensions

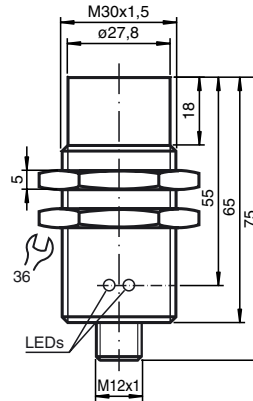

Technical Data

General specifications

Switching element function	AC	NO
Rated operating distance	s_n	15 mm
Installation	not embeddable	
Output polarity	AC	
Assured operating distance	s_a	0 ... 12.2 mm
Reduction factor r_{Al}	0.43	
Reduction factor r_{Cu}	0.41	
Reduction factor r_{V2A}	0.82	

Nominal ratings

Operating voltage	U_B	20 ... 253 V
Switching frequency	f	0 ... 20 Hz
Hysteresis	H	typ. 5 %
Voltage drop	U_d	≤ 8 V
Momentary current (20 ms, 0.1 Hz)	0 ... 1600 mA	
Operating current	I_L	5 ... 200 mA
Off-state current	I_r	0 ... 1.7 mA typ.
Operating voltage display	LED, green	
Indication of the switching state	LED, yellow	

Standard conformity

Standards	IEC / EN 60947-5-2:2004
-----------	-------------------------

Ambient conditions

Ambient temperature	-25 ... 70 °C (-13 ... 158 °F)
---------------------	--------------------------------

Mechanical specifications

Connection type	Device connector M12 x 1 , 3-pin
Cable version	PA
Housing material	brass, nickel-plated
Sensing face	PBT
Protection degree	IP67

Release date: 2011-03-22 11:52 Date of issue: 2011-03-22 088614_ENG.xml