



### Model Number

NBB10-30GK50-E0

### Features

- With increased sealing, protection class IP68 / IP69k

### Connection

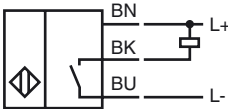

### Accessories

#### BF 30

Mounting flange, 30 mm

### Dimensions

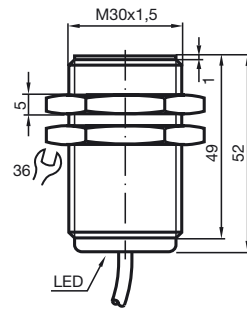

### Technical Data

#### General specifications

Switching element function		NPN	NO
Rated operating distance	$s_n$	10 mm	
Installation		embeddable	
Output polarity		DC	
Assured operating distance	$s_a$	0 ... 8.1 mm	
Reduction factor $r_{Al}$		0.3	
Reduction factor $r_{Cu}$		0.3	
Reduction factor $r_{303}$		0.8	

#### Nominal ratings

Operating voltage	$U_B$	10 ... 30 V
Switching frequency	$f$	0 ... 200 Hz
Reverse polarity protected		reverse polarity protected
Short-circuit protection		pulsing
Voltage drop	$U_d$	$\leq 3$ V
Operating current	$I_L$	0 ... 200 mA
Off-state current	$I_r$	0 ... 0.5 mA typ. 0.1 $\mu$ A at 25 °C
No-load supply current	$I_0$	$\leq 20$ mA
Indication of the switching state		all direction LED, yellow

#### Ambient conditions

Ambient temperature	-25 ... 70 °C (-13 ... 158 °F)
---------------------	--------------------------------

#### Mechanical specifications

Connection type	cable PVC , 2 m
Core cross-section	0.34 mm <sup>2</sup>
Housing material	PBT
Sensing face	PBT
Protection degree	IP68 / IP69K
Note	use only delivered nuts

#### Compliance with standards and directives

Standard conformity	
Standards	EN 60947-5-2:2007 IEC 60947-5-2:2007

#### Approvals and certificates

UL approval	cULus Listed, General Purpose
CSA approval	cCSAus Listed, General Purpose
CCC approval	Products with a maximum operating voltage of $\leq 36$ V do not bear a CCC marking because they do not require approval.