



Model Number

NBN8-18GM40-Z1-V1

Features

- Basic series
- 8 mm not embeddable

Connection

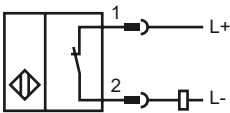

Pinout

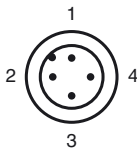

Wire colors in accordance with EN 60947-5-2

1	BN
2	WH
3	BU
4	BK

Dimensions

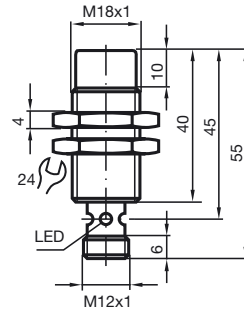

Technical Data

General specifications

Switching element function	DC	Break function
Rated operating distance	s_n	8 mm
Installation	not embeddable	
Output polarity	DC	
Assured operating distance	s_a	0 ... 6.5 mm
Reduction factor r_{AI}	0.43	
Reduction factor r_{Cu}	0.42	
Reduction factor r_{V2A}	0.73	

Nominal ratings

Operating voltage	U_B	5 ... 60 V
Switching frequency	f	0 ... 450 Hz
Hysteresis	H	1 ... 10 typ. 5 %
Reverse polarity protection	tolerant	
Short-circuit protection	pulsing	
Voltage drop	U_d	≤ 5 V
Operating current	I_L	2 ... 100 mA
Off-state current	I_r	0 ... 0.5 mA typ.
Indication of the switching state	Multihole-LED, yellow	

Standard conformity

Standards	IEC / EN 60947-5-2:2004
-----------	-------------------------

Ambient conditions

Ambient temperature	-25 ... 70 °C (248 ... 343 K)
---------------------	-------------------------------

Mechanical specifications

Connection type	V1-connector
Cable version	PA
Core cross-section	-
Housing material	brass, nickel-plated
Sensing face	PBT
Protection degree	IP67