



Model Number

NBB3-V3-Z5-V5

Features

- 3 mm embeddable
- 2-wire DC

Connection

Z5

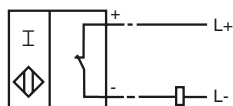

Dimensions

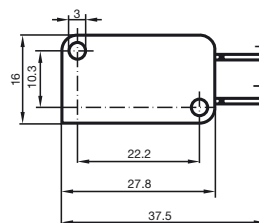
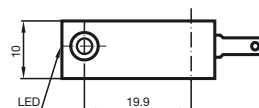

Technical Data

General specifications

Switching element function	DC	NC
Rated operating distance	s_n	3 mm
Installation	embeddable	
Output polarity	DC	
Assured operating distance	s_a	0 ... 2.4 mm
Reduction factor r_{Al}	0.4	
Reduction factor r_{Cu}	0.3	
Reduction factor r_{304}	0.8	

Nominal ratings

Operating voltage	U_B	5 ... 60 V DC
Switching frequency	f	0 ... 2000 Hz
Hysteresis	H	typ. 0.2 %
Reverse polarity protected	reverse polarity protected	
Voltage drop	U_d	≤ 5 V
Operating current	I_L	4 ... 100 mA
Lowest operating current	I_m	4 mA
Off-state current	I_r	0 ... 1 mA typ. 0.7 mA
Indication of the switching state	LED, yellow	

Limit data

Tightening torque, fastening screws	0.4 Nm
-------------------------------------	--------

Ambient conditions

Ambient temperature	-25 ... 70 °C (-13 ... 158 °F)
---------------------	--------------------------------

Mechanical specifications

Connection type	4.8 mm Faston
Housing material	PBT
Sensing face	PBT
Protection degree	IP67

Compliance with standards and directives

Standard conformity	
Standards	EN 60947-5-2:2007 IEC 60947-5-2:2007

Approvals and certificates

UL approval	cULus Listed, General Purpose
CSA approval	cCSAus Listed, General Purpose
CCC approval	Certified by China Compulsory Certification (CCC)