



Model Number

NBN3-F25F-Z8-V1

Features

- For installation in housing
- Satisfies machinery directive

Connection

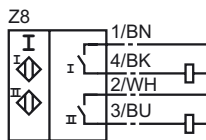

Pinout

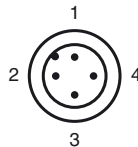

Wire colors in accordance with EN 60947-5-2

1	BN	(brown)
2	WH	(white)
3	BU	(blue)
4	BK	(black)

Accessories

BT32

BT32XS

Activator for F25 series

BT32XAS

Activator for F25 series

BT33

BT34

V1-G

4-pin, M12 female field-attachable connector

V1-W

4-pin, M12 female field-attachable connector

V1-W-2M-PUR

Dimensions

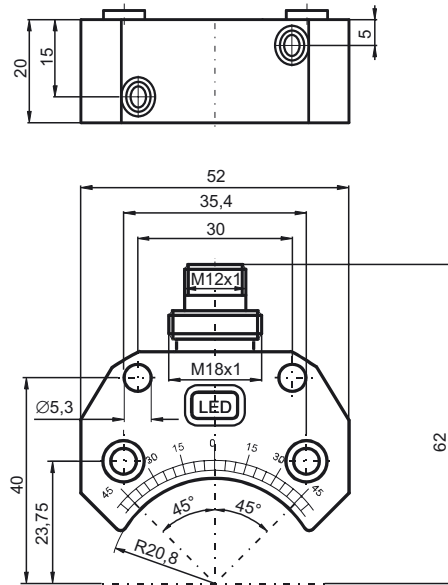

Technical Data

General specifications

Switching element function	Dual (NO)
Rated operating distance	s_n 3 mm
Installation	embeddable mountable
Output polarity	DC
Assured operating distance	s_a 0 ... 2.43 mm
Reduction factor r_{Al}	0.5
Reduction factor r_{Cu}	1
Reduction factor r_{303}	1
Reduction factor r_{Si37}	1.1

Nominal ratings

Operating voltage	U_B 6 ... 60 V DC
Switching frequency	f 0 ... 500 Hz
Hysteresis	H typ. %
Reverse polarity protected	tolerant
Short-circuit protection	no
Voltage drop	U_d \leq 5 V
Operating current	I_L 4 ... 100 mA
Lowest operating current	I_m 4 mA
Off-state current	I_r 0 ... 1 mA typ. 0.7 mA
Indication of the switching state	LED, yellow

Limit data

Tightening torque, fastening screws	0.4 Nm
-------------------------------------	--------

Ambient conditions

Ambient temperature	-25 ... 70 °C (-13 ... 158 °F)
---------------------	--------------------------------

Mechanical specifications

Connection type	Device connector M12 x 1 , 4-pin
Housing material	PBT
Sensing face	PBT
Protection degree	IP67
Tightening torque, fastening screws	M5 x 25 : 2.7 Nm
Note	Installation in housing

Compliance with standards and directives

Standard conformity	
Standards	EN 60947-5-2:2007 IEC 60947-5-2:2007

Approvals and certificates

UL approval	cULus Listed, General Purpose
CSA approval	cCSAus Listed, General Purpose

Release date: 2011-07-28 14:48 Date of issue: 2011-07-28 085122_eng.xml