



Model Number

NJ8-18GM50-E0

Features

- Comfort series
- 8 mm not embeddable

Connection

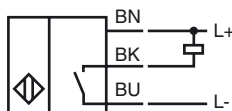

Accessories

BF 18

Mounting flange, 18 mm

Dimensions

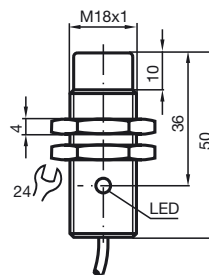

Technical Data

General specifications

Switching element function		NPN	NO
Rated operating distance	s_n	8 mm	
Installation		not embeddable	
Output polarity		DC	
Assured operating distance	s_a	0 ... 6.48 mm	
Reduction factor r_{AI}		0.42	
Reduction factor r_{Cu}		0.4	
Reduction factor r_{304}		0.72	

Nominal ratings

Installation conditions			
A		10 mm	
B		54 mm	
C		24 mm	
Operating voltage	U_B	10 ... 60 V	
Switching frequency	f	0 ... 1000 Hz	
Hysteresis	H	1 ... 15 typ. 7.5 %	
Reverse polarity protected		reverse polarity protected	
Short-circuit protection		pulsing	
Voltage drop	U_d	≤ 3 V	
Operating current	I_L	0 ... 200 mA	
Lowest operating current	I_m	0 mA	
Off-state current	I_r	0 ... 0.5 mA typ. 0.01 mA	
No-load supply current	I_0	≤ 9 mA	
Indication of the switching state		LED, yellow	

Ambient conditions

Ambient temperature	-25 ... 70 °C (-13 ... 158 °F)
Storage temperature	-40 ... 85 °C (-40 ... 185 °F)

Mechanical specifications

Connection type	cable PVC , 2 m
Core cross-section	0.5 mm ²
Housing material	Stainless steel 1.4305 / AISI 303
Sensing face	PBT
Protection degree	IP67

Compliance with standards and directives

Standard conformity	
Standards	EN 60947-5-2:2007 IEC 60947-5-2:2007

Approvals and certificates

UL approval	cULus Listed, General Purpose
CSA approval	cCSAus Listed, General Purpose
CCC approval	Certified by China Compulsory Certification (CCC)