



**Model Number**

PL2-F25-E8-S

**Features**

- For installation in housing
- PL2... without valve connection
- Satisfies machinery directive

**Connection**

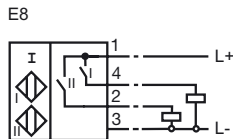

**Accessories**

- BT32**  
Activator for F25 series
- BT32XS**  
Activator for F25 series
- BT32XAS**  
Activator for F25 series
- BT33**  
Activator for F25 series
- BT34**  
Activator for F25 series

**Dimensions**

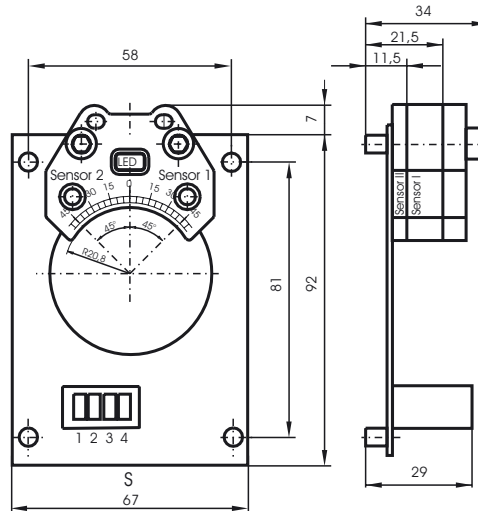

**Technical Data**

**General specifications**

Switching element function		PNP	Dual NO
Rated operating distance	$s_n$	3 mm	
Installation		embeddable mountable	
Output polarity		DC	
Assured operating distance	$s_a$	0 ... 2.43 mm	
Reduction factor $r_{AI}$		0.5	
Reduction factor $r_{304}$		1	
Reduction factor $r_{SI37}$		1.1	

**Nominal ratings**

Operating voltage	$U_B$	10 ... 30 V DC
Switching frequency	$f$	0 ... 100 Hz
Hysteresis	$H$	typ. 5 %
Reverse polarity protected		reverse polarity protected
Short-circuit protection		pulsing
Voltage drop	$U_d$	$\leq 3$ V
Operating current	$I_L$	0 ... 200 mA
Off-state current	$I_r$	0 ... 0.5 mA typ. 0.1 $\mu$ A at 25 °C
No-load supply current	$I_0$	$\leq 25$ mA
Operating voltage display		LED, green
Indication of the switching state		LED, yellow

**Ambient conditions**

Ambient temperature	-25 ... 70 °C (-13 ... 158 °F)
Storage temperature	-40 ... 85 °C (-40 ... 185 °F)

**Mechanical specifications**

Housing material	PBT
Sensing face	PBT
Protection degree	IP20

**Compliance with standards and directives**

Standard conformity	
Standards	EN 60947-5-2:2007 IEC 60947-5-2:2007

Release date: 2011-07-28 14:50 Date of issue: 2012-02-03 044567\_eng.xml



Type code: **PL2-F25-E8-S**

**Circuit board** **PL2-F25-E8-S**

PL2 Without valve connection

**Sensor type** **PL2-F25-E8-S**

F25 F25 proximity switch  
standard series

**Electrical type** **PL2-F25-E8-S**

E8 3-wire DC

**Connection technology** **PL2-F25-E8-S**

S Removable screw terminal

Release date: 2011-07-28 14:50 Date of issue: 2012-02-03 044567\_eng.xml