



Model Number

VAA-4EA-CB-E/E2

Printed circuit board module
4 inputs/4 outputs

Features

- AS-Interface certificate
- Integrated communication monitoring function
- Inputs and outputs short-circuit and overload proof
- No external power supply required

Function

The VAA-4EA-CB-E/E2 AS-Interface coupling module is the circuit board solution for an AS-Interface slave. The module is ideal for integration into customer-specific electronics, e. g. keypads, actuators, etc. The circuit board is supplied by the AS-Interface. The inputs and outputs are short-circuit and overload-proof.

Note:

In the case of communication errors on the bus, the outputs are de-energised via an integrated watchdog.

P+F can customise connectors and circuit board sizes e. g. for 2EA, 2E1A, ... models to meet your specific applications.

Dimensions

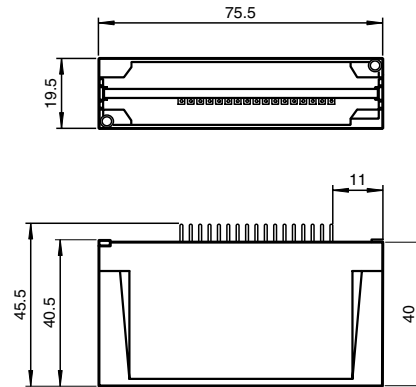

Electrical connection

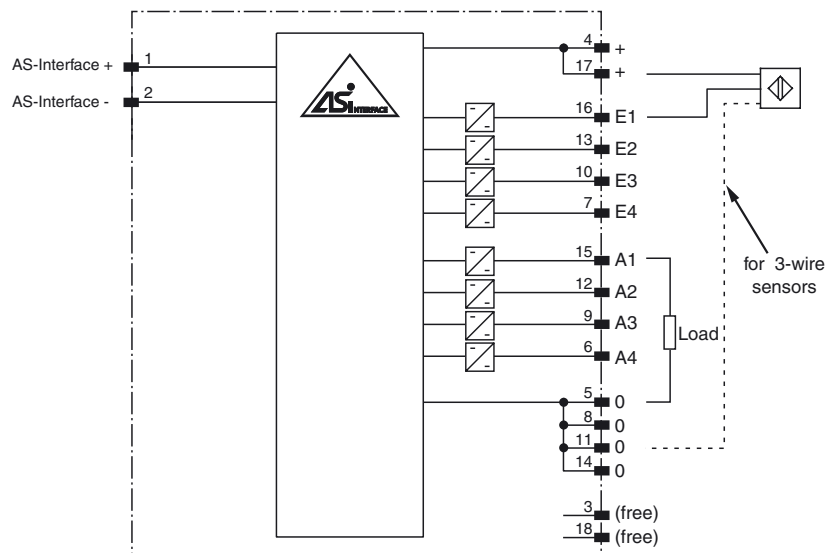

Indicating / Operating means

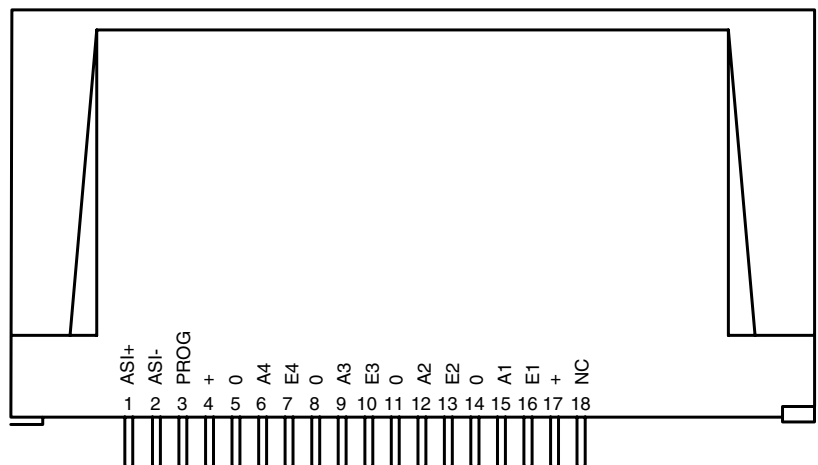

Release date: 2007-11-22 17:25 Date of issue: 2007-12-13 040925_ENG.xml

Technical data**General specifications**

| | |
|------------|----------------|
| Slave type | Standard slave |
|------------|----------------|

Electrical specifications

| | | |
|---------------------------|-------|-----------------------------------|
| Rated operational voltage | U_e | 26.5 ... 31.6 V from AS-Interface |
| Rated operational current | I_e | ≤ 20 mA (without sensors) |

Input

| | |
|-----------------|---|
| Number/Type | 4 inputs for 2- or 3-wire sensors (PNP), DC |
| Switching point | OFF ≤ 1.5 mA ON ≥ 5 mA |

Output

| | |
|-------------|--|
| Number/Type | 4 electronic outputs, PNP |
| Supply | from AS-Interface |
| Current | ≤ 45 mA per output, ≤ 180 mA total |

Programming instructions

| | |
|---------|-------|
| Profile | S-7.0 |
| IO code | 7 |
| ID code | 0 |

| Data bits (function via AS-Interface) | input | output |
|---------------------------------------|-------|--------|
| D0 | IN1 | OUT1 |
| D1 | IN2 | OUT2 |
| D2 | IN3 | OUT3 |
| D3 | IN4 | OUT4 |

Parameter bits (programmable via AS-i) function

| | |
|----|----------|
| P0 | not used |
| P1 | not used |
| P2 | not used |
| P3 | not used |

Ambient conditions

| | |
|---------------------|-------------------------------|
| Ambient temperature | -25 ... 70 °C (248 ... 343 K) |
| Storage temperature | -40 ... 70 °C (233 ... 343 K) |

Mechanical specifications

| | |
|-------------------|--|
| Protection degree | IP00 (solder pins), IP20 (completely fitted); according to EN 60529 |
| Connection | Installed printed circuit board grid dimension 2.54 mm |