



OSW3000-F20-M7

Optical scanner

OSW3000-F20-M7

CE



Laser Class II



- ◆ **Function modes:**
 - Standard width measurement
 - Accumulating width measurement
 - Edge detection
- ◆ **Scanning zone 174°**
- ◆ **Laser class 2, eyesafe**
- ◆ **Parameterisable via Windows software**
- ◆ **Fully automatic TEACH-IN: Static and dynamic, up to the max. switching frequency**
- ◆ **Self test**
- ◆ **Factory settings reset function**
- ◆ **TEACH-IN at the optimum threshold adjustment**
- ◆ **Supplied with retroreflective film and software**

Release date: 2007-06-18 13:27 Date of issue: 2007-06-18 040163_ENG.xml

General specifications

Upper limit of the sensing range	3000 mm
Reference target	Supplied with film included
Light type	semi-conductor laser 655 nm

Indicators/operating means

LED yellow	switch output OUT A
------------	---------------------

Electrical specifications

Rated operational voltage U_e	18 ... 30 V DC
No-load supply current I_0	≤ 300 mA

Output

Output type	3 switch outputs E2 pnp, NO; 1 analogue output 0/2 ... 10 V
Rated operational current I_e	100 mA , short-circuit/overload protected
Voltage drop U_d	≥ 2.5 V (measured over the load)
Switching frequency f	10 Hz
Switch-on delay t_{on}	100 ms

Standard conformity

Standards	EN 60947-5-2
-----------	--------------

Ambient conditions

Ambient temperature	0 ... 50 °C (273 ... 323 K)
Storage temperature	-40 ... 80 °C (233 ... 353 K)

Mechanical specifications

Connection	connector (M18 x 1), 12 pin
Material	
Housing	ABS
Optical face	PMMA
Mass	1200 g



OSW3000-F20-M7

Dimensions

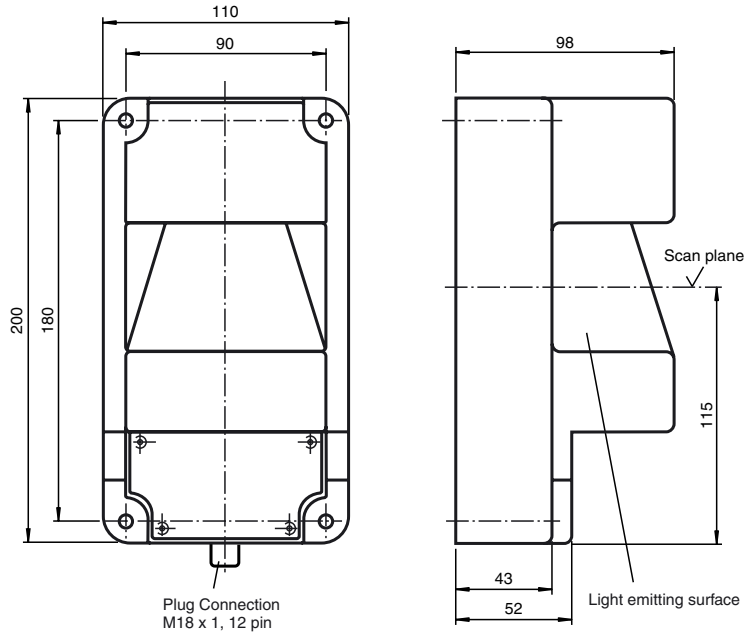

Electrical connection

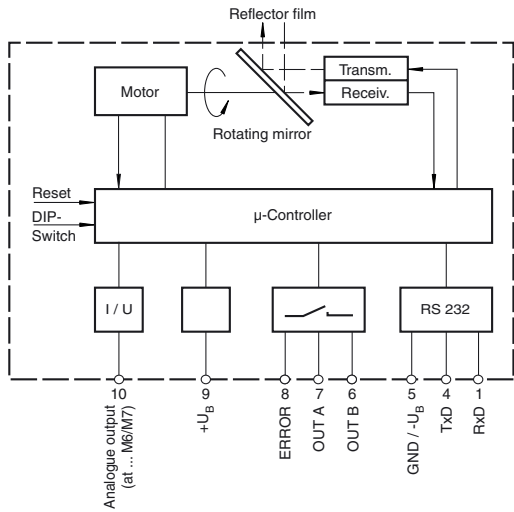

\circ = light ON, \bullet = dark ON