



CE

Model Number

NCN4-12GM60-B3-V1

Features

- Comfort series
- 4 mm non-flush
- NO/NC selectable

Connection

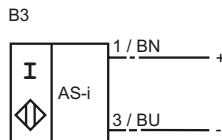

Dimensions

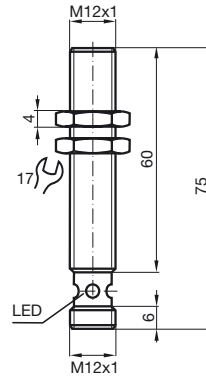

Technical Data

General specifications

Switching element function	NO/NC programmable
Rated operating distance	s_n 4 mm
Installation	non-flush
Output polarity	AS-Interface
Assured operating distance	s_a 0 ... 3.24 mm
Reduction factor r_{Al}	0.37
Reduction factor r_{Cu}	0.36
Reduction factor r_{304}	0.74
Reduction factor r_{Brass}	0.47

Nominal ratings

Operating voltage	U_B	26.5 ... 31.9 V via AS-i bus system
Switching frequency	f	0 ... 350 Hz
Hysteresis	H	1 ... 10 typ. 5 %
Reverse polarity protected		reverse polarity protected
Short-circuit protection		yes
Current consumption		
Measuring plate not detected		≥ 3 mA
Measuring plate detected		≤ 1 mA
Indication of the switching state		Multihole-LED, yellow

Standard conformity

EMC in accordance with	IEC / EN 60947-5-2:2004
Standards	IEC / EN 60947-5-2:2004

Ambient conditions

Ambient temperature	-25 ... 70 °C (-13 ... 158 °F)
Storage temperature	-40 ... 85 °C (-40 ... 185 °F)

Mechanical specifications

Core cross-section	
Housing material	Stainless steel
Sensing face	PBT
Protection degree	IP67

Programming Instructions

Address 00	preset, alterable via Bus-master programming units
IO-Code	1
ID-Code	1

Data bit

Bit	Function
D0	Switching state
D1	not used
D2	ready for operation
D3	not used

Parameter bit

Bit	Function
P0	not used
P1	Switching element function NO* / NC
P2	not used
P3	not used

*Standard setting