

Model Number

VAA-2E1A-CB-N/E2-Y36498

Printed circuit board module 2 inputs / 1 output

Features

- AS-Interface certificate
- Inputs and outputs short-circuit and overload proof
- No external power supply required

Function

The AS-Interface interface module VAA-2E1A-CB-N/E2-Y36498 is the circuit board solution for an AS-Interface slave. The module is ideal for the integration in customer-specific electronics, e. g. key pads, actuators, etc. The printed circuit board is supplied wholly by the AS-Interface. The inputs and outputs are short-circuit and overload-proof.

Note:

In the case of communication errors on the AS-Interface line, the outputs are de-energised via an integrated watchdog.

This printed circuit board offers the possibility of short-notice, customer-specific designs (e. g.: 2EA, 2E1A, ...). It is also possible to change circuit board dimensions and plug connections.

Dimensions

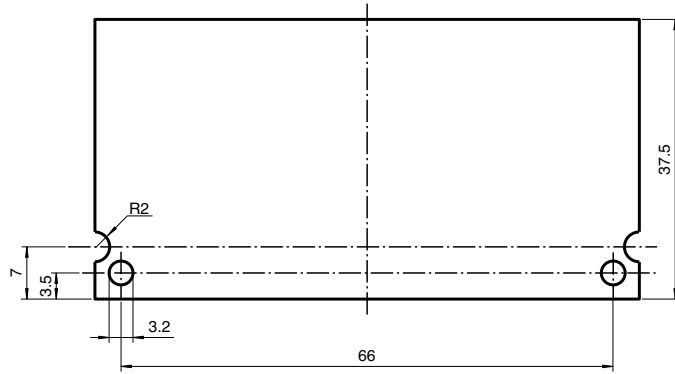

Electrical connection

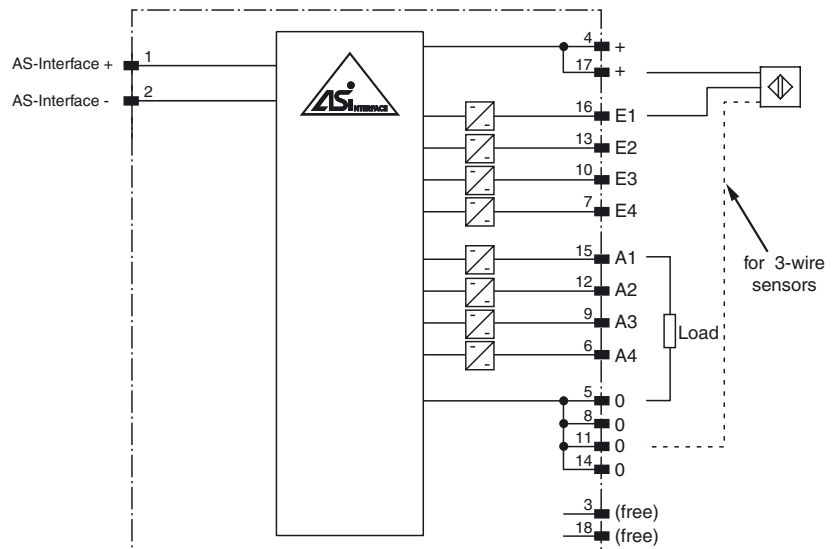

Indicating / Operating means

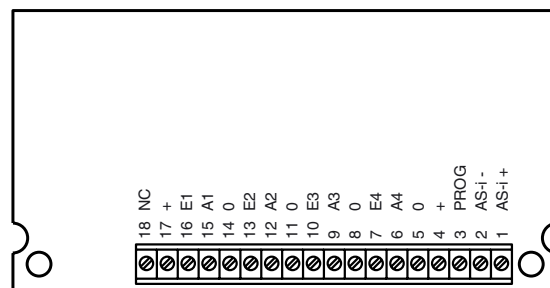

Release date: 2007-11-22 17:25 Date of issue: 2007-12-13 036498_ENG.xml

Technical data**General specifications**

Slave type	Standard slave
------------	----------------

Electrical specifications

Protection class	III
Rated operational voltage	U_e 26.5 ... 31.6 V from AS-Interface
Rated operational current	I_e ≤ 150 mA

Input

Number/Type	2 Inputs for NAMUR sensors
Supply	from AS-Interface
Voltage	8 V
Input current	≤ 8 mA (limited internally)
Switching point	OFF ≤ 1.2 mA ON ≥ 2.1 mA according to DIN EN 60947-5-6

Output

Number/Type	1 Electronic outputs, PNP
Supply	from AS-Interface
Current	max. 100 mA
Voltage	21 ... 31 V

Programming instructions

Profile	S-7.0
IO code	7
ID code	0

Data bits (function via AS-Interface)	input	output
D0	-	OUT1 off
D1	-	OUT1 on
D2	IN1	-
D3	IN2	-

Parameter bits (programmable via AS-i) function

P0	not used
P1	not used
P2	not used
P3	not used

Ambient conditions

Ambient temperature	-25 ... 60 °C (248 ... 333 K)
Storage temperature	-25 ... 85 °C (248 ... 358 K)

Mechanical specifications

Protection degree	IP00 (solder pins), IP20 (completely fitted); according to EN 60529
Connection	Installed printed circuit board grid dimension 2.54 mm