

Basic series

5 mm embeddable

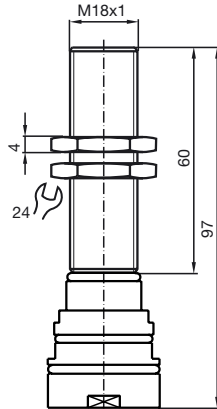

Switching element function	AC	Make function
Rated operating distance s_n	5 mm	
Installation	embeddable	
Assured operating distance s_a	0 ... 4,05 mm	
Reduction factor r_{AI}	0,2	
Reduction factor r_{Cu}	0,15	
Reduction factor r_{V2A}	0,62	
Operating voltage U_B	20 ... 253 V	
Switching frequency f	0 ... 20 Hz	
Hysteresis H	typ. 6 %	
Voltage drop U_d	≤ 8 V	
Momentary current (20 ms, 0.1 Hz)	0 ... 1600 mA	
Operating current I_L	5 ... 200 mA	
Off-state current I_r	0 ... 1,7 mA typ.	
Operating voltage display	LED, green	
Indication of the switching state	LED, yellow	
Standards	EN 60947-5-2	
Ambient temperature	-25 ... 70 °C (248 ... 343 K)	
Connection type	connector 5PIN 15A250VAC	
Housing material	brass, nickel-plated	
Sensing face	PBT	
Protection degree	IP67	

Connection_type:

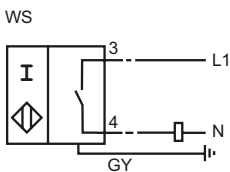

034104_ENG.xml

2003-09-24

www.pepperl-fuchs.com

PEPPERL+FUCHS GmbH