



CE

### Model Number

NCN15-30GM60-Z1

### Features

- Comfort series
- 15 mm non-flush

### Connection

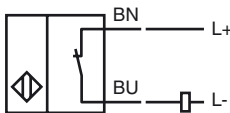

## Dimensions

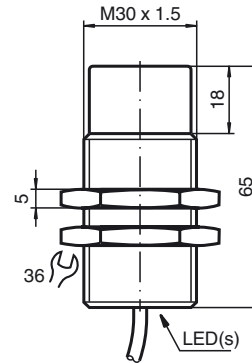

## Technical Data

### General specifications

Switching element function		DC	NC
Rated operating distance	$s_n$	15 mm	
Installation		non-flush	
Output polarity		DC	
Assured operating distance	$s_a$	0 ... 12.15 mm	
Reduction factor $r_{AI}$		0.43	
Reduction factor $r_{Cu}$		0.36	
Reduction factor $r_{304}$		0.7	

### Nominal ratings

Operating voltage	$U_B$	5 ... 60 V
Switching frequency	$f$	0 ... 50 Hz
Hysteresis	$H$	1 ... 15 typ. 5 %
Reverse polarity protected		tolerant
Short-circuit protection		pulsing
Voltage drop	$U_d$	$\leq 5$ V
Operating current	$I_L$	2 ... 100 mA
Off-state current	$I_r$	0 ... 0.9 mA typ. 0.7 mA
Indication of the switching state		LED, yellow
Pre-fault indication		-

### Standard conformity

Standards	IEC / EN 60947-5-2:2004
-----------	-------------------------

### Ambient conditions

Ambient temperature	-25 ... 70 °C (-13 ... 158 °F)
Storage temperature	-40 ... 100 °C (-40 ... 212 °F)

### Mechanical specifications

Core cross-section	0.34 mm <sup>2</sup>
Housing material	Stainless steel
Sensing face	PBT
Protection degree	IP67
Note	discontinued model