



Model Number

NEB12-18GM50-E-V1

Features

- 12 mm quasi-embeddable
- Increased operating distance

Connection

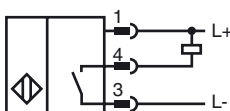

Pinout

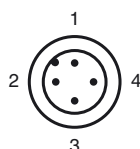

Wire colors in accordance with EN 60947-5-2

1	BN	(brown)
2	WH	(white)
3	BU	(blue)
4	BK	(black)

Accessories

- BF 18**
Mounting flange, 18 mm
- V1-G**
4-pin, M12 female field-attachable connector
- V1-W**
4-pin, M12 female field-attachable connector
- V1-G-2M-PUR**
Cable socket, M12, 4-pin, PUR cable
- V1-W-2M-PUR**
Cable socket, M12, 4-pin, PUR cable

Dimensions

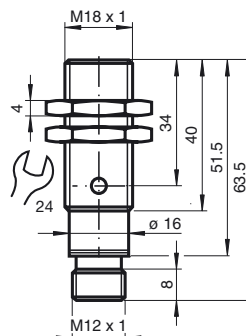

Technical Data

General specifications		
Switching element function		NPN NO
Rated operating distance	s_n	12 mm
Installation		quasi embedd.
Output polarity		DC
Assured operating distance	s_a	0 ... 9.72 mm
Reduction factor r_{AI}		0.26
Reduction factor r_{Cu}		0.2
Reduction factor r_{304}		0.63

Nominal ratings		
Installation conditions		
A		4 mm
B		18 mm
C		36 mm
F		44 mm
Operating voltage	U_B	10 ... 30 V
Switching frequency	f	0 ... 500 Hz
Hysteresis	H	typ. 5%
Reverse polarity protected		reverse polarity protected
Short-circuit protection		pulsing
Voltage drop	U_d	≤ 2 V
Operating current	I_L	0 ... 200 mA
Off-state current	I_r	0 ... 0.1 mA typ. 0.1 μ A at 25 °C
No-load supply current	I_0	≤ 10 mA
Indication of the switching state		LED yellow

Functional safety related parameters		
MTTF _d		283 a
Mission Time (T _M)		20 a
Diagnostic Coverage (DC)		0 %

Ambient conditions		
Ambient temperature		-25 ... 70 °C (-13 ... 158 °F)

Mechanical specifications		
Connection type		Device connector M12 x 1, 4-pin
Housing material		chromium plated brass
Sensing face		PBT
Protection degree		IP67

Compliance with standards and directives		
Standard conformity		
Standards		EN 60947-5-2:2007 IEC 60947-5-2:2007 Non-standard connector assignment

Approvals and certificates		
UL approval		cULus Listed, General Purpose
CSA approval		cCSAus Listed, General Purpose
CCC approval		Products with a maximum operating voltage of ≤ 36 V do not bear a CCC marking because they do not require approval.

Installation conditions

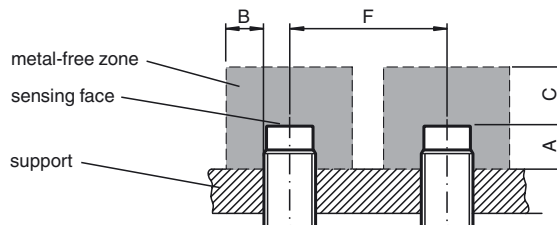

Release date: 2012-04-04 11:33 Date of issue: 2012-04-04 029396_eng.xml