



## Model Number

NJ6-F-A

## Features

- Comfort series
- 6 mm embeddable
- 4-wire DC

## Connection

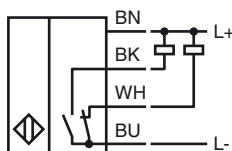

## Dimensions

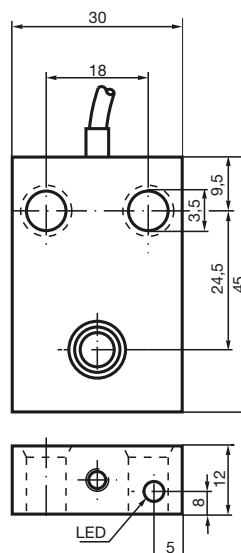

## Technical Data

### General specifications

Switching element function		NPN	NO/NC
Rated operating distance	$s_n$	6 mm	
Installation		embeddable	
Output polarity		DC	
Assured operating distance	$s_a$	0 ... 4.8 mm	
Reduction factor $r_{Al}$		0.22	
Reduction factor $r_{Cu}$		0.2	
Reduction factor $r_{304}$		0.7	

### Nominal ratings

Operating voltage	$U_B$	10 ... 60 V DC	
Switching frequency	$f$	0 ... 500 Hz	
Hysteresis	H	0 ... 0.3 typ. 0.1 %	
Reverse polarity protected		reverse polarity protected	
Short-circuit protection		pulsing	
Voltage drop	$U_d$	$\leq 3$ V	
Operating current	$I_L$	0 ... 200 mA	
No-load supply current	$I_0$	$\leq 20$ mA	
Indication of the switching state		LED, yellow	

### Functional safety related parameters

MTTF <sub>d</sub>	690 a
Mission Time ( $T_M$ )	20 a
Diagnostic Coverage (DC)	0 %

### Ambient conditions

Ambient temperature	-25 ... 70 °C (-13 ... 158 °F)
---------------------	--------------------------------

### Mechanical specifications

Connection type	cable PUR , 2 m
Core cross-section	0.34 mm <sup>2</sup>
Housing material	PBT
Sensing face	PBT
Protection degree	IP67

### Compliance with standards and directives

Standard conformity	
Standards	EN 60947-5-2:2007 IEC 60947-5-2:2007

### Approvals and certificates

UL approval	cULus Listed, General Purpose
CSA approval	cCSAus Listed, General Purpose
CCC approval	Certified by China Compulsory Certification (CCC)