



Model Number

NJ10-30GK50-E2-Y20966

Features

- 3-wire DC
- Sensing range 10 mm

Connection

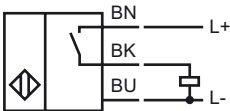

Dimensions

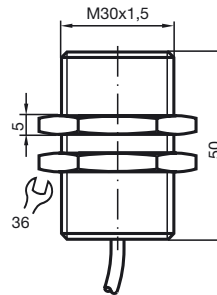

Technical Data

General specifications

Switching element function		PNP	NO
Rated operating distance	s_n	10 mm	
Installation		embeddable	
Output polarity		DC	
Assured operating distance	s_a	0 ... 8.1 mm	
Reduction factor r_{Al}		0.22	
Reduction factor r_{Cu}		0.19	
Reduction factor r_{V2A}		0.66	
Reduction factor r_{Brass}		0.33	

Nominal ratings

Operating voltage	U_B	10 ... 60 V
Switching frequency	f	0 ... 800 Hz
Hysteresis	H	1 ... 15 typ. 5 %
Reverse polarity protected		reverse polarity protected
Short-circuit protection		pulsing
Voltage drop	U_d	≤ 2.8 V
Operating current	I_L	0 ... 400 mA
Off-state current	I_r	0 ... 0.5 mA typ. 0.01 mA
No-load supply current	I_0	≤ 9 mA
Indication of the switching state		-

Ambient conditions

Ambient temperature	-40 ... 70 °C (-40 ... 158 °F)
---------------------	--------------------------------

Mechanical specifications

Connection type	cable silicon , 2.9 m
Core cross-section	0.75 mm ²
Housing material	PBT
Sensing face	PBT
Protection degree	IP68
Note	stainless steel nuts included

Compliance with standards and directives

Standard conformity	
Standards	EN 60947-5-2:2007 IEC 60947-5-2:2007

Approvals and certificates

UL approval	cULus Listed, General Purpose
CCC approval	Certified by China Compulsory Certification (CCC)