

CE

**Model Number**

NJ10-30GK50-E

**Features**

- Comfort series
- 10 mm flush

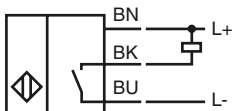
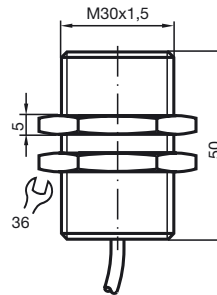
**Connection****Dimensions****Technical Data****General specifications**

|                              |       |              |    |
|------------------------------|-------|--------------|----|
| Switching element function   |       | NPN          | NO |
| Rated operating distance     | $s_n$ | 10 mm        |    |
| Installation                 |       | flush        |    |
| Output polarity              |       | DC           |    |
| Assured operating distance   | $s_a$ | 0 ... 8.1 mm |    |
| Reduction factor $r_{Al}$    |       | 0.22         |    |
| Reduction factor $r_{Cu}$    |       | 0.19         |    |
| Reduction factor $r_{304}$   |       | 0.66         |    |
| Reduction factor $r_{Brass}$ |       | 0.33         |    |

**Nominal ratings**

|                                   |       |                            |
|-----------------------------------|-------|----------------------------|
| Operating voltage                 | $U_B$ | 10 ... 60 V                |
| Switching frequency               | $f$   | 0 ... 800 Hz               |
| Hysteresis                        | $H$   | 1 ... 15 typ. 5 %          |
| Reverse polarity protected        |       | reverse polarity protected |
| Short-circuit protection          |       | pulsing                    |
| Voltage drop                      | $U_d$ | $\leq 2.8$ V               |
| Operating current                 | $I_L$ | 0 ... 200 mA               |
| Off-state current                 | $I_r$ | 0 ... 0.5 mA typ. 0.01 mA  |
| No-load supply current            | $I_0$ | $\leq 9$ mA                |
| Indication of the switching state |       | -                          |

**Standard conformity**

|           |                         |
|-----------|-------------------------|
| Standards | IEC / EN 60947-5-2:2004 |
|-----------|-------------------------|

**Ambient conditions**

|                     |                                |
|---------------------|--------------------------------|
| Ambient temperature | -25 ... 70 °C (-13 ... 158 °F) |
| Storage temperature | -25 ... 85 °C (-13 ... 185 °F) |

**Mechanical specifications**

|                    |                      |
|--------------------|----------------------|
| Core cross-section | 0.75 mm <sup>2</sup> |
| Housing material   | PBT                  |
| Sensing face       | PBT                  |
| Protection degree  | IP68                 |