



Model Number

NJ2-6,5-40-E2

Features

- Comfort series
- 2 mm not embeddable

Connection

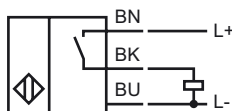

Accessories

BF 6,5
Mounting flange

Dimensions

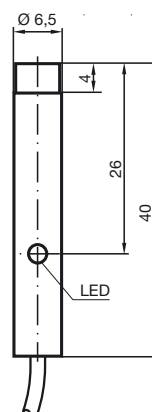

Technical Data

General specifications

Switching element function	PNP	Make function
Rated operating distance	s_n	2 mm
Installation		not embeddable
Output polarity		DC
Assured operating distance	s_a	0 ... 1.62 mm
Reduction factor r_{Al}		0.4
Reduction factor r_{Cu}		0.35
Reduction factor r_{V2A}		0.7

Nominal ratings

Operating voltage	U_B	10 ... 60 V
Switching frequency	f	0 ... 400 Hz
Reverse polarity protection		protected against reverse polarity
Short-circuit protection		pulsing
Voltage drop	U_d	≤ 3 V
Operating current	I_L	0 ... 100 mA
No-load supply current	I_0	≤ 15 mA
Indication of the switching state		LED, yellow

Ambient conditions

Ambient temperature		-25 ... 70 °C (248 ... 343 K)
---------------------	--	-------------------------------

Mechanical specifications

Connection type		2 m, PUR cable
Core cross-section		0.14 mm ²
Housing material		Stainless steel
Sensing face		PBT
Protection degree		IP67

Compliance with standards and directives

Standard conformity		
Standards		EN 60947-5-2:2007 IEC 60947-5-2:2007

Approvals and certificates

CCC approval		Certified by China Compulsory Certification (CCC)
--------------	--	---