



Model Number

CJ10-30GM-N-Z10

Features

- For use in Zone 10
- 10 mm not embeddable
- The switching distance can be set over a wide range with the potentiometer

Connection

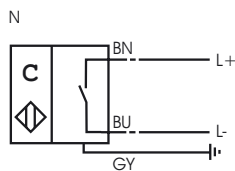

The ever present danger of explosion in Zone 10 areas places great demands on the application of safety technology, of which proximity sensors are an important link in the safety chain.

The two capacitive sensors CJ6-30GM-E2-Z10 and CJ10-30GM-N-Z10 are approved for use in Zone 10 and have BVS approval. They are therefore suitable for use in silos and conveying plants where there is a risk of dust explosions. It may also be used, together with the mounting parts supplied, in the isolating area between Zones 10 and 11

Sensor CJ10-30GM-N-Z10 may be completely installed in the explosion hazardous area, Zone 10. It must be controlled by intrinsically safe control equipment. For this purpose, Pepperl+Fuchs produce an extensive range of control equipment in the E-systems and the K-series, which enable safe and multi-purpose signal evaluation.

The sensor is encapsulated cavity free in a sturdy stainless steel housing, and is subjected to stringent individual testing, including a high voltage test. A test plate certifies that individual testing has been completed.

The mounting of sensors in Zone 10 is subject to regulations and conditions for installation which must be observed.

When used in the potentially explosive area Zone 10, the earth lead GY must be included in the voltage equalisation.

Dimensions

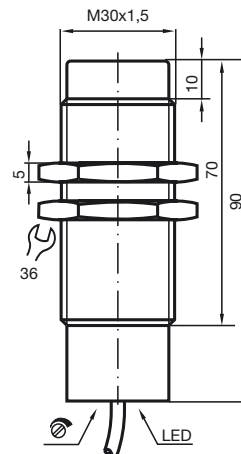

Technical Data

General specifications

Switching element function	NAMUR NC
Rated operating distance	s_n 10 mm
Installation	not embeddable
Output polarity	NAMUR
Assured operating distance	s_a 0 ... 6 mm

Nominal ratings

Nominal voltage	U_o 8 V
Operating voltage	U_B 7 ... 12 V
Switching frequency	f 0 ... 10 Hz
Reverse polarity protection	protected against reverse polarity
Current consumption	
Measuring plate not detected	≤ 1 mA
Measuring plate detected	≥ 2.4 mA
Indication of the switching state	LED, red

Standard conformity

EMC in accordance with	IEC / EN 60947-5-2:1999
Standards	DIN EN 60947-5-6 (NAMUR)

Ambient conditions

Ambient temperature	-25 ... 70 °C (248 ... 343 K)
---------------------	-------------------------------

Mechanical specifications

Connection type	2 m, PVC cable
Core cross-section	0.75 mm ²
Housing material	Stainless steel
Sensing face	PBT
Protection degree	IP65

ATEX

Data for Ex areas

Effective internal inductivity	C_i	$\leq 140 \text{ nF}$
Effective internal inductance	L_i	$\leq 10 \text{ }\mu\text{H}$

Release date: 2006-12-14 09:59 Date of issue: 2008-06-30 011761_ENG.xml