



Model Number

CJ10-30GM-E3

Features

- Comfort series
- 10 mm non-flush

Connection

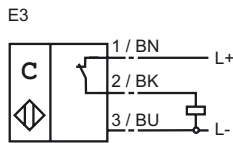

Dimensions

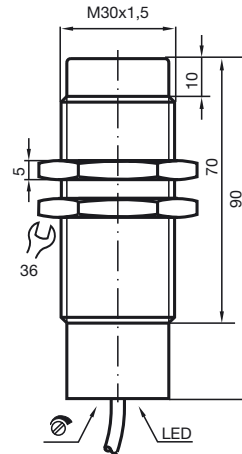

Technical Data

General specifications

Switching element function	PNP	NC
Rated operating distance	s_n	10 mm
Installation	non-flush	
Output polarity	DC	
Assured operating distance	s_a	0 ... 10 mm

Nominal ratings

Installation conditions		
A		0 mm
B		0 mm
C		30 mm
F		50 mm
Operating voltage	U_B	10 ... 60 V
Switching frequency	f	0 ... 10 Hz
Hysteresis	H	0.1 ... 10 typ. 4 %
Reverse polarity protection	reverse polarity protected	
Short-circuit protection	pulsing	
Voltage drop	U_d	≤ 2.8 V
Operating current	I_L	0 ... 200 mA
Lowest operating current	I_m	0 mA
Off-state current	I_r	0 ... 0.5 mA typ. 0.01 mA
No-load supply current	I_0	≤ 20 mA
Time delay before availability	t_v	≤ 50 ms
Indication of the switching state	LED, yellow	

Standard conformity

EMC in accordance with	IEC / EN 60947-5-2:1999
------------------------	-------------------------

Ambient conditions

Ambient temperature	-25 ... 70 °C (-13 ... 158 °F)
Storage temperature	-40 ... 85 °C (-40 ... 185 °F)

Mechanical specifications

Core cross-section	0.75 mm ²
Housing material	Stainless steel
Sensing face	PBT
Protection degree	IP67

Installation conditions

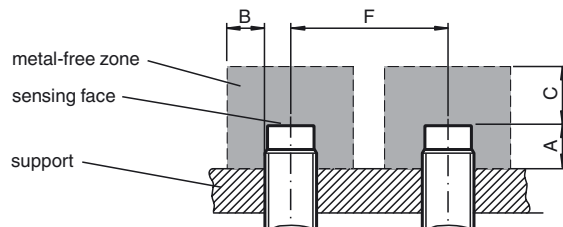

Release date: 2012-08-28 15:00 Date of issue: 2012-08-28 000019_eng.xml