



Product change notice

PCN N°	028
Customer	All customers
Items affected	MCO801-14io1 to MCO801-18io1, MCO741-22io1 and MDO1201-14N1 to MDO1201-22N1
Description of change	<p>From immediate effect IXYS UK Westcode has updated the packaging for MCO801-14io1 to MCO801-18io1, MCO741-22io1 and MDO1201-14N1 to MDO1201-22N1 modules.</p> <p>The reasons for the change are to simplify and unify the packaging and to eliminate possible transit damage of the power terminals.</p> <p>A visual comparison of the old and new outer packaging is shown in figures 1 to 4. The dimensions and key differences are detailed in the pictures. The number of modules per inner box has not changed (2pcs per box) but the number of modules per outer box has increased from 4pcs to 6pcs.</p> <p>The changes will ensure that the power terminals will be protected during transit and eliminate the possibility of terminal distortion.</p>
Reason for change	To simplify and unify the packaging and to eliminate possible transit damage of the power terminals.
Identification	The new outer box is a different dimension to the old outer box.
Schedule of change	Immediate
Influence on reliability	None
Internal reference	None

In case of any question, please contact

Initiator	Job title/ function	Date	e-mail address
IXYS UK Westcode Ltd Langley Park Way, Langley Park Chippenham, Wiltshire SN15 1GE UK Tel No: +44 (0) 1249 455581	Graham Hutchinson, Quality Manager	30 th August 2013	g.hutchinson@ixys.net

Customer response

(Please fill in and return by email within four weeks)

For further questions/ information please comment	Company	
	Name and position	
	Phone	
	e-mail address	

Note: Written response or written acknowledgement with statement of approval must be received within thirty (30) days of the date of this PCN or IXYS UK will consider this change approved

Comments

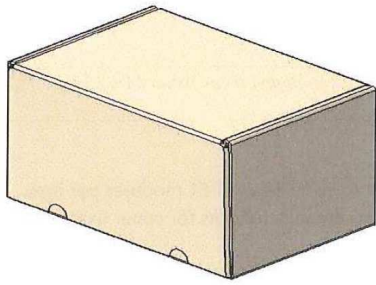

Figure 1 : Old outer packaging, capacity of box-4pcs, dimensions - 308x239x218mm, inner box dimensions - 330x219x102mm

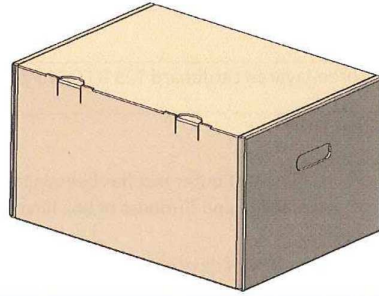

Figure 2 : New outer packaging, capacity of box-6pcs, dimensions - 390x237x255mm, inner box dimensions - 350x227x75mm

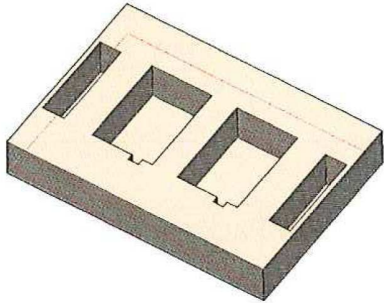

Figure 3 : Old internal packaging, modules are placed on the baseplate, there are three layers of cardboard

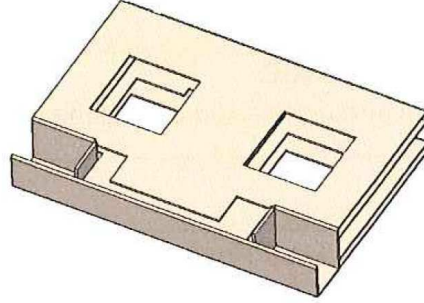

Figure 4 : New internal packaging, modules are placed on the side, there are five layers of cardboard