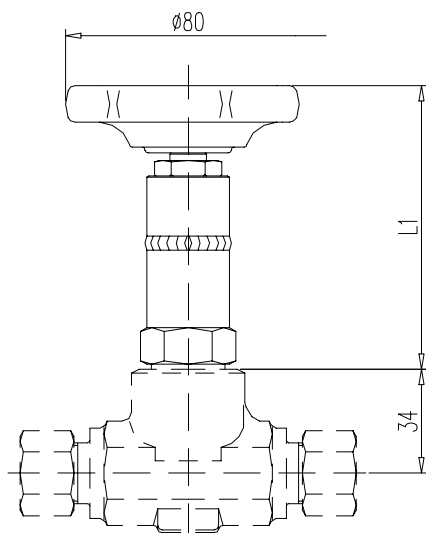
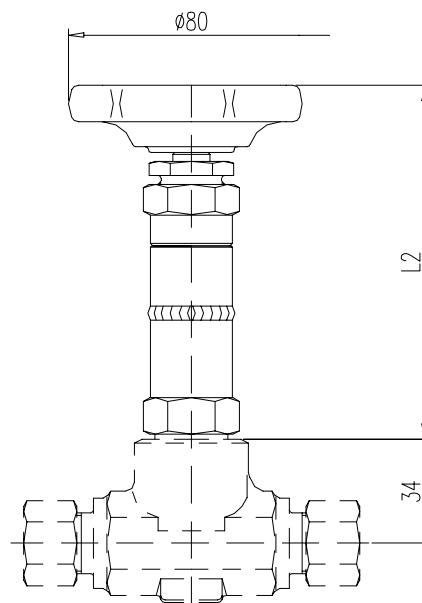
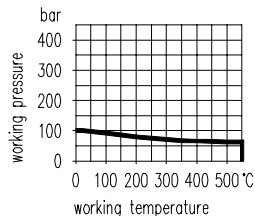
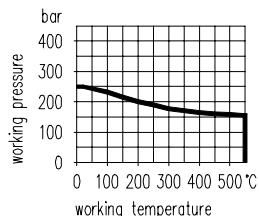

without safety packing (P1 to P2)

with safety packing (P5 to P6)

Pressure / temperature ratings based on head unit:
PN 100

PN 250

| Bellow type | Dimensions [mm] | | Code designation for head unit | | | |
|-------------|-----------------|-----|--------------------------------|-------|---------------------|-------|
| | L1 | L2 | without safety packing | | with safety packing | |
| | | | DN 5 | DN 8 | DN 5 | DN 8 |
| PN 100 | 93 | 116 | F5 P1 | F8 P1 | F5 P5 | F8 P5 |
| PN 250 | 123 | 146 | F5 P2 | F8 P2 | F5 P6 | F8 P6 |

| Head unit components | DIN - Material Number |
|----------------------|-----------------------|
| Valve stem | 1.4571 |
| Needle tip | Stellite 6 |
| Bellow | 1.4571 |
| Bonnet | 1.4571 |
| Safety packing | graphite |

Explanation of the code designations

| Bellow execution | DN | Bellow type |
|------------------|---------|-------------|
| F | e. g. 8 | e. g. P1 |

The letter 'F' replaces the 'S' or 'N' of the standard type numbers and the bellow type is added.

For example: S350.05.130.09 »»» F350.05.130.09P1
S360.03.204 »»» F360.03.204.00P5

Valves for oxygen service on request.

The bellows are submitted to a 100% Helium leak test.
Leak rate: 10^{-8} mbar l/s.