

without safety packing (P1 to P2)

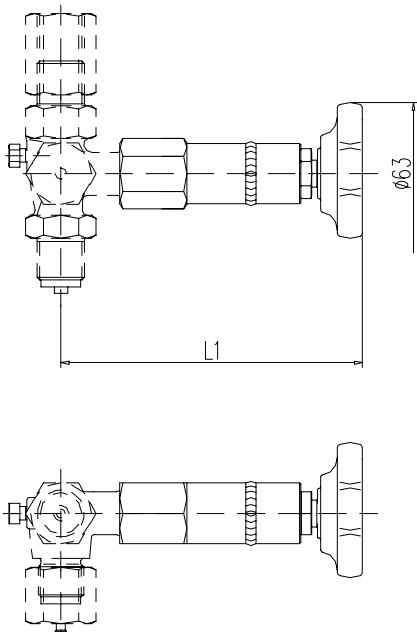

with safety packing (P5 to P6)

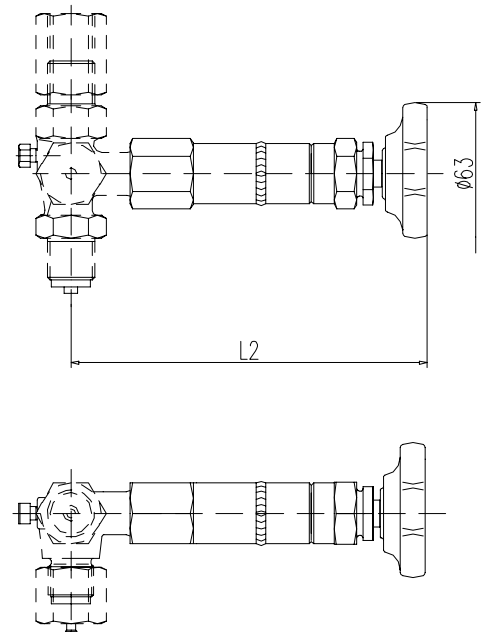

Pressure / temperature ratings based on head unit:

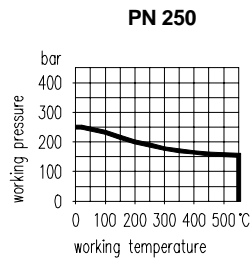
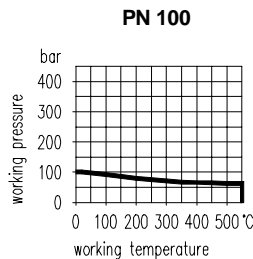

Bellow type	Dimensions [mm]		Code designation for head unit	
	L1	L2	without safety packing	with safety packing
PN 100	134	157	DN 4	DN 4
PN 250	163	186	DN 4	DN 4

Head unit components	DIN - Material Number
Valve stem	1.4571
Needle tip	Stellite 6
Bellow	1.4571
Bonnet	1.4571
Safety packing	graphite

Explanation of the code designation		
Bellow execution	DN	Bellow type
F	4	e. g. P2

The letter 'F' replaces the 'S' or 'N' of the standard type numbers and the bellow type is added.

For example: S004.17.200 »»» F004.17.200.00P1
S004.16.220 »»» F004.16.220.00P2

Valves for oxygen service on request.

The bellows are submitted to a 100% Helium leak test.
Leak rate: 10⁻⁸ mbar l/s.