

Instrumentation Products

E Series Valves and Manifolds



Introduction	page 2
Contents	page 3
General Features	page 4
Valve Head Unit Options	page 5-11
Connections	page 12-13
Hand Valves	page 14-15
Gauge Valves	page 16-17
Multiport Gauge Valves	page 18-19
Block & Bleed Manifolds	page 20-21
L, Y & W-Shaped Manifolds	page 22-24
Remote Mounted Manifolds	page 25-27
Direct Mount Manifolds	page 28-36
5 Valve Manifolds with Natural Gas Metering Pattern	page 37-38
Enclosure Manifolds	page 39-41
Differential Pressure Gauge Manifolds	page 42-43
Accessories	page 44-49
Check Valves	page 50
Complementary Products	page 51

General Features

Body Material Options

Material Group	AS Material Designation	Material No.	Short Name	Equivalent UNS-No.	Material Grade acc. to ASTM	E Series Needle Valves and Manifolds
Carbon Steel	Carbon Steel	1.0460	P250GH			Optional
	LF2				LF2	Optional
Austenitic Stainless Steel	Stainless Steel	1.4571	X6CrNiMoTi17-12-2	S 31635	316Ti	Optional
	316 quadruple certified*	1.4401	X5CrNiMo17-12-2	S 31600	316	Standard
		1.4404	X2CrNiMo17-12-2	S 31603	316L	Standard
	6Mo	1.4547	X 1CrNiMoCuN20-18-7	S 31254		Standard
Austenitic-Ferritic Stainless Steel	Duplex	1.4462	X2CrNiMoN22-5-3	S 31803	F51	Standard
	Superduplex	1.4410	X2CrNiMoN25.7.4	S 32750	F53	Standard
		1.4501	X2CrNiMoCuWN25.7.4	S 32760	F55	Standard
Heat Resistant Steel		1.5415	16Mo3			Alternative**
		1.7335	13CrMo 4-5		F12	Alternative**
		1.7383	10CrMo9-10		F22	Alternative**
		1.4903	X 10 CrMoVNb 9-1		F91	Alternative**
Nickel Based Alloys	Alloy 400	2.4360	NiCu30Fe	N 04400		Standard
	Alloy C-276	2.4819	NiMo 16 Cr 15 W	N 10276		Standard
	Alloy 625	2.4856	NiCr22Mo9Nb	N 06625		Standard
	Alloy 825	2.4858	NiCr21Mo	N 08825		Optional
Titanium	Titanium Grade 2	3.7035	Ti-II	R 50400		Standard

* Quadruple Certified means 316 / 316L / 1.4401 / 1.4404

** Alternative Valve Type: Please contact factory

Standard Features

- Bore Size 5 mm
- Manifolds are not supplied with plugs unless specified.
- Anti-Tamper Head Unit Options see Page 11.

Needle Seal:

PTFE and Graphite Packings are available for all valve types. Alternatively O-Ring stem seal and Bellows Sealed Head Units – see Page 6–10.

Sour Gas Service:

Wetted Parts according to a.m. material list are supplied as standard according to NACE MR0175/MR0103 and ISO 15156 (latest issue) – except Titanium Grade 2.

Pressure Test:

A shell test and a seat leakage test are performed at 1.5 times the maximum working pressure acc. to EN 12266-1 – P10, P11 and P12 respectively MSS-SP61 at every standard AS-Schneider E Series Needle Valve / Manifold → 100% Pressure Tested!

Certification:

Inspection certificate 3.1 acc. to EN 10 204 for valve body material and pressure test available on request.

Optional Features

- Soft Seated Needle Valves: Bore Size 6.35 mm
- Bore Size 10 mm

Fugitive Emission Application:

For Fugitive Emission Applications AS-Schneider is providing bellows sealed valves with safety packing. Choice of Pressure class PN 100 or PN 250. The bellows are submitted to a 100% Helium leak test. The leak rate is 10^{-8} mbar l/s. Optional available are TA-Luft and ISO 15848 solutions. For more details see Pages 9 and 10.

AS-Schneider offers a BAM tested option cleaned and lubricated for Oxygen Service:

PTFE Packing – Max. Operating Pressure 420 bar (6,092 psi)
 Pressure-Temperature Rating:
 Max. 420 bar (6.092 psi) @ 60°C (140°F)
 Max. 200°C (392°F) @ 90 bar (1.305 psi)

Not every Valve Type is available for Oxygen Service!

If you don't find your options in this catalogue, please contact the factory.

Standard Bonnet Design

T Handle

Operating options are Anti-Tamper features or a Stainless Steel Handwheel.

Valve Stem

Stem with cold rolled threads for high strength and smooth operation.

Needle Seal

Standard: PTFE or Graphite Packing
Options: O-Ring or Bellows Sealed

Needle

Non-rotating Needle for smooth operation and minimum wear of sealing elements.

Back Seat

Metal to Metal secondary needle seal and therefore the needle is anti-blowout / non-removable – for your safety.

Needle Tip

Choices of Needle Tip Materials such as Stellite, and Soft Tips like PCTFE and POM.

Valve Seat

Metal seated (integral type) and Soft seated → See Page 7 and Catalogue AS-4302.



Colour Coded Dust Cap

For operating thread protection:

Isolate	Blue
Vent / Test	Red
Equalize	Green

Colour Coded Options

Following options are also colour coded below dust cap:

Oxygen Service	White
Graphite Packing	Black
FKM O-ring Stem Seal with PCTFE Soft Tip	Orange
TA-Luft Option	Magenta

Lock Pin

Eliminates unauthorized removal of the bonnet assembly.

Bonnet

Metal to Metal Seal to Valve Body.

Traceability of Materials

All AS-Schneider E Series Valves and Manifolds have material traceability. A unique code is stamped on all valve bodies linking them with their material and chemical analysis certificates.

Flow Data

Needle Valves Standard Head Unit – Bore Size 5 mm

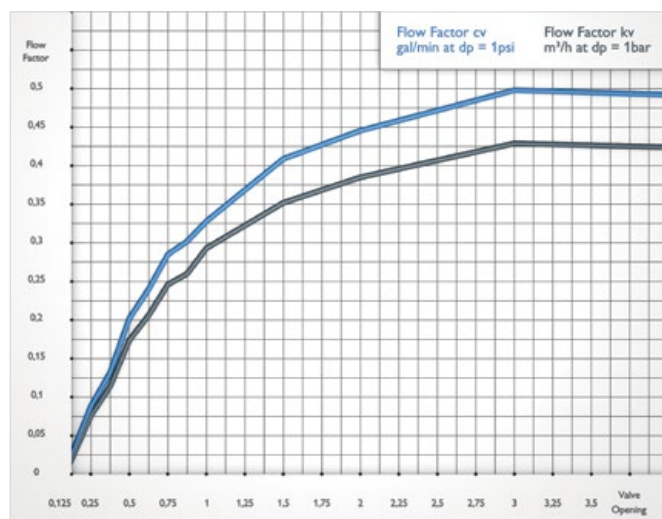

Standard Valve Head Units

Standard Needle Valves

Screwed Bonnet – Stem Seal: Packing

Features

- Integral Valve Seat – Metal to Metal Seated
- Soft Tip PCTFE or POM optional
- Non-rotating Needle
- External Stem Thread – Packing below stem threads. Stem Threads are protected from process media (non-wetted), helps to prevent stems from galling.
- Stem with cold rolled threads
- Blow-out proof Needle
- Back Seat – Metal to metal secondary needle seal
- Lock Pin – Eliminates unauthorized removal of the bonnet
- Colour Coded Dust Cap for operating thread protection
- Standard Packing in PTFE and Graphite available
- Carbon filled PTFE Packing - TA-Luft option
- Max. Operating Pressure 420 bar (6,092 psi) - 689 (10,000 psi) optional
- Panel Mount Option available
- Anti-Tamper Valve Head Options available
- All non-wetted parts in 316 stainless steel

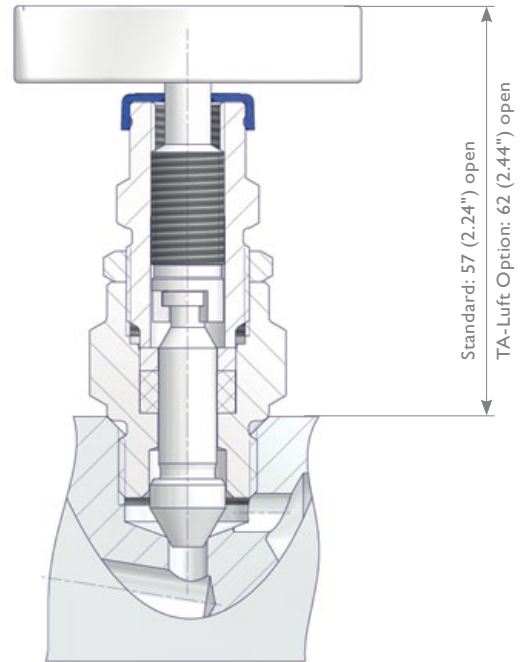

Colour Coded Options

Graphite Packing



Oxygen Service



TA-Luft Option

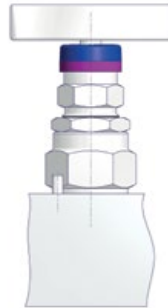

Panel Mount Option

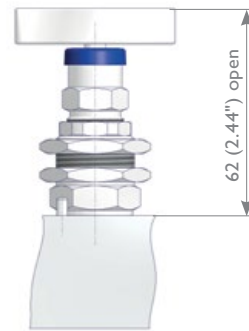

Components	Stainless Steel		Exotic Alloys						
	Material / Material No.								
Body									
Bonnet	316 / 316L	Alloy 400	Alloy C-276	Duplex	UNS S32750	UNS S32760	Alloy 625	6Mo	Titanium Gr. 2
Needle									
Valve Stem	316 / 316L								
Gland	316								
Packing	PTFE or Graphite								
Stem Nut	316								
Lock Nut	316								
Set Screw	316								
T Handle	316								
Lock Pin	A4 (316)								

Wetted components listed in **bold**.

Soft Seated Needle Valves → See Catalogue AS-4302

Screwed Bonnet – Soft Seated
Bore Size 6.35 mm (1/4")

Features

- Soft Seated – Roddable Design
- Non-rotating Needle
- External Stem Thread – Packing below stem threads. Stem Threads are protected from process media (non-wetted), helps to prevent stems from galling.
- Stem with cold rolled threads
- Blow-out proof Needle
- Back Seat – Metal to metal secondary needle seal
- Lock Pin – Eliminates unauthorized removal of the bonnet
- Colour Coded Dust Cap for operating thread protection
- Max. Operating Pressure 420 bar (6,092 psi)
- Panel Mount Option not available
- Anti-Tamper Valve Head Options available
- Oxygen Service not available
- Packing Carbon filled PTFE - TA-Luft
- Soft Seat ETFE and PEEK
- All non-wetted parts in 316 stainless steel

Soft Seated Needle Valves and Manifolds see Catalogue AS-4302.

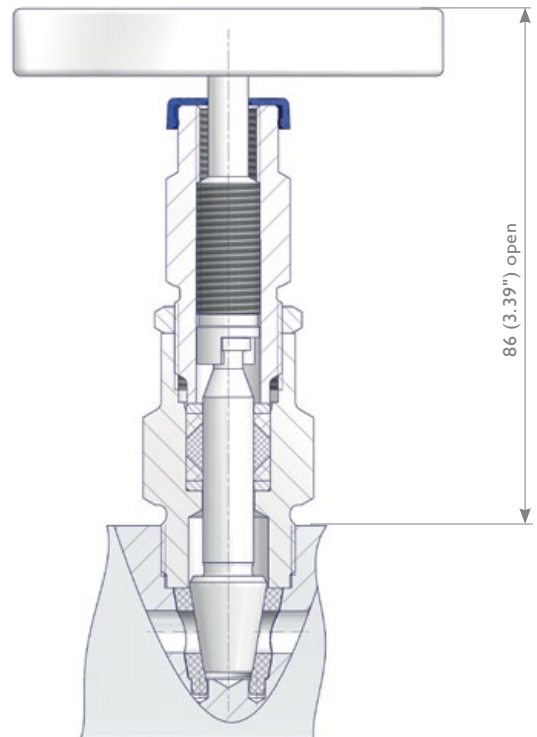

Needle Valves with O-Ring Stem Seal

Screwed Bonnet – O-Ring Stem Seal

Features

- Integral Valve Seat
- Non-rotating Needle
- External Stem Thread – Packing below stem threads. Stem Threads are protected from process media (non-wetted), helps to prevent stems from galling.
- Stem with cold rolled threads
- Blow-out proof Needle
- Back Seat – Metal to metal secondary needle seal
- Lock Pin – Eliminates unauthorized removal of the bonnet
- Colour Coded Dust Cap for operating thread protection
- O-Ring FKM, optional EPDM
- Soft Tip PCTFE or POM
- Max. Operating Pressure 420 bar (6,092 psi)
- Panel Mount Option not available
- Anti-Tamper Valve Head Options available
- All non-wetted parts in 316 stainless steel

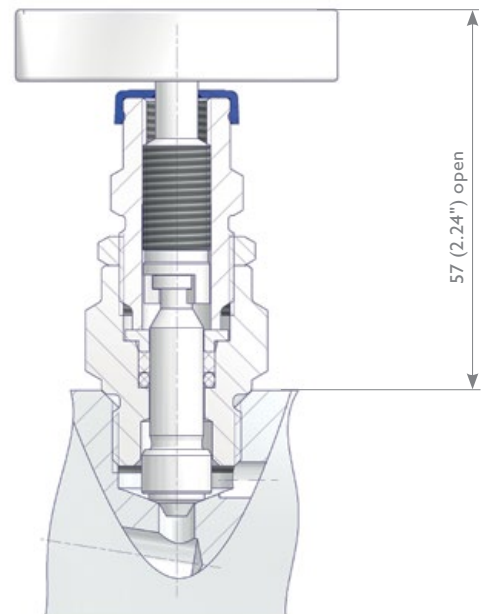

Colour Coded Option
FKM O-Ring Stem Seal
with PCTFE Soft Tip

Standard Valve Head Units

Needle Valves with OS&Y Bolted Bonnet

OS&Y Bolted Bonnet – Standard Packing

Features

- Integral Valve Seat – Metal to Metal Seated
- Non-rotating Needle
- External Stem Thread – Packing below stem threads. Stem Threads are protected from process media (non-wetted), helps to prevent stems from galling.
- Stem with cold rolled threads
- Blow-out proof Needle
- Spring Washers for compensation of thermal expansion
- Back Seat – Metal to metal secondary needle seal
- Colour Coded Dust Cap for operating thread protection
- Max. Operating Pressure 420 bar (6,092 psi)
- Anti-Tamper Valve Head Options available
- PTFE or Graphite Packing
- Bonnet Seal Ring: Graphite
- Fire Safe approved to ISO 10497 and API 607 (not for PTFE packing)
- All non-wetted parts in 316 stainless steel

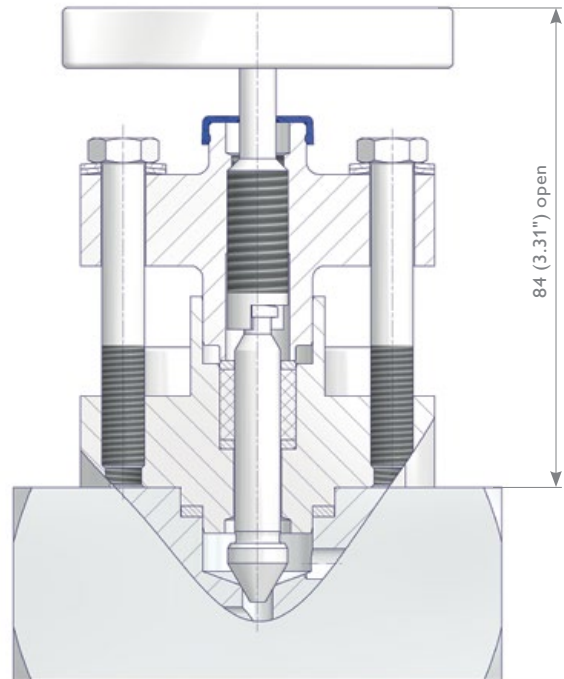

Pressure-Temperature Rating

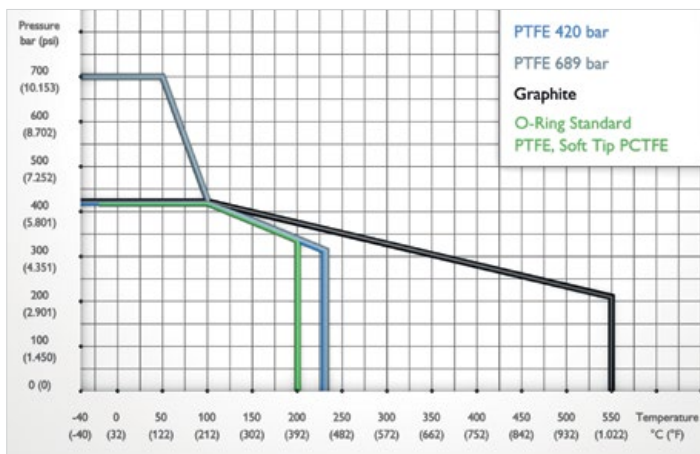

⚠ Packing adjustment may be required during the service life of the valves.

⚠ Valves that have not been cycled for a period of time may have a higher initial actuation torque.

Valve Head Units for Fugitive Emission Applications

Needle Valves acc. to ISO 15848

Screwed Bonnet – Type 1 O-Ring Stem Seal + Graphite Packing
Type 3 PTFE Packing

Features

- Integral Valve Seat – Metal to Metal Seated
- Non-rotating Needle
- External Stem Thread – Packing below stem threads. Stem Threads are protected from process media (non-wetted), helps to prevent stems from galling.
- Stem with cold rolled threads
- Back Seat – Metal to metal secondary needle seal
- Colour Coded Dust Cap for operating thread protection
- Max. Operating Pressure 420 bar (6,092 psi)
- Anti-Tamper Valve Head Options available
- FKM O-Ring Needle Seal – RGD (Rapid Gas Decompression) resistant
- PTFE or Graphite Packing
- All non-wetted parts in 316 stainless steel
- Types also comply with the requirements of TA-Luft 2002

ISO FE Performance Data

- ISO FE Type 1:
Class A 1,500 cycles / -29°C to 40°C
(-20°F to 104°F)
Class A 500 cycles / -29°C to 200°C
(-20°F to 392°F)
Class B 1,500 cycles / -29°C to 200°C
(-20°F to 392°F)
- ISO FE Type 3:
Class B 1,500 cycles / -29°C to 200°C
(-20°F to 392°F)

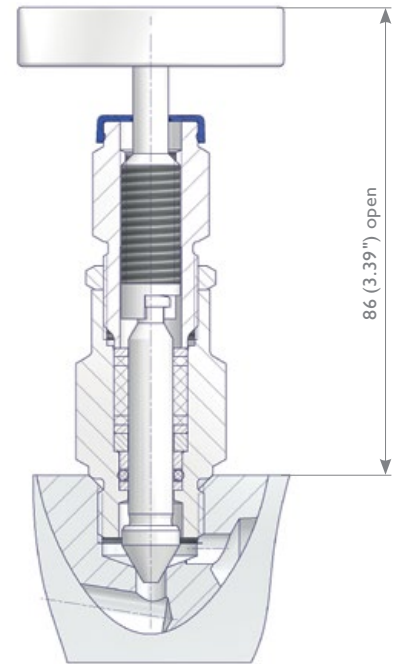

OS&Y Needle Valves acc. to ISO 15848

OS&Y Bolted Bonnet – Type 1 O-Ring Stem Seal + Graphite Packing
Type 3 PTFE Packing

Features

- Integral Valve Seat – Metal to Metal Seated
- Non-rotating Needle
- External Stem Thread – Packing below stem threads. Stem Threads are protected from process media (non-wetted), helps to prevent stems from galling.
- Stem with cold rolled threads
- Blow-out proof Needle
- Spring Washers for compensation of thermal expansion
- Back Seat – Metal to metal secondary stem seal
- Colour Coded Dust Cap for operating thread protection
- Max. Operating Pressure 420 bar (6,092 psi)
- Anti-Tamper Valve Head Options available
- FKM O-Ring Stem Seal – RGD (Rapid Gas Decompression) resistant
- PTFE or Graphite Packing
- Bonnet Seal Ring: Graphite
- Fire Safe approved to ISO 10497 and API 607 (not for PTFE packing)
- All non-wetted parts in 316 stainless steel
- Types also comply with the requirements of TA-Luft 2002

ISO FE Performance Data

- Class A 2,500 cycles / -29°C to 40°C
(-20°F to 104°F)
Class A 500 cycles / -29°C to 200°C
(-20°F to 392°F)
Class B 2,500 cycles / -29°C to 200°C
(-20°F to 392°F)
- ISO FE Type 3:
Class B 2,500 cycles / -29°C to 200°C
(-20°F to 392°F)

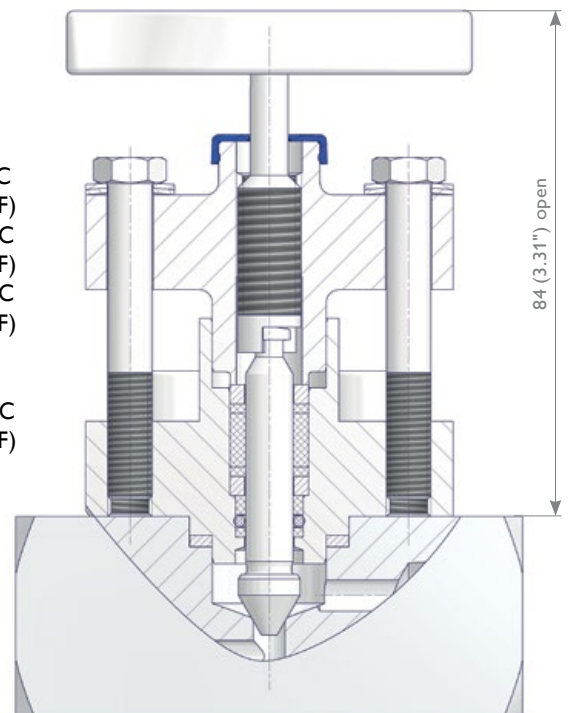

Valve Head Units for Fugitive Emission Applications

Bellows Sealed Head Units

Screwed Bonnet – PN 100 and Graphite Safety Packing
PN 250 and Graphite Safety Packing

Features

- Integral Valve Seat – Metal to Metal Seated
- Non-rotating Stem
- Bellows sealed – PN 100 and PN 250 incl. Graphite Safety Packing
- Stem with cold rolled threads
- Stellite Needle Tip as standard
- Bellows are submitted to a 100% Helium leak test
- Leak rate: 10^{-8} mbar l/s
- Valves for Oxygen Service on request

Bellows Sealed Head Units are mainly used for applications requiring the highest tightness class – such as toxic or vacuum service.

- ⚠ **Packing adjustment may be required during the service life of the valves.**
- ⚠ **Valves that have not been cycled for a period of time may have a higher initial actuation torque.**
- ⚠ **When delivered ex factory, the safety packing of the bellows sealed valve is not fully tightened. In the event of a bellows failure the safety packing must be tightened in order to avoid fluid leakage.**

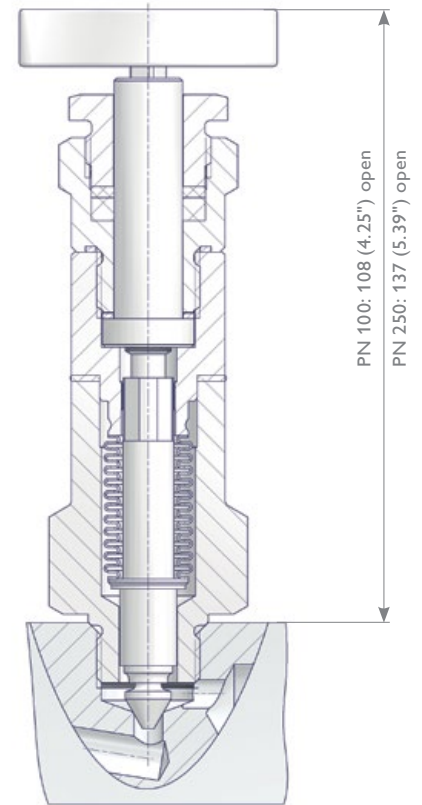

Pressure-Temperature Rating

ISO FE Type 1 FKM O-Ring and Graphite Packing
ISO FE Type 3 PTFE Packing

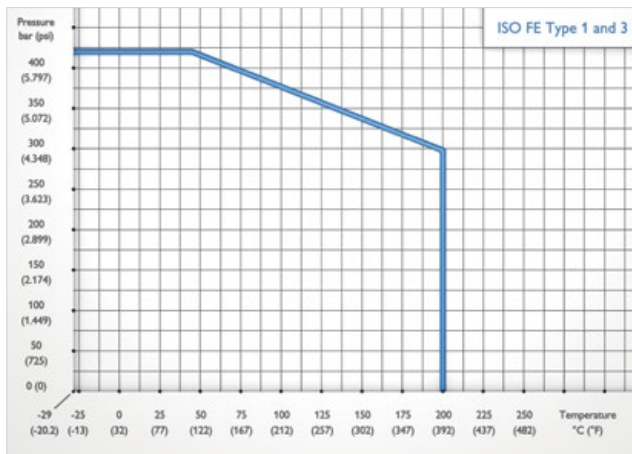

Pressure-Temperature Rating

Bellows PN 100 Safety Packing Graphite
Bellows PN 250 Safety Packing Graphite

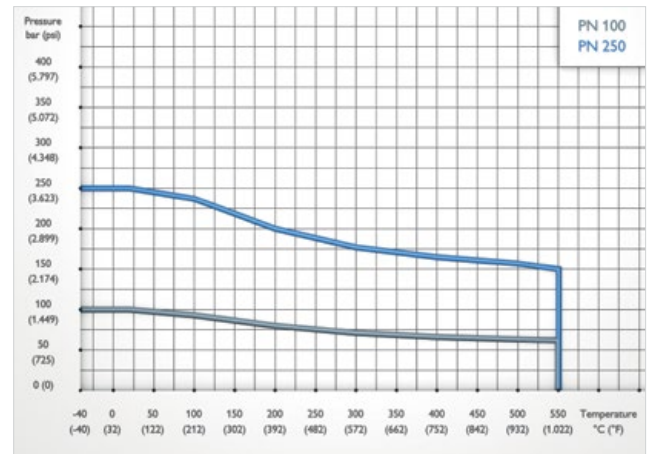

Anti-Tamper Valve Head Unit Options

AS-Schneider is providing 2 Anti-Tamper Valve Head Units, both types are lockable with a padlock.

Standard Anti-Tamper Head Unit

The valves are operated with a special Anti-Tamper Key (AT-Key), which fits exactly in the key guide. The valve can therefore only be operated with the AT-Key. In addition to this safety function, installing a padlock prevents the AT-Key being inserted into the key guide. Operating the valve is therefore no longer possible which protects your equipment against unauthorized opening and closing of the valve head units. The valve can be locked reliably in every position required.

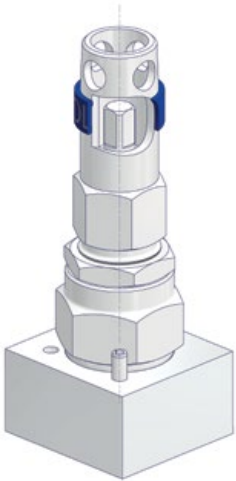

Option Code T or R



Part Number ATK-ES

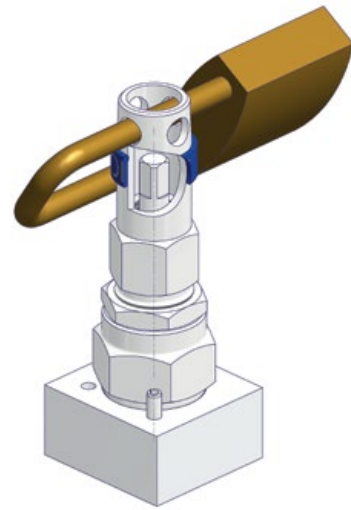

Ind. Padlock; Option Code 4

'AT-Key Lock' Anti-Tamper Head Unit

'AT-Key Lock' valves are operated by a T bar key which is an integral component of the valve. This T bar key can be extracted a little from the valve head unit which loosens the connection between the valve stem and the T bar key. In this extended position a padlock can now be hooked diagonally in the valve head unit which prevents the T bar key being inserted again. Operating the valve is therefore no longer possible which protects your equipment against unauthorised opening and closing of the valve. The valve can be locked reliably in every position required. This design offers you optimal security against unintentional and unauthorized operation of the valve. A colour coded dust cap protects stem threads against ingress of dirt unauthorized opening and closing of the valve head units. The valve can be locked reliably in every position.

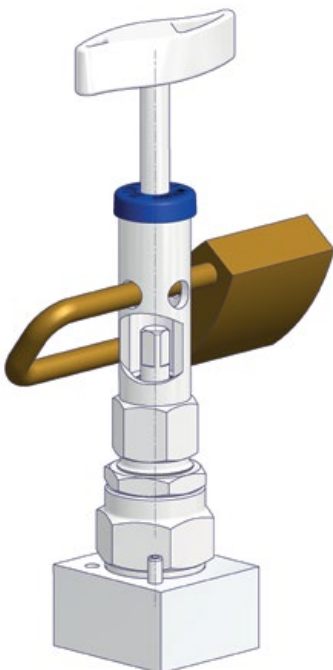

Option Code Q

Stainless Steel Handwheel

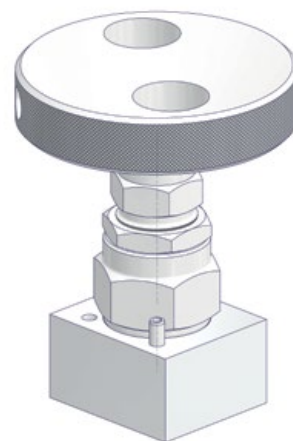

Option Code W

Connections

Connections

AS-Schneider is manufacturing a lot of different connections and connection combinations. In this catalogue we are showing the most popular types. On the next 2 pages you will find the standard connections in detail. If you don't find your option please contact us.

Designations used in the tables: Inlet = Process Connection | Outlet = Instrument / Transmitter Connection

Tube Fittings

Single Ferrule Tube Fittings
acc. to EN ISO 8434-1 Size S

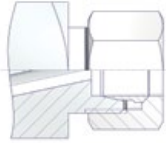

Twin Ferrule Tube Fittings

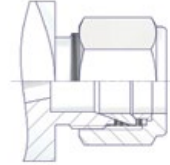

Tapered Pipe Threads

NPT Male Threads
acc. to ASME B 1.20.1

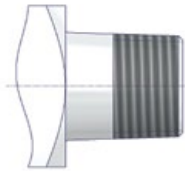

NPT Female Threads
acc. to ASME B 1.20.1

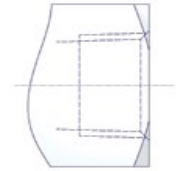

BSP Tapered Thread
acc. to ISO 7/1 (e.g. R 1/2)

BSP Tapered Thread
acc. to ISO 7/1 (e.g. Rc 1/2)

Parallel Pipe Threads

BSP Parallel Male Thread
acc. to ISO 228 (e.g. G1/2)
acc. to DIN 3852
acc. to EN 837-1



BSP Parallel Female Threads
acc. to ISO 228 (e.g. G 1/2)
acc. to DIN 3852-2 Form Z
acc. to ISO 7/1 (e.g.) R 1/2
acc. to EN 837-1

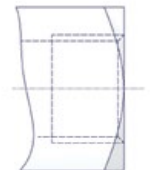

Weld Ends

Butt Weld Ends for
Pipes and Tubes acc. to
EN12627 / ASME B16.9



Socket Weld Ends for
Pipes and Tubes acc. to
EN12760 / ASME B16.11



Pressure Gauge Connections

Swivel Male Connection

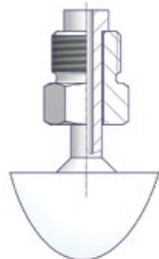

Adjusting Nut
acc. to DIN 16283

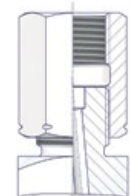

Swivel Nut (Wire Design)

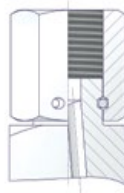

Swivel Nut
(Welded Nipple Design)
acc. to DIN 16284

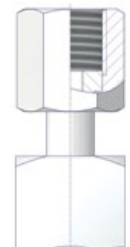

Flange Connections

According to DIN EN 61518 the manifold-transmitter interface is applicable for a maximum allowable pressure (PS) of 413 bar (6,000 psi) and a maximum allowable temperature (TS) of 120°C (248°F) for liquids, gas or vapors. The maximum allowable operating temperature of 120°C (248°F) is considering the requirement that manifolds and transmitters need to be protected against heating by hot media. This can be achieved by using adequate hook-ups or by instrument impulse lines with sufficient length. However the AS-Schneider E Series Manifolds can be used for temperatures up to 550°C (1,022°F), PTFE up to 232°C (450°F), Graphite up to 550°C (1,022°F).

Flange Connections - Inlet Manifold respectively Transmitter Connection DIN EN 61518 / IEC 61518

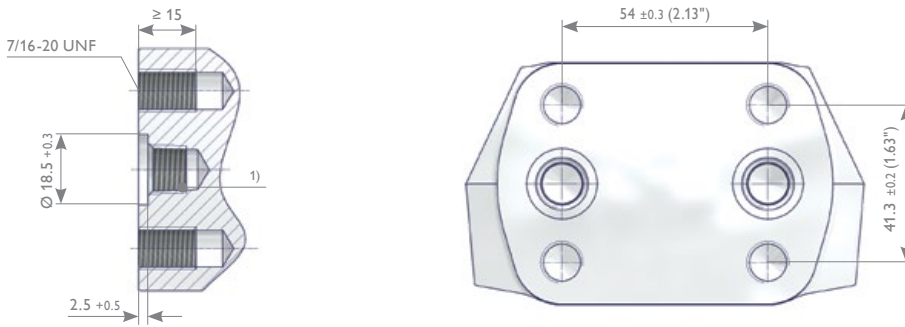

¹⁾ Threaded option for transmitters - plug / vent valve

Flange Connections – Manifold to Transmitter DIN EN 61518 / IEC 61518 Type A and Type B

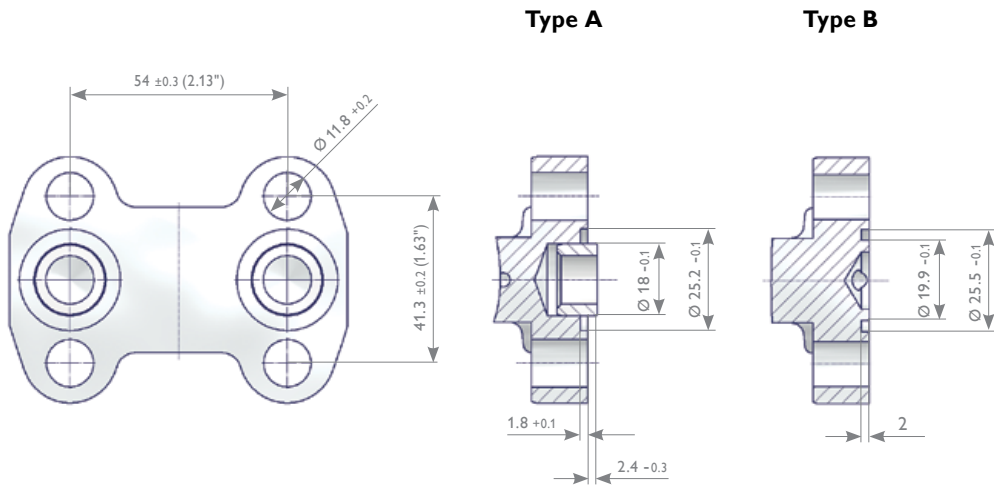

	Connection at the manifold acc. to IEC 61518 / DIN EN 61518 ^{*1}				
	Type A with spigot			Type B without spigot	
Max. operating pressure in bar (psi)	413 (6,000)			413 (6,000)	
Temperature range in °C (°F)	-10 to +80 (14 to 176)	-15 to +120 (5 to 248)	-40 to +120 (-40 to 248)	-10 to +80 (14 to 176)	-40 to +120 (-40 to 248)
Seal Ring ^{*2}	Flat Ring 24 x 17.7 x 2.7 Material: PTFE	O-Ring ISO 3601-1 20 x 2.65 S-FPM90 Material: FPM (FKM by ASTM)	Flat Ring 25.1 x 18 x 2.9 Material: Graphite	Flat Ring 25.4 x 20 x 2.7 Material: PTFE	Flat Ring 25.4 x 19.9 x 2.9 Material: Graphite
Min. thread engagement in mm	9			9	

^{*1} DIN EN 61518 / IEC 61518 | Mating dimensions between pressure measuring instruments and flanged-on shut-off devices up to 413 bar (6,000 psi).

^{*2} Materials and temperature limits for the flat rings and the O-Rings are for reference only. It is the responsibility of the user to ensure compatibility between the selected gasket ring material and the process requirements, such as pressure, temperature, and chemical compatibility.

Hand Valves

Hand Valves

AS-Schneider Hand Valves are available with a lot of options. We are showing on this page just the standard types. You find a lot more options on the next page – Ordering Information Hand Valves.

The dimensions shown apply only to the illustrated valves (1/2 NPT Threaded) – if you need the dimensions for your individual type or should you still not find your options at all please contact the factory.

Hand Valve Female x Female Threaded
HAFF Type

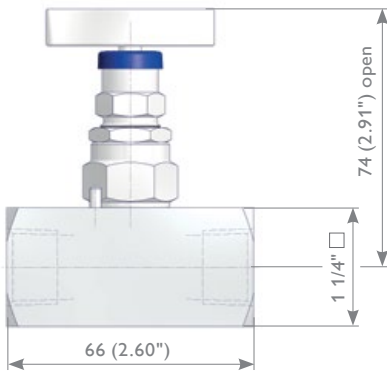

Hand Valve Male x Female Threaded
HAMF Type

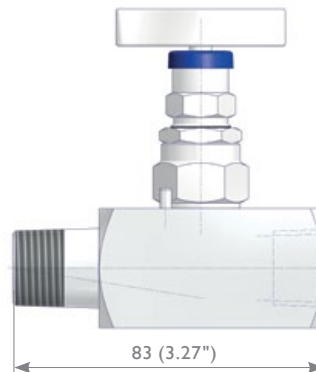

Hand Valve with Integral Tube Fittings
HATT Type

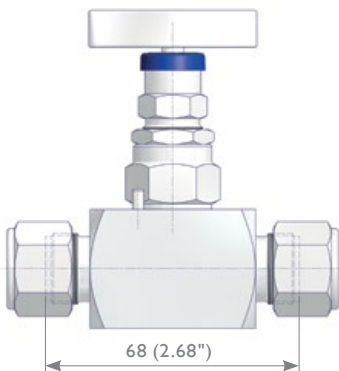

Hand Valve with Extended Body
HXBF Type
Extended by approx. 3"

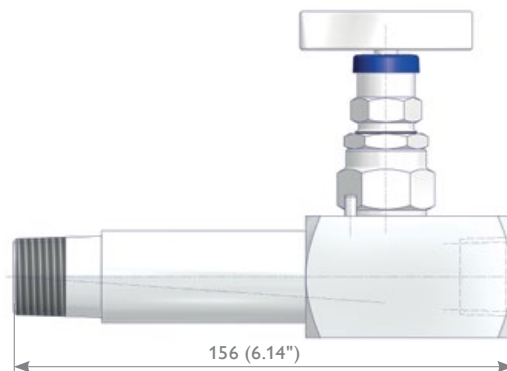

Hand Valve with OS&Y Bolted Bonnet
HFFF Type

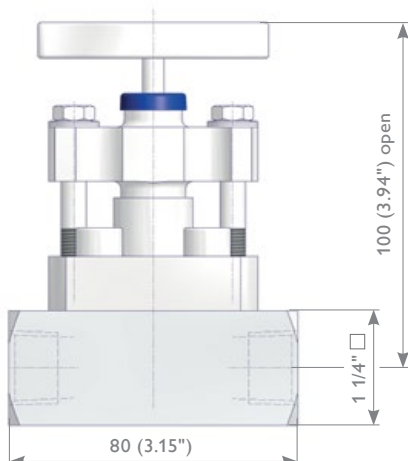

Angle Hand Valve
HLMF Type

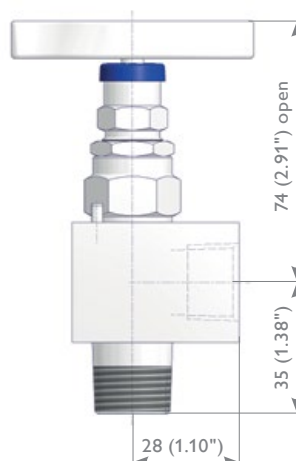

Bore Size 10 mm -
depending on connection size
Width = 1 1/4"

Ordering Information

				1	2	3	4	5	6	7	8	9	10	11	12	13	14	15	16	
				H	A	T	T	S	A	-	R	4	R	4	-	M	S			
H Hand Valves																				
Basic Design																				
A	Screwed Bonnet	L	Angle Hand Valve (Screwed Bonnet)																	
F	OS&Y Bonnet	X	Extended Body (Screwed Bonnet)																	
Inlet																				
M	Male	B	Butt Weld End																	
F	Female	S	Socket Weld End																	
T	Integral Tube Fitting	A	1/2 NPT with Tube Fitting																	
Outlet																				
M	Male	B	Butt Weld End																	
F	Female	S	Socket Weld End																	
T	Integral Tube Fitting	A	1/2 NPT with Tube Fitting																	
Material																				
S	1.4401 / 1.4404 / 316 / 316L	F	Duplex UNS S31803	V	Alloy 625 UNS N06625															
M	Alloy 400 UNS N04400	D	Super Duplex UNS S32750	B	6Mo UNS S31254															
H	Alloy C-276 UNS N10276	2	Super Duplex UNS S32760	T	Titanium Grade 2															
Bonnet																				
A	PTFE	K	O-Ring FKM (FPM by ISO)																	
B	Graphite	W	Carbon filled PTFE - TA-Luft																	
D	ISO FE Series Type 1	2	Bellows sealed PN 100																	
E	ISO FE Series Type 3	4	Bellows sealed PN 250																	
Inlet																				
	Thread Type		Fitting Type		Butt Weld End		Socket Weld End													
N	NPT	C	Single Ferrule Tube Fitting	4	1/2" Pipe	D	For 12 mm Tube (Ø 12.2 mm)													
H	BSP Parallel (G) - DIN 3852-2	S	Swagelok	6	3/4" Pipe	E	For 14 mm Tube (Ø 14.25 mm)													
R	BSP Taper (R/Rc) - ISO 7/1	A	A-Lok	D	12 mm	2	For 1/4" Pipe													
		R	Rotarex	E	14 mm															
	Inch Sizes		Tube Fitting Sizes		Wall Thickness Butt Weld	A	Socket Weld													
2	1/4	1	6 resp. 6S	P	Schedule 80															
4	1/2	2	8 resp. 8S	Q	Schedule 160															
6	3/4	3	10 resp. 10S	2	2.0 mm															
		4	12 resp. 12S	8	2.6 mm															
		7	1/4"	A	3.2 mm															
		8	3/8"																	
		9	1/2"																	
Outlet																				
	Thread Type		Fitting Type		Butt Weld End		Socket Weld End													
N	NPT	C	Single Ferrule Tube Fitting	4	1/2" Pipe	D	For 12 mm Tube (Ø 12.2 mm)													
H	BSP Parallel (G) - DIN 3852	S	Swagelok	6	3/4" Pipe	E	For 14 mm Tube (Ø 14.25 mm)													
R	BSP Taper (R/Rc) - ISO 7/1	A	A-Lok	D	12 mm	2	For 1/4" Pipe													
		R	Rotarex	E	14 mm															
	Inch Sizes		Tube Fitting Sizes		Wall Thickness Butt Weld	A	Socket Weld													
2	1/4	1	6 resp. 6S	P	Schedule 80															
4	1/2	2	8 resp. 8S	Q	Schedule 160															
6	3/4	3	10 resp. 10S	2	2.0 mm															
		4	12 resp. 12S	8	2.6 mm															
		7	1/4"	A	3.2 mm															
		8	3/8"																	
		9	1/2"																	
Options - Specify in alphabetical order (digits first, then letters)																				
B	Cleaned and Lubricated for Oxygen Service - For PTFE Packing only																			
F	PCTFE Soft-Tip																			
G	POM Soft Tip																			
S	Stellite Valve Tip																			
H	10,000 psi (PN 700)																			
P	Power Piping ASME B31.1																			
K	Arctic Operations (-55°C (-67°F)) - For PTFE Packing only																			
M	Wetted Parts with 3.1 certificate																			
C	Panel Mounting																			
Operation Options																				
T	Anti-Tamper Bonnet (Key to be ordered separately)																			
R	Anti-Tamper Bonnet (1 Key supplied per Valve/Manifold)																			
Q	AT-Key Lock Bonnet Design																			
U	Padlock for Anti-Tamper Bonnet / AT-Key Lock Bonnet Design																			
W	Stainless Steel Handwheel																			

Wetted Parts according to above mentioned material list are supplied according to NACE MR0175/MR0103 and ISO 15156 (latest issue) - except Titanium Grade 2.

Note: Not every configuration which can be created in the ordering information is feasible / available.

Gauge Valves

Gauge Valves

AS-Schneider Gauge Valves are designed for mounting to Pressure Gauges, Pressure Transmitters and Pressure Switches. The standard types are equipped with a bleed screw. We are showing on this page just the standard types.

You find a lot more options on the next page – Ordering Information Gauge Valves. Accessories like Swivel Gauge Adaptors, Vent Valves etc. see Pages 44-49.

The dimensions shown apply only to the illustrated valves (1/2 NPT / G 1/2 Threaded) – if you need the dimensions for your individual type or should you still not find your options at all please contact the factory.

Gauge Valve Female x Female Threaded
GSFF Type

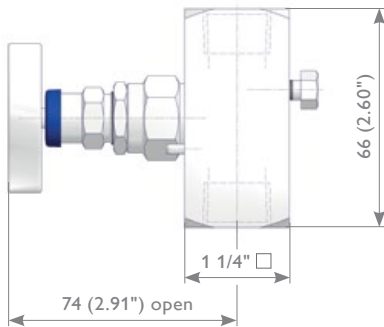

Gauge Valve Male x Female Threaded
GSMF Type

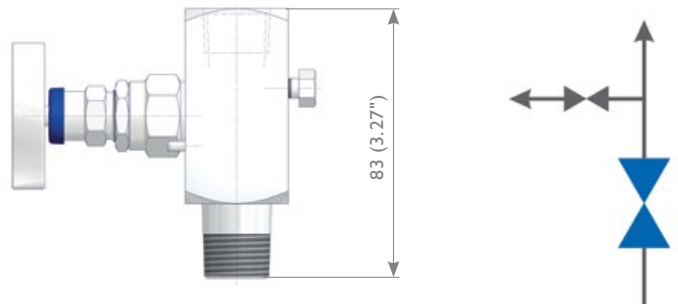

Gauge Valve Male x Male Threaded
GSMM Type

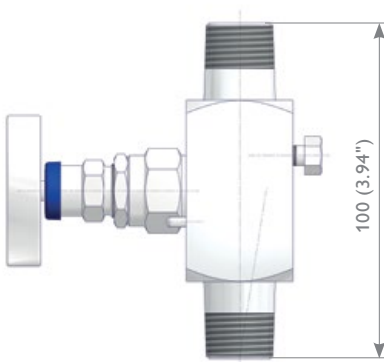

Gauge Valve Male x Adjusting Nut
GSMG Type

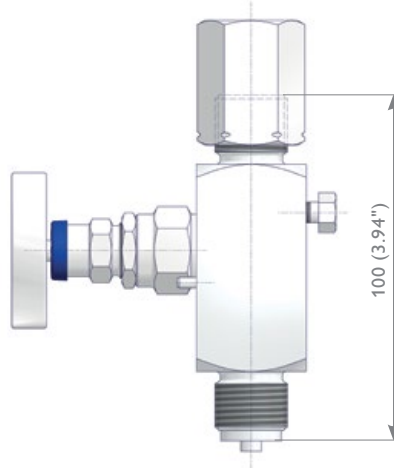

Gauge Valve Male x Female Threaded
GAMF Type

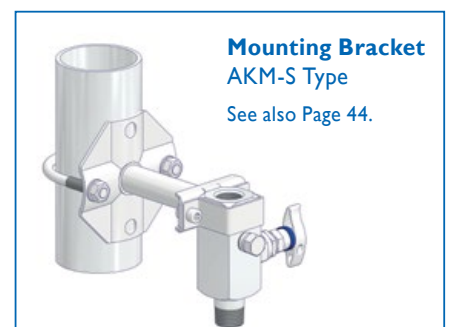
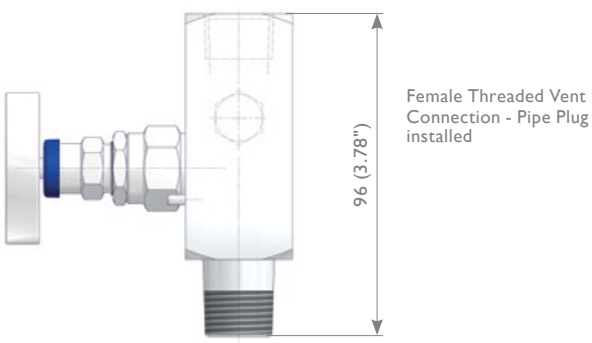

Ordering Information

				1	2	3	4	5	6	7	8	9	10	11	12	13	14	15	16	
				G	S	M	F	S	B	-	N	4	N	4	-	M				
G Gauge Valves																				
Vent Connection																				
S	Bleed Screw	C	G 1/4 Female																	
A	1/4 NPT Female	D	G 1/2 Female																	
B	1/2 NPT Female																			
Inlet																				
M	Male	B	Butt Weld End																	
F	Female	S	Socket Weld End																	
T	Integral Tube Fitting	A	1/2 NPT with Tube Fitting																	
Outlet																				
M	Male	G	Adjusting Nut																	
F	Female	D	Swivel Nut (Wire Design)																	
Material																				
S	1.4401 / 1.4404 / 316 / 316L	F	Duplex UNS S31803	V	Alloy 625 UNS N06625															
M	Alloy 400 UNS N04400	D	Super Duplex UNS S32750	B	6Mo UNS S31254															
H	Alloy C-276 UNS N10276	2	Super Duplex UNS S32760	T	Titanium Grade 2															
Bonnet																				
A	PTFE	K	O-Ring FKM (FPM by ISO)																	
B	Graphite	W	Carbon filled PTFE - TA-Luft																	
D	ISO FE Series Type 1	2	Bellows sealed PN 100																	
E	ISO FE Series Type 3	4	Bellows sealed PN 250																	
Inlet																				
Thread Type		Fitting Type		Butt Weld End		Socket Weld End														
N	NPT	C	Single Ferrule Tube Fitting	4	1/2" Pipe	D	For 12 mm Tube (Ø 12.2 mm)													
G	BSP Parallel (G) - EN 837-1	S	Swagelok	6	3/4" Pipe	E	For 14 mm Tube (Ø 14.25 mm)													
H	BSP Parallel (G) - DIN 3852	A	A-Lok	D	12 mm	2	For 1/4" Pipe													
R	BSP Taper (R/Rc) - ISO 7/1	R	Rotarex	E	14 mm															
M	Metric similar to EN 837-1																			
Inch Sizes		Tube Fitting Sizes		Wall Thickness Butt Weld		Socket Weld														
2	1/4	4	12 resp. 12S	P	Schedule 80															
4	1/2	5	14 resp. 14S	Q	Schedule 160															
6	3/4	9	1/2"	2	2.0 mm															
				8	2.6 mm															
				A	3.2 mm															
Metric Size																				
4	M20 x 1.5																			
Outlet																				
Male / Female Thread Sizes		Thread Sizes EN 837-1 - Female Threads only																		
N2	1/4 NPT Female Thread only	G2	G 1/4 (1/4 BSP P)																	
N4	1/2 NPT	G4	G 1/2 (1/2 BSP P)																	
R4	R/Rc 1/2 - ISO 7/1 (1/2 BSPT) Female Thread only	M4	M20 x 1.5																	
Options - Specify in alphabetical order (digits first, then letters)																				
B	Cleaned and Lubricated for Oxygen Service - For PTFE Packing only																			
F	PCTFE Soft Tip																			
G	POM Soft Tip																			
S	Stellite Valve Tip																			
H	10,000 psi (PN 700)																			
P	Power Piping ASME B31.1																			
K	Arctic Operations (-55°C (-67°F)) - For PTFE Packing only																			
M	Wetted Parts with 3.1 certificate																			
C	Panel Mounting																			
Operation Options																				
T	Anti-Tamper Bonnet (Key to be ordered separately)																			
R	Anti-Tamper Bonnet (1 Key supplied per Valve/Manifold)																			
Q	AT-Key Lock Bonnet Design																			
U	Padlock for Anti-Tamper Bonnet / AT-Key Lock Bonnet Design																			
W	Stainless Steel Handwheel																			
Accessory Kits																				
8	SST Mounting Bracket AKM-S Type for 2" Pipe Mounting supplied separately - For Vertical Impulse Piping Installations																			

Wetted Parts according to above mentioned material list are supplied according to NACE MR0175/MR0103 and ISO 15156 (latest issue) - except Titanium Grade 2.

Note: Not every configuration which can be created in the ordering information is feasible / available.

Multiport Gauge Valves

Multiport Gauge Valves

AS-Schneider Multiport Gauge Valves are designed for mounting to Pressure Gauges, Pressure Transmitters and Pressure Switches. The standard types are provided with 3 female outlet ports and are therefore suitable for vertical or horizontal installations.

Accessories like Pipe Plugs and Vent Valves can be ordered separately or already factory installed – see also options next page – Ordering Information Multiport Gauge Valves. Accessories like Swivel Gauge Adaptors, Vent Valves etc. see Pages 44-49.

The dimensions shown apply only to the illustrated valves (1/2 NPT Threaded) – if you need the dimensions for your individual type or should you still not find your options at all please contact the factory.

Multiport Gauge Valve – Screwed Bonnet MAMA Type

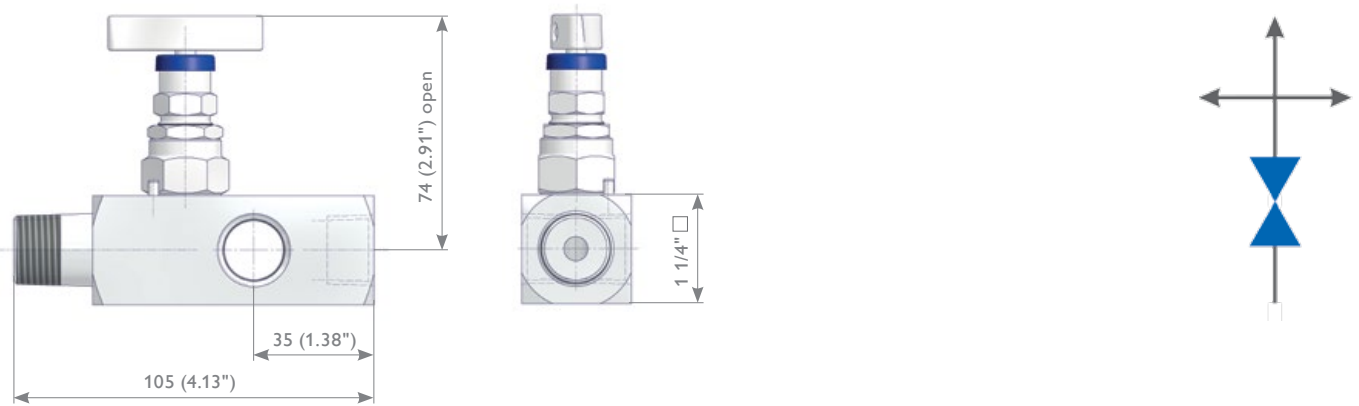

Multiport Gauge Valve with Extended Body MXBA Type Extended by approx. 3"

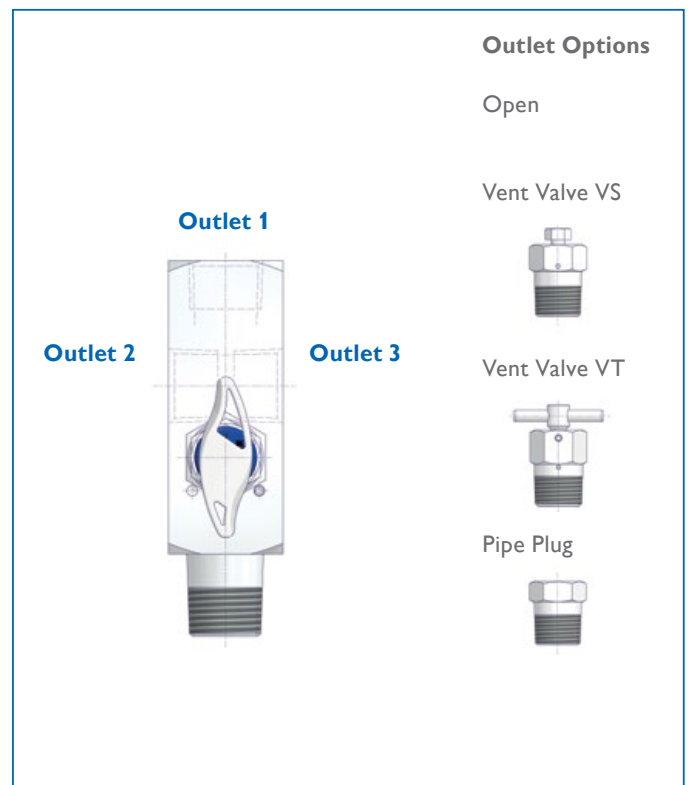
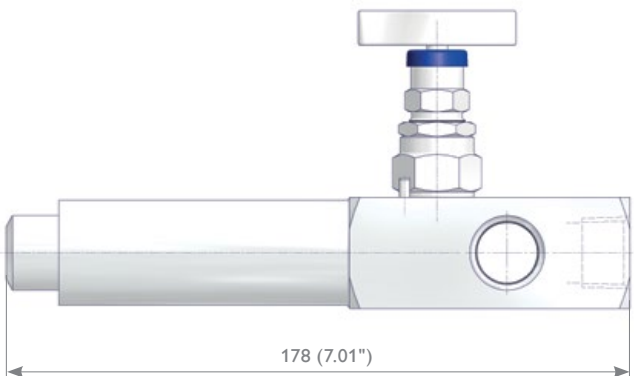

Ordering Information

	1	2	3	4	5	6	7	8	9	10	11	12	13	14	15	16
M	A	B	B	S	A	-	6	P	N	4	-	S				
M Multiport Gauge Valves																
Basic Design																
A	Screwed Bonnet															
F	OS&Y Bonnet															
X	Extended Body (Screwed Bonnet)															
Inlet																
M	Male		B	Butt Weld End												
F	Female		S	Socket Weld End												
Outlet																
A	3 x Female															
B	Outlet 1 - Female, Outlet 2 - Pipe Plug, Outlet 3 - Vent Valve VS															
C	Outlet 1 - Female, Outlet 2 - Pipe Plug, Outlet 3 - Vent Valve VT															
D	Outlet 1 - Female, Outlet 2 and 3 - Pipe Plug															
Material																
S	1.4401 / 1.4404 / 316 / 316L		F	Duplex UNS S31803		V	Alloy 625 UNS N06625									
M	Alloy 400 UNS N04400		D	Super Duplex UNS S32750		B	6Mo UNS S31254									
H	Alloy C-276 UNS N10276		2	Super Duplex UNS S32760		T	Titanium Grade 2									
Bonnet																
A	PTFE		K	O-Ring FKM (FPM by ISO)												
B	Graphite		W	Carbon filled PTFE - TA-Luft												
D	ISO FE Series Type 1		2	Bellows sealed PN 100												
E	ISO FE Series Type 3		4	Bellows sealed PN 250												
Inlet																
Thread Type																
N	NPT		4	1/2" pipe												
H	BSP Parallel (G) - DIN 3852		6	3/4" pipe												
Inch Sizes																
2	1/4		P	Schedule 80												
4	1/2		Q	Schedule 160												
6	3/4		4	4.0 mm												
Outlet																
Thread Sizes - Female Threads only																
N2	1/4 NPT		H4	G 1/2 (1/2 BSP P) - DIN 3852												
N4	1/2 NPT															
Options - Specify in alphabetical order (digits first, then letters)																
B	Cleaned and Lubricated for Oxygen Service - For PTFE Packing only															
F	PCTFE Soft Tip															
G	POM Soft Tip															
S	Stellite Valve Tip															
H	10,000 psi (PN 700)															
P	Power Piping ASME B31.1															
K	Arctic Operations (-55°C (-67°F)) - For PTFE Packing only															
M	Wetted Parts with 3.1 certificate															
Operation Options																
T	Anti-Tamper Bonnet (Key to be ordered separately)															
R	Anti-Tamper Bonnet (1 Key supplied per Valve/Manifold)															
Q	AT-Key Lock Bonnet Design															
U	Padlock for Anti-Tamper Bonnet / AT-Key Lock Bonnet Design															
W	Stainless Steel Handwheel															

Wetted Parts according to above mentioned material list are supplied according to NACE MR0175/MR0103 and ISO 15156 (latest issue) - except Titanium Grade 2.

Note: Not every configuration which can be created in the ordering information is feasible / available.

Block & Bleed Manifolds

Block & Bleed Manifolds (2 Valve Manifold)

AS-Schneider Block & Bleed Manifolds are designed for mounting to Pressure Gauges, Pressure Transmitters and Pressure Switches. The standard vent connection is 1/4 NPT female. Pipe plugs are not installed as standard. For plugged vent ports (factory installed) – see also options next page – Ordering Information Block & Bleed Manifolds. Accessories like Swivel Gauge Adaptors, Vent Valves etc. see Pages 44-49.

The dimensions shown apply only to the illustrated valves (1/2 NPT Threaded) – if you need the dimensions for your individual type or should you still not find your options at all please contact the factory.

Block & Bleed Manifolds – Female Threaded Instrument Connection

SAFF Type

SAMF Type

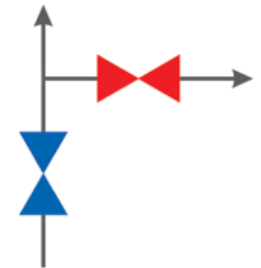
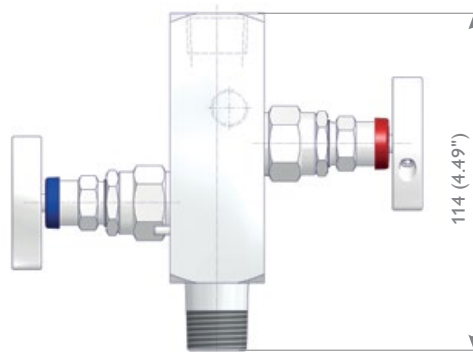
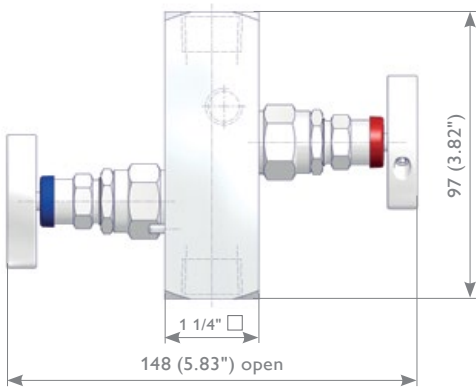

Block & Bleed Manifolds – Male Threaded Instrument Connection

SAFM Type

SAMM Type

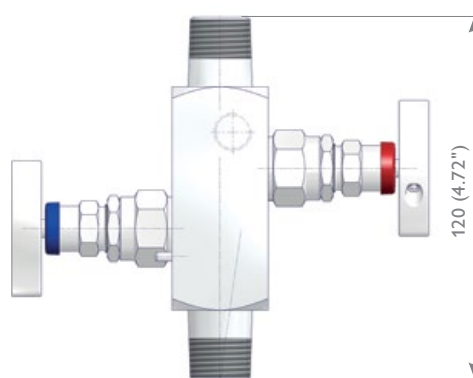
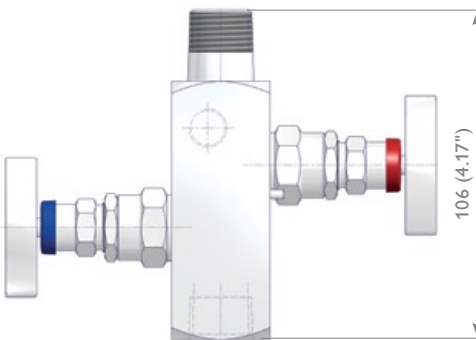

Block & Bleed Manifolds – Instrument Connection with Swivel Nut

SAFD Type

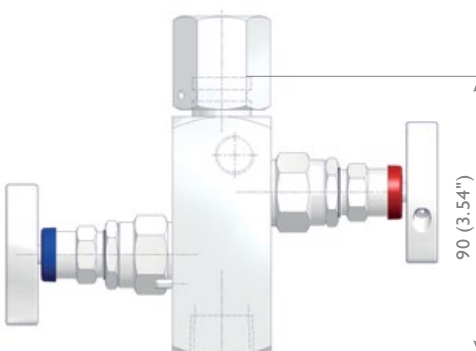

Ordering Information

	1	2	3	4	5	6	7	8	9	10	11	12	13	14	15	16
	S	A	M	F	M	A	-	N	4	N	4	-	Q	U	9	
S	Block & Bleed Manifolds															
Vent Connection																
A	1/4 NPT Female		C	G 1/4 Female												
B	1/2 NPT Female		D	G 1/2 Female												
Inlet																
M	Male		B	Butt Weld End												
F	Female		S	Socket Weld End												
T	Integral Tube Fitting		A	1/2 NPT with Tube Fitting												
Outlet																
M	Male		G	Adjusting Nut												
F	Female		D	Swivel Nut (Wire Design)												
Material																
S	1.4401 / 1.4404 / 316 / 316L		F	Duplex UNS S31803		V	Alloy 625 UNS N06625									
M	Alloy 400 UNS N04400		D	Super Duplex UNS S32750		B	6Mo UNS S31254									
H	Alloy C-276 UNS N10276		2	Super Duplex UNS S32760		T	Titanium Grade 2									
Bonnet																
A	PTFE		K	O-Ring FKM (FPM by ISO)												
B	Graphite		W	Carbon filled PTFE - TA-Luft												
D	ISO FE Series Type 1		2	Bellows sealed PN 100												
E	ISO FE Series Type 3		4	Bellows sealed PN 250												
Inlet																
Thread Type			Fitting Type			Butt Weld End			Socket Weld End							
N	NPT		C	Single Ferrule Tube Fitting		4	1/2" Pipe		D	For 12 mm Tube (Ø 12.2 mm)						
G	BSP Parallel (G) - EN 837-1		S	Swagelok		6	3/4" Pipe		E	For 14 mm Tube (Ø 14.25 mm)						
H	BSP Parallel (G) - DIN 3852		A	A-Lok		D	12 mm		2	For 1/4" Pipe						
R	BSP Taper (R/Rc) - ISO 7/1		R	Rotarex		E	14 mm									
M	Metric similar to EN 837-1															
Inch Sizes			Tube Fitting Sizes			Wall Thickness Butt Weld			Socket Weld							
2	1/4		4	12 resp. 12S		P	Schedule 80									
4	1/2		5	14 resp. 14S		Q	Schedule 160									
6	3/4		9	1/2"		2	2.0 mm									
						8	2.6 mm									
						A	3.2 mm									
Metric Size																
4	M20 x 1.5															
Outlet																
Male / Female Thread Sizes						Thread Sizes EN 837-1 - Female Threads only										
N2	1/4 NPT Female Thread only		G2	G 1/4 (1/4 BSP P)												
N4	1/2 NPT		G4	G 1/2 (1/2 BSP P)												
R4	R/Rc 1/2 - ISO 7/1 (1/2 BSPT) Female Thread only		M4	M20 x 1.5												
Options - Specify in alphabetical order (digits first, then letters)																
B	Cleaned and Lubricated for Oxygen Service - For PTFE Packing only															
F	PCTFE Soft Tip															
G	POM Soft Tip															
S	Stellite Valve Tip															
A	Vent Ports Plugged															
H	10,000 psi (PN 700)															
P	Power Piping ASME B31.1															
K	Arctic Operations (-55°C (-67°F)) - For PTFE Packing only															
M	Wetted Parts with 3.1 certificate															
Operation Options																
T	Anti-Tamper Bonnet (Key to be ordered separately)															
R	Anti-Tamper Bonnet (1 Key supplied per Valve/Manifold)															
Q	AT-Key Lock Bonnet Design															
U	Padlock for Anti-Tamper Bonnet / AT-Key Lock Bonnet Design															
V	Stainless Steel Handwheel															
Accessory Kits																
8	SST Mounting Bracket AKM-S Type for 2" Pipe Mounting supplied separately - For Vertical Impulse Piping Installations															

Wetted Parts according to above mentioned material list are supplied according to NACE MR0175/MR0103 and ISO 15156 (latest issue) - except Titanium Grade 2.

Note: Not every configuration which can be created in the ordering information is feasible / available.

L, Y & W-Shaped Manifolds

L, Y & W-Shaped Manifolds

AS-Schneider L, Y & W-Shaped Manifolds are designed for mounting to Pressure Gauges, Pressure Transmitters and Pressure Switches. The standard vent connection is 1/4 NPT female. Pipe plugs are not installed as standard. For plugged vent ports (factory installed) – see also options Page 24 – Ordering Information L, Y & W-Shaped Manifolds. Accessories like Swivel Gauge Adaptors, Vent Valves etc. see Pages 44-49.

The dimensions shown apply only to the illustrated valves (1/2 NPT Threaded) – if you need the dimensions for your individual type or should you still not find your options at all please contact the factory.

L-Shaped Manifolds

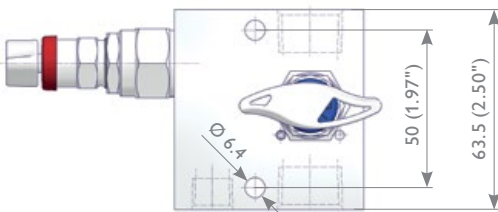
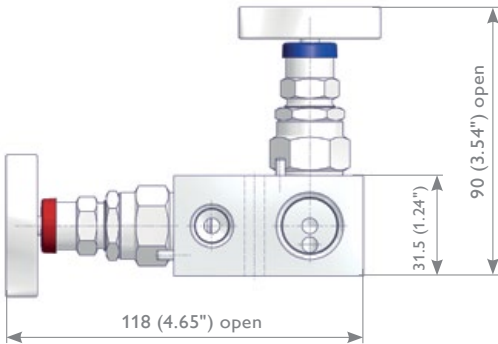

PLAA Type

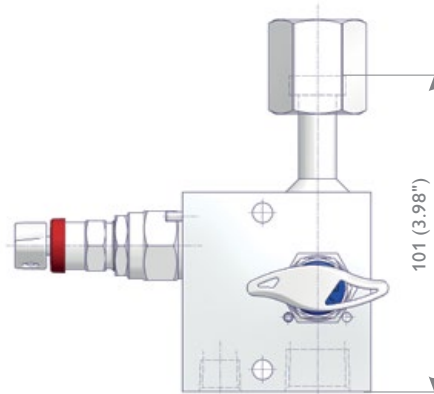
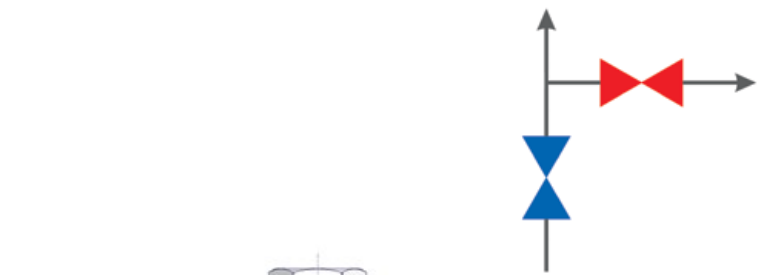

PLAB Type

Y-Shaped Manifolds

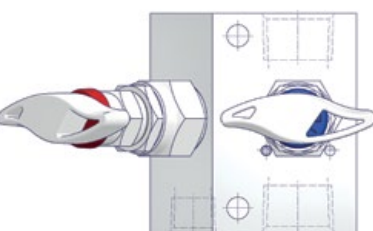
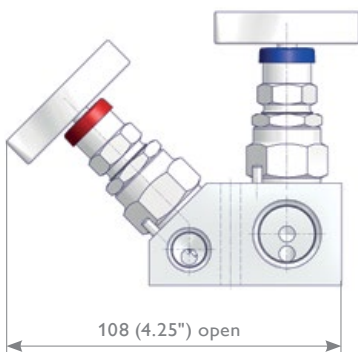

PYAA Type

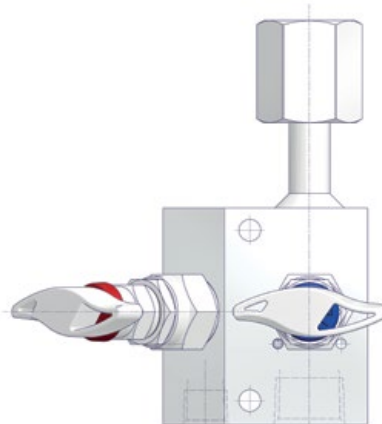

PYAB Type

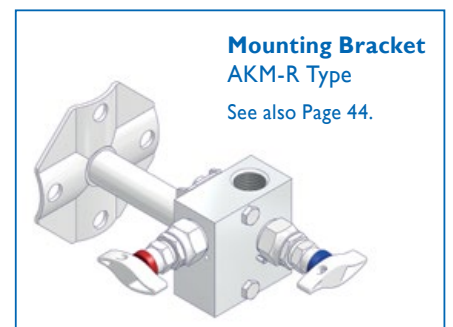

W-Shaped Manifolds PWAA Type

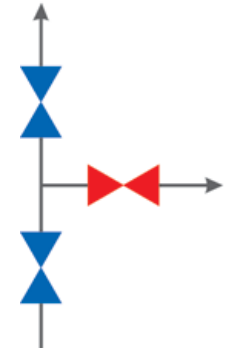
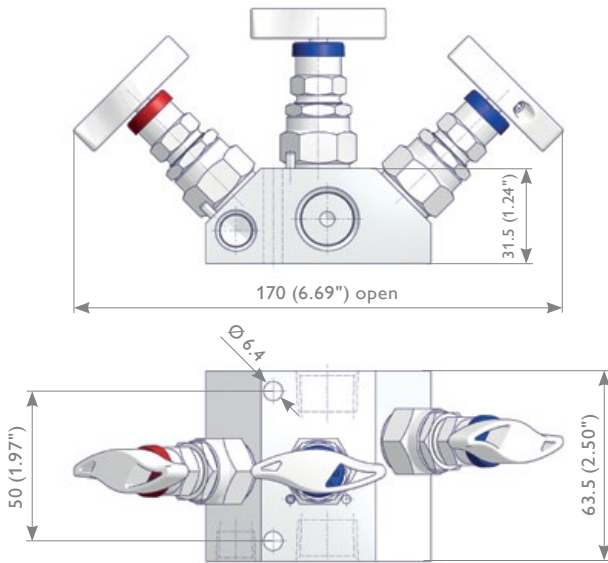

Double Block & Bleed Manifolds DC1 Series

For detailed information regarding the AS-Schneider DC Series see our catalogue AS-2001.

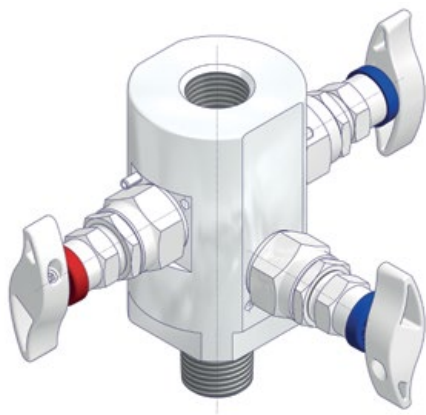

Mounting Bracket AKM-R Type

See also Page 44.

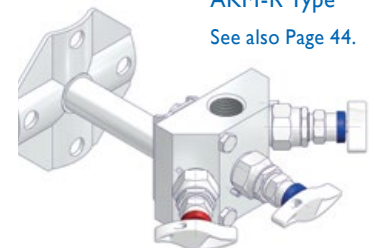

L, Y & W-Shaped Manifolds

Ordering Information

	1	2	3	4	5	6	7	8	9	10	11	12	13	14	15	16		
	P	L	A	B	S	A	-	N	4	G	4	-	A	M	S			
P	L, Y & W-Shaped Manifolds																	
Manifold Type																		
L	L-Shaped Bonnet Orientation																	
Y	Y-Shaped Bonnet Orientation																	
W	W-Shaped Bonnet Orientation => Double Block & Bleed Type																	
Vent Connection																		
A	1/4 NPT Female				F	1/4 NPT with Tube Fitting 6 mm												
B	1/2 NPT Female - only Type PL...				G	1/4 NPT with Tube Fitting 12 mm												
C	G 1/4 Female				H	G 1/4 with Tube Fitting 6 mm												
D	G 1/2 Female - only Type PL...				J	G 1/4 with Tube Fitting 12 mm Tube Fitting Brand see inlet/outlet												
Inlet x Outlet Configuration																		
A	Female x Female				E	G 1/2 with Tube Fitting x Female												
B	Female x Swivel Nut				F	G 1/2 with Tube Fitting x Swivel Nut												
C	1/2 NPT with Tube Fitting x Female																	
D	1/2 NPT with Tube Fitting x Swivel Nut																	
Material																		
S	1.4401 / 1.4404 / 316 / 316L				F	Duplex UNS S31803				V	Alloy 625 UNS N06625							
M	Alloy 400 UNS N04400				D	Super Duplex UNS S32750				B	6Mo UNS S31254							
H	Alloy C-276 UNS N10276				2	Super Duplex UNS S32760				T	Titanium Grade 2							
Bonnet																		
A	PTFE				K	O-Ring FKM (FPM by ISO)												
B	Graphite				W	Carbon filled PTFE - TA-Luft												
D	ISO FE Series Type 1				2	Bellows sealed PN 100												
E	ISO FE Series Type 3				4	Bellows sealed PN 250												
Inlet																		
Thread Type																		
N	NPT				C	Single Ferrule Tube Fitting												
H	BSP Parallel (G) - DIN 3852				S	Swagelok												
					A	A-Lok												
					R	Rotarex												
Thread Size																		
2	1/4				4	12 resp. 12S												
4	1/2				9	1/2"												
Outlet																		
Thread Type																		
N4	1/2 NPT Female																	
G4	G 1/2 Swivel Nut																	
M4	M20 x 1.5 Swivel Nut																	
Options - Specify in alphabetical order (digits first, then letters)																		
B	Cleaned and Lubricated for Oxygen Service - For PTFE Packing only																	
F	PCTFE Soft Tip																	
G	POM Soft Tip																	
S	Stellite Valve Tip																	
A	Vent Ports Plugged																	
H	10,000 psi (PN 700)																	
K	Arctic Operations (-55°C (-67°F)) - For PTFE Packing only																	
P	Power Piping ASME B31.1																	
M	Wetted Parts with 3.1 certificate																	
Operation Options																		
T	Anti-Tamper Bonnet (Key to be ordered separately)																	
R	Anti-Tamper Bonnet (1 Key supplied per Valve/Manifold)																	
Q	AT-Key Lock Bonnet Design																	
U	Padlock for Anti-Tamper Bonnet / AT-Key Lock Bonnet Design																	
W	Stainless Steel Handwheel																	
Accessory Kits																		
8	SST Mounting Bracket AKM-R Type for 2" Pipe Mounting supplied separately - For Vertical Impulse Piping Installations																	

Wetted Parts according to above mentioned material list are supplied according to NACE MR0175/MR0103 and ISO 15156 (latest issue) - except Titanium Grade 2.

Note: Not every configuration which can be created in the ordering information is feasible / available.

Remote Mounted Manifolds (2, 3 and 5 Valve Manifolds)

AS-Schneider Remote Mounted Manifolds are designed for remote installation from Pressure Instruments and Differential Pressure Transmitters. The standard vent connection is 1/4 NPT female. Pipe plugs are not installed as standard to 2 and 5 Valve Manifolds. For plugged vent ports (factory installed) - see also options Page 27 - Ordering Information Remote Mounted Manifolds. The standard type of 3 Valve Manifolds is the one without vent connection. The 3 Valve Manifolds with vent connection are supplied with installed pipe plugs as standard. Accessories like Mounting Brackets, Swivel Gauge Adaptors, Pipe Plugs etc. see also Pages 44-49.

The dimensions shown apply only to the illustrated valves (1/2 NPT Threaded) – if you need the dimensions for your individual type or should you still not find your options at all please contact the factory.

2 Valve Manifolds, Remote Mounted R2AA Type

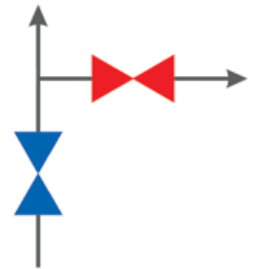
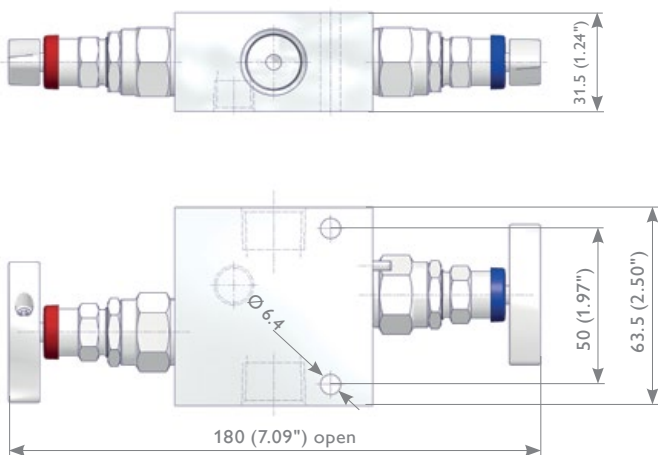

3 Valve Manifolds, Remote Mounted without Vent Connection R3AA Type

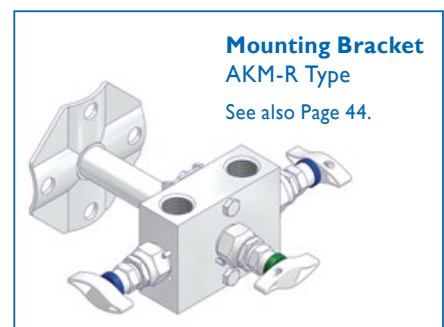
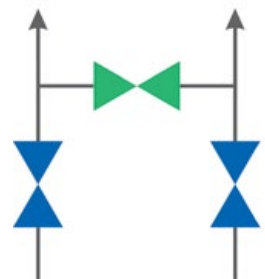
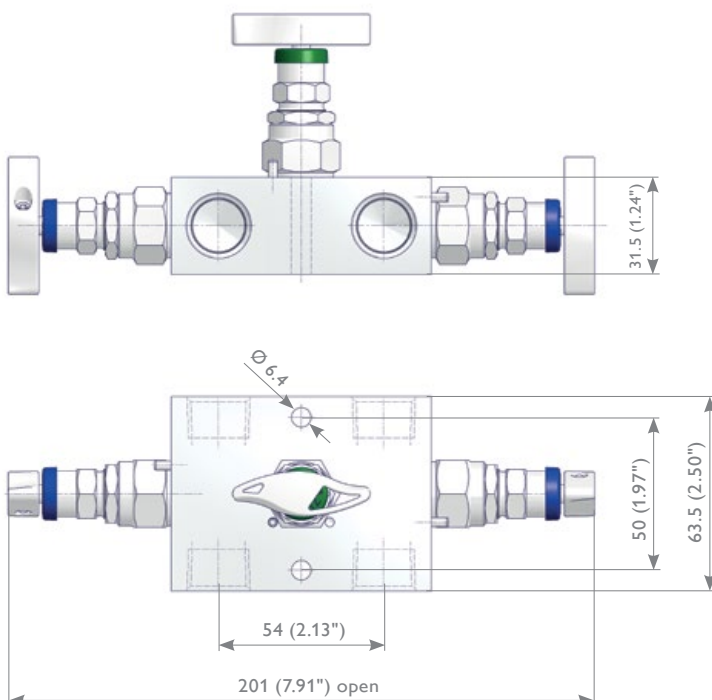

Remote Mounted Manifolds

3 Valve Manifolds, Remote Mounted with Vent Connection 1/4 NPT Female R3BA Type

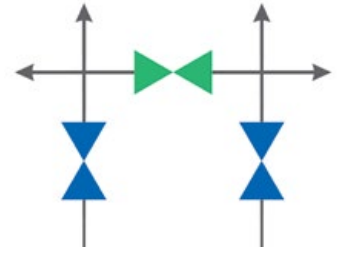
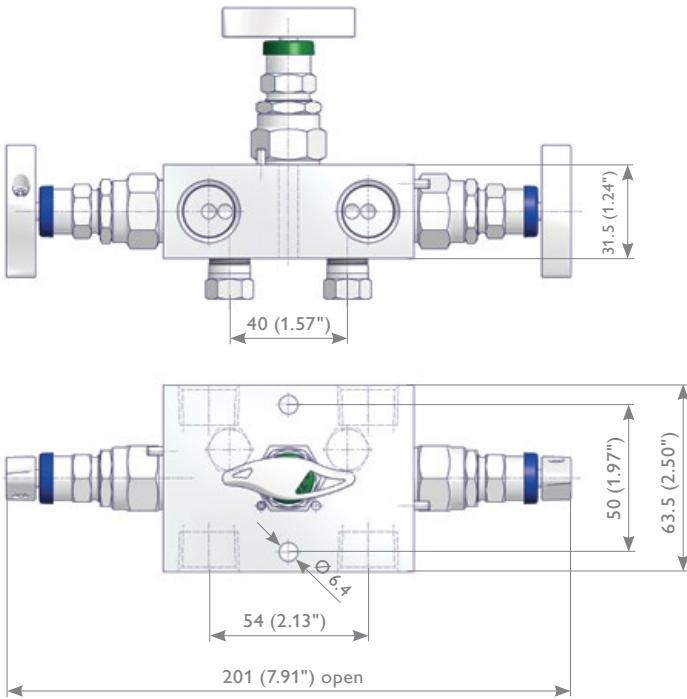

5 Valve Manifolds, Remote Mounted R5AA Type

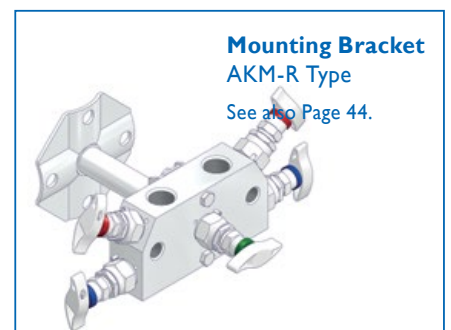
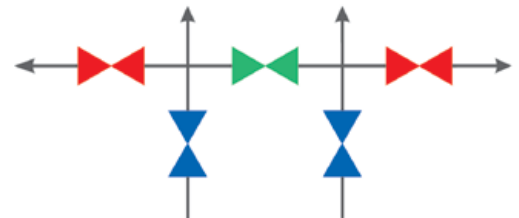
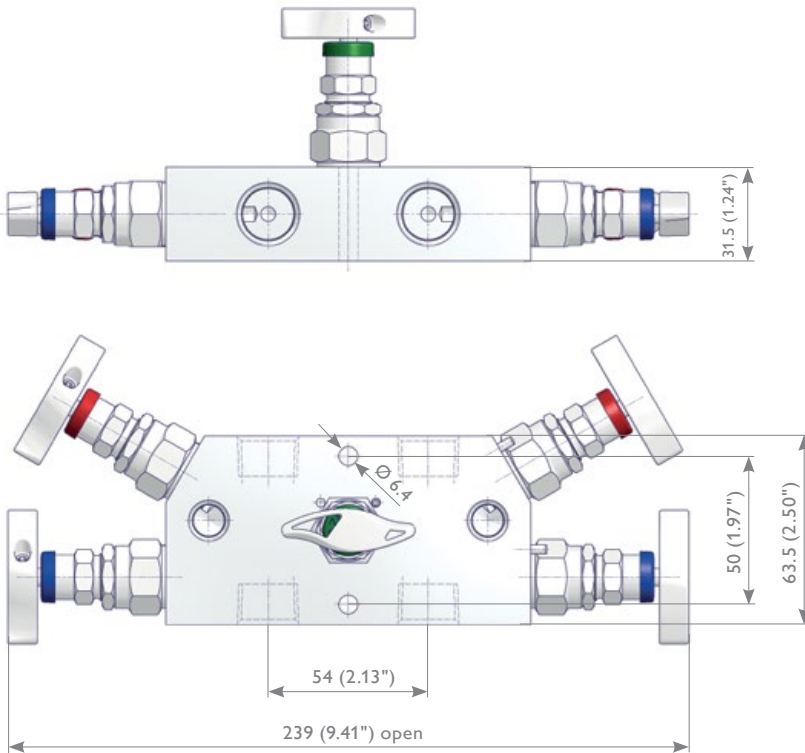

Ordering Information

	1	2	3	4	5	6	7	8	9	10	11	12	13	14	15	16
R	3	B	C	H	A	-	S	9	S	9	-	R	U			
R Remote Mounted Manifolds																
Quantity Bonnets - 2, 3 or 5																
Vent Connection																
A	Standard - 2 Valve / 5 Valve Manifold with Vent Ports 1/4 NPT Female, 3 Valve Manifold without Vent Port															
B	Vent Ports 1/4 NPT Female - For 3 Valve Manifolds only															
C	G 1/4 Female															
Inlet and Outlet																
A	Female Connections															
B	1/4 NPT with Tube Fittings															
C	1/2 NPT with Tube Fittings															
D	G 1/2 with Tube Fittings															
Material																
S	1.4401 / 1.4404 / 316 / 316L	F	Duplex UNS S31803	V	Alloy 625 UNS N06625											
M	Alloy 400 UNS N04400	D	Super Duplex UNS S32750	B	6Mo UNS S31254											
H	Alloy C-276 UNS N10276	2	Super Duplex UNS S32760	T	Titanium Grade 2											
Bonnet																
A	PTFE			K	O-Ring FKM (FPM by ISO)											
B	Graphite			W	Carbon filled PTFE - TA-Luft											
D	ISO FE Series Type 1			2	Bellows sealed PN 100											
E	ISO FE Series Type 3			4	Bellows sealed PN 250											
Inlet																
Thread Type																
N	NPT			C	Single Ferrule Tube Fitting											
H	BSP Parallel (G) - DIN 3852			S	Swagelok											
				A	A-Lok											
				R	Rotarex											
Thread Size																
2	1/4			4	12 resp. 12S											
4	1/2			9	1/2"											
Outlet																
Thread Type																
N	NPT			C	Single Ferrule Tube Fitting											
H	BSP Parallel (G) - DIN 3852			S	Swagelok											
				A	A-Lok											
Thread Size																
2	1/4			4	12 resp. 12S											
4	1/2			9	1/2"											
Options - Specify in alphabetical order (digits first, then letters)																
B	Cleaned and Lubricated for Oxygen Service - For PTFE Packing only															
F	PCTFE Soft Tip															
G	POM Soft Tip															
S	Stellite Valve Tip															
A	Vent Ports Plugged															
H	10,000 psi (PN 700)															
K	Arctic Operations (-55°C (-67°F)) - For PTFE Packing only															
P	Power Piping ASME B31.1															
M	Wetted Parts with 3.1 certificate															
Operation Options																
T	Anti-Tamper Bonnet (Key to be ordered separately)															
R	Anti-Tamper Bonnet (1 Key supplied per Valve/Manifold)															
Q	AT-Key Lock Bonnet Design															
U	Padlock for Anti-Tamper Bonnet / AT-Key Lock Bonnet Design															
W	Stainless Steel Handwheel															
Accessory Kits																
8	SST Mounting Bracket AKM-R Type for 2" Pipe Mounting supplied separately - For Vertical Impulse Piping Installations															

Wetted Parts according to a.m. material list are supplied according to NACE MR0175/MR0103 and ISO 15156 (latest issue) - except Titanium Grade 2.

Note: Not every configuration which can be created in the ordering information is feasible / available.

Direct Mount Manifolds

Direct Mount Manifolds (2, 3 and 5 Valve Manifolds)

AS-Schneider Direct Mount Manifolds are designed for direct mounting to Pressure and Differential Pressure Transmitters – either Transmitters with standard flange connection in accordance with DIN EN 61518 / IEC 61518 or alternatively to Rosemount 2051/3051 Coplanar™ Pressure Transmitters. The standard vent connection is 1/4 NPT female. Pipe plugs are not installed as standard to 2 and 5 Valve Manifolds. For plugged vent ports (factory installed) and other options see Page 36 – Ordering Information Direct Mount Manifolds.

The standard type of 3 Valve Manifolds is the one without vent connection. 3 Valve Manifolds with vent connection are supplied with installed pipe plugs as standard. Integral Style 3 Valve Manifolds with Coplanar™ flange connection are provided with vent connections 1/4 NPT female as standard – plugged with vent valves type VS.

We differentiate between Wafer Style Manifolds and Traditional Style Manifolds, the Wafer Type for the Rosemount 2051/3051 Coplanar™ Pressure Transmitter is just called Coplanar™ Style Manifold. Accessories like Swivel Gauge Adaptors, Vent Valves etc. see Pages 44-49.

The dimensions shown apply only to the illustrated valves (1/2 NPT Threaded / Flange Interface DIN EN 61518) – if you need the dimensions for your individual type or should you still not find your options at all please contact the factory.

Wafer Style Manifolds

2 Valve Manifolds – Standard

W2AA Type

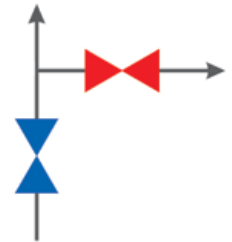
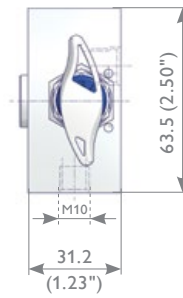
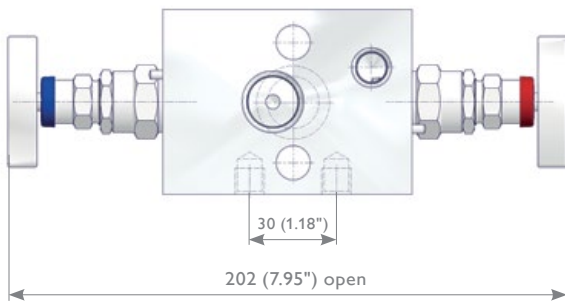

2 Valve Manifolds – L-Shaped Bonnet Orientation

W2LA Type

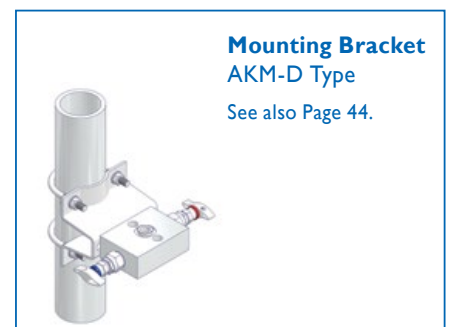
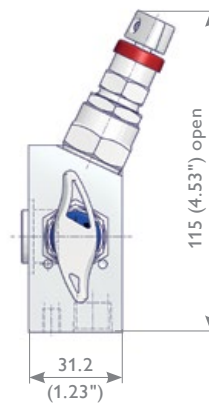
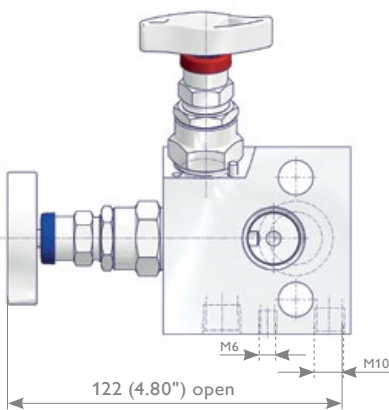

3 Valve Manifolds – Standard (Female x Flanged)

Without Vent Connection W3AA Type

With Vent Connection W3BA Type

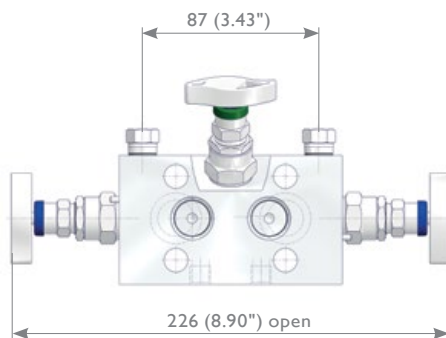
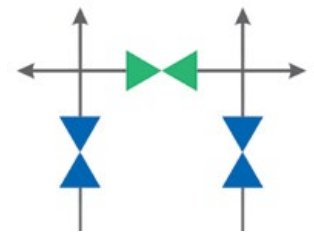
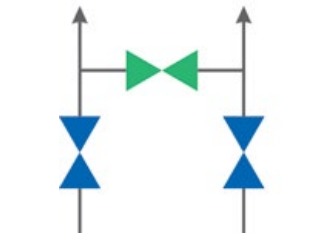
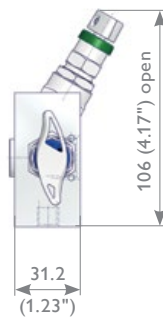
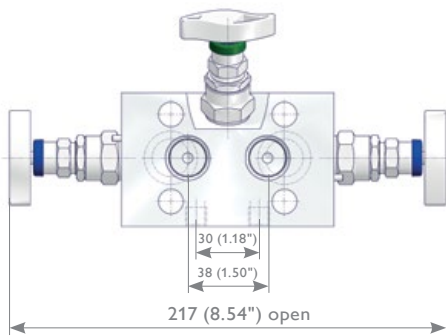

3 Valve Manifolds – Standard (Flanged x Flanged)

Without Vent Connection W3AB Type

With Vent Connection W3BB Type

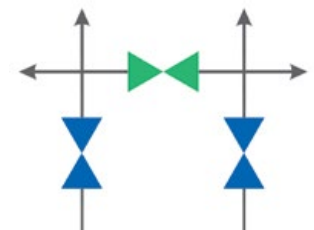
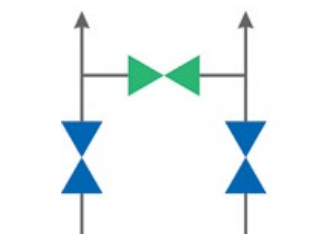
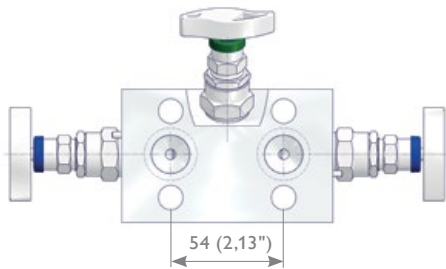

Mounting Bracket
AKM-L Type

See also Page 45.



Mounting Bracket
AKM-D Type

See also Page 44.

Direct Mount Manifolds

3 Valve Manifolds – Compact Design (Female x Flanged)

Without Vent Connection W3CA Type

With Vent Connection 1/4 NPT Female W3DA Type

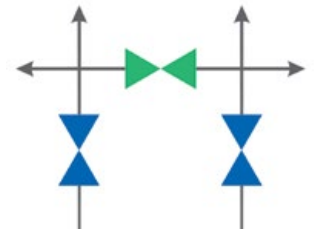
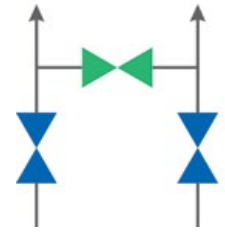
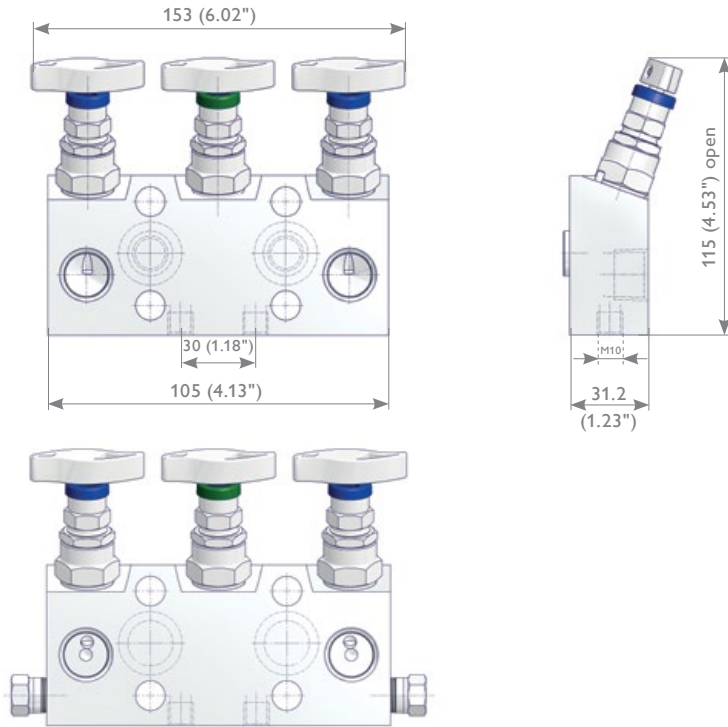

3 Valve Manifolds – Bottom Inlet Design (Female x Flanged)

W3EA Type

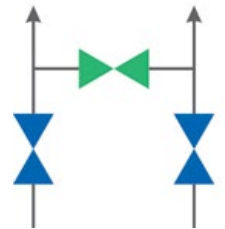
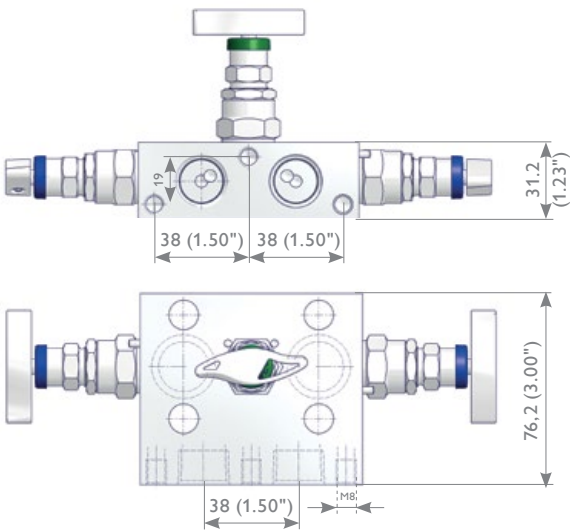

For Bottom Inlet Design only



For Compact Design



5 Valve Manifolds – Standard (Female x Flanged IEC 61518-A) W5AA Type

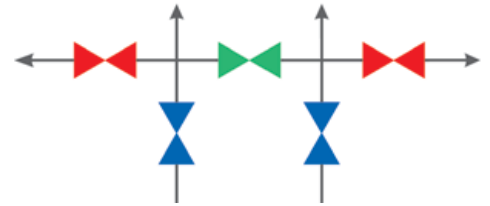
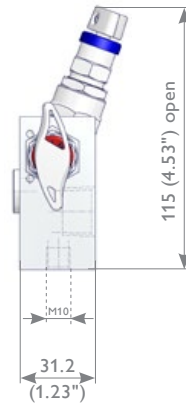
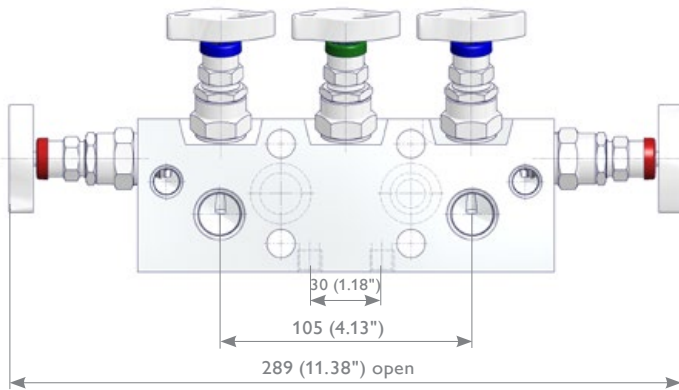

5 Valve Manifolds – Female x Flanged IEC 61518-B W5AA Type

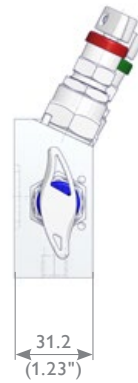
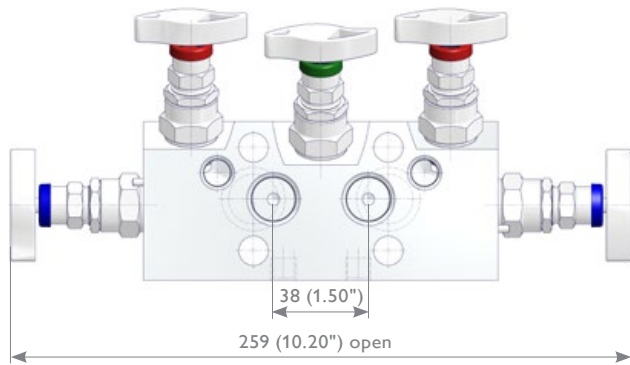

5 Valve Manifolds – Female x Flanged Vent Ports on Bottom Face W5GA Type

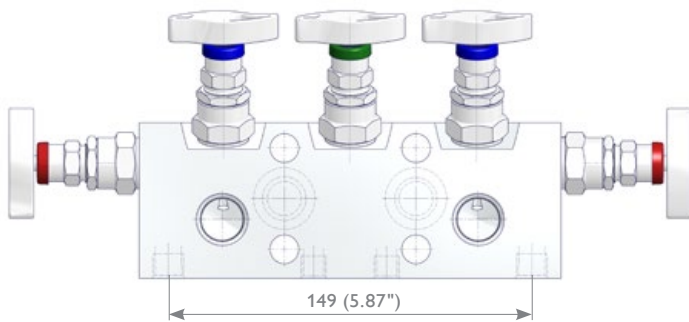

Illustrated type with IEC 61518-A connection

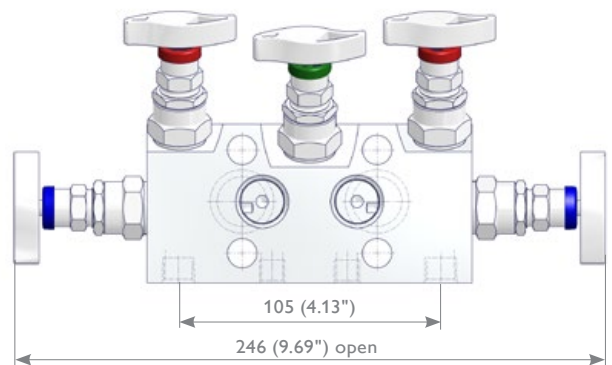

Illustrated type with IEC 61518-B connection

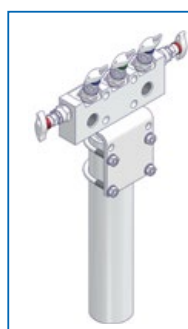

**Mounting Bracket
AKM-L Type**
See also Page 45.

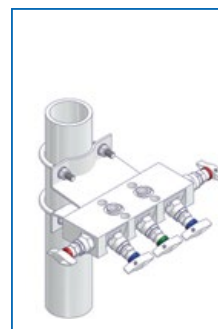

**Mounting Bracket
AKM-D Type**
See also Page 44.

Direct Mount Manifolds

5 Valve Manifolds – Compact Design (Female x Flanged) W5CA Type

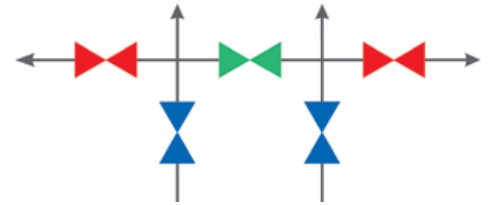
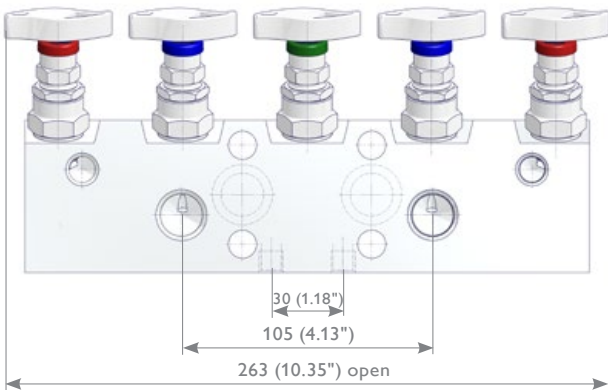

5 Valve Manifolds – Bottom Inlet Design (Female x Flanged) W5EA Type

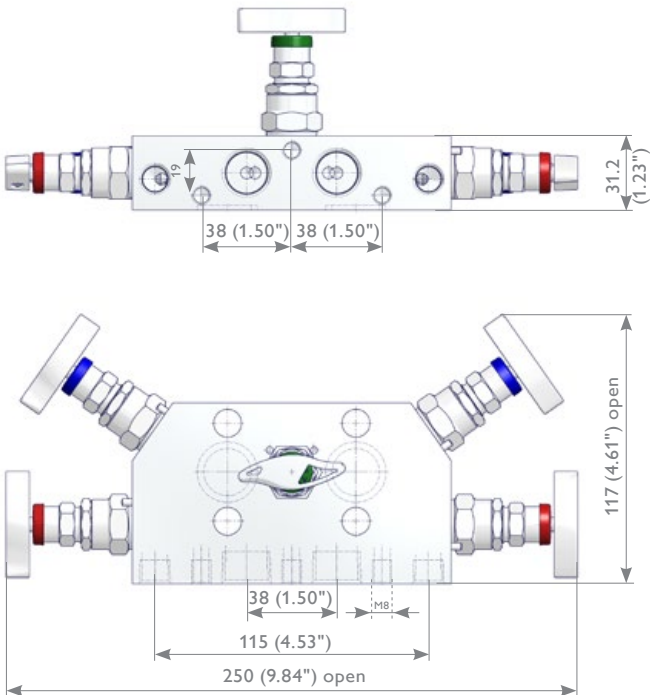

For Bottom Inlet Design only

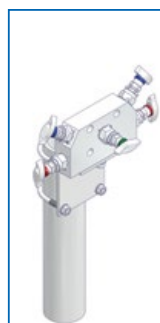

Mounting Bracket AKM-B Type

See also Page 44.

For Compact Design



Mounting Bracket AKM-D Type

See also Page 44.

Traditional Style Manifolds

- 2 Valve Manifolds – Female x Flanged → H2AA Type
- Flanged x Flanged → H2AB Type

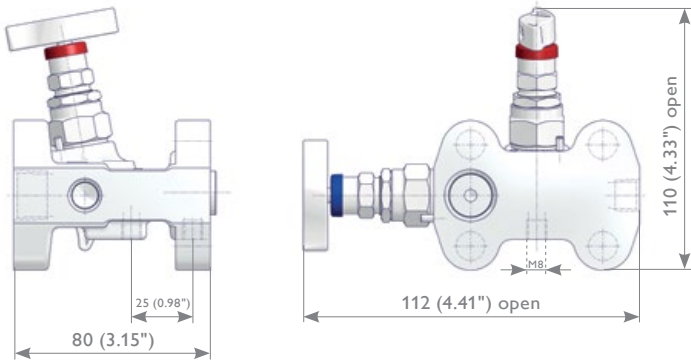

Illustrated Type H2AA

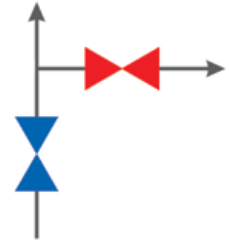

- 3 Valve Manifolds – Female x Flanged – Without Vent Connection → H3AA Type
- With Vent Connection 1/4 NPT Female → H3BA Type
- 3 Valve Manifolds – Flanged x Flanged – Without Vent Connection → H3AB Type
- With Vent Connection 1/4 NPT Female → H3BB Type

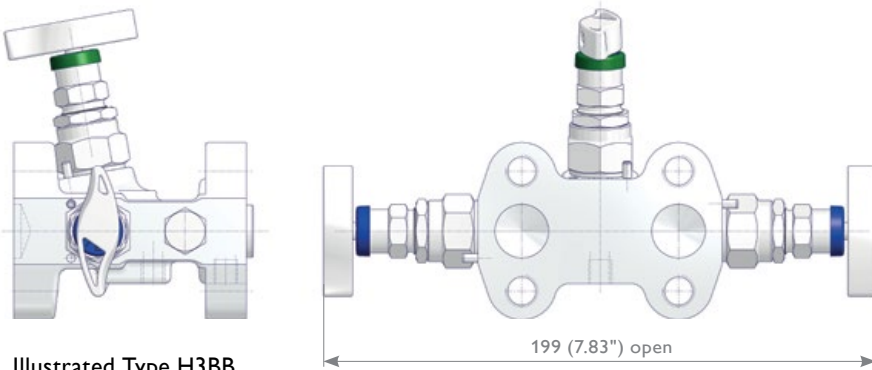

Illustrated Type H3BB

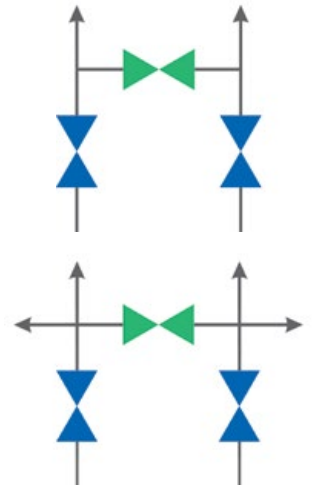

- 5 Valve Manifolds – Female x Flanged → H5AA Type
- Flanged x Flanged → H5AB Type

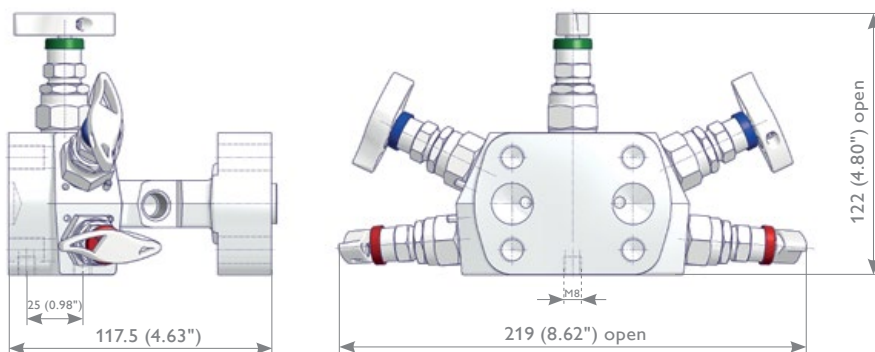

Illustrated Type H5AB

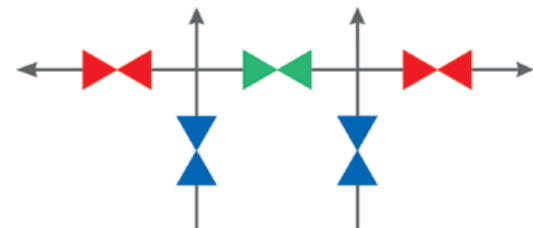

Mounting Bracket
AKM-H Type

See also Page 45.

Direct Mount Manifolds

Integral Manifolds for Rosemount 2051/3051 Coplanar™ Pressure Transmitter

Coplanar™ Style Manifolds

2 Valve Integral Manifolds W2RA Type

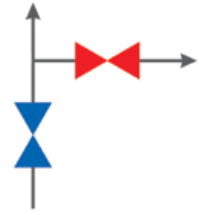
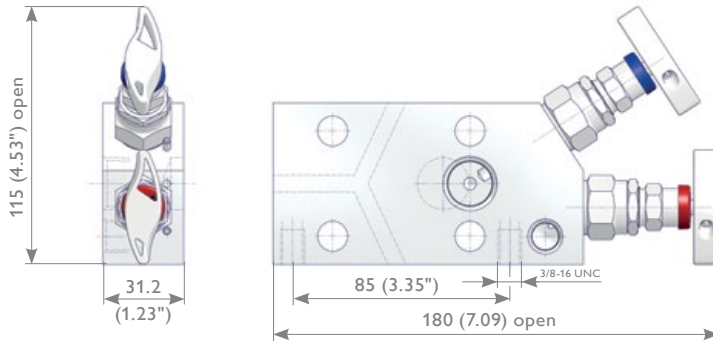

3 Valve Integral Manifolds

W3RA Type
Supplied as standard with vent valves – fitted

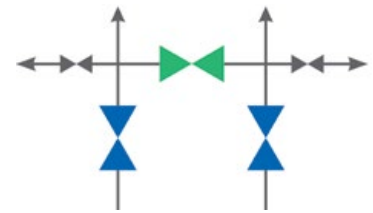
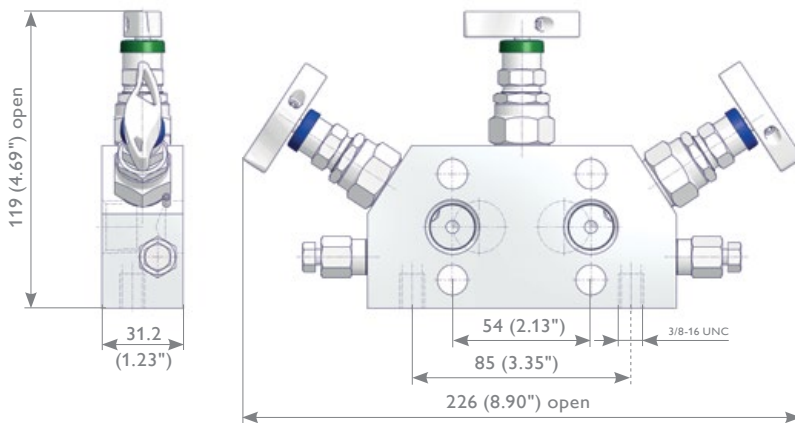

5 Valve Integral Manifolds

W5RA Type

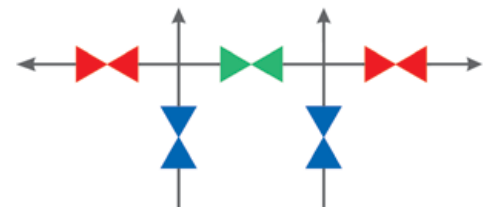
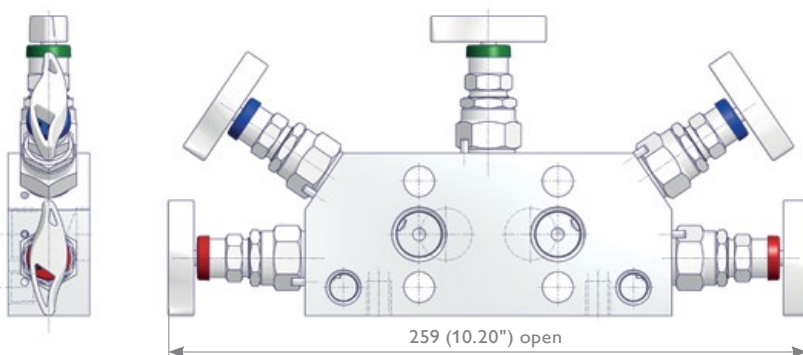

Mounting Bracket AKM-C Type

See also Page 44.

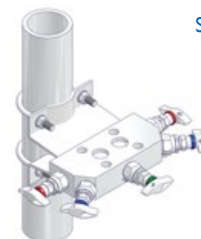

Traditional Style Integral Manifolds

Inlet with Flange Interface DIN EN 61518 / IEC 61518 and 1/4 NPT female only.

2 Valve Integral Manifolds

H2TB Type

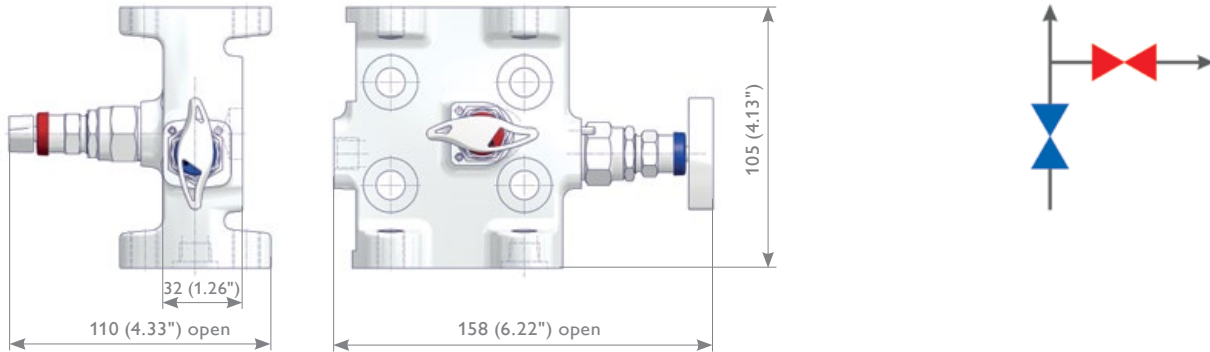

3 Valve Integral Manifolds

H3TB Type

Supplied as standard with vent valves – fitted

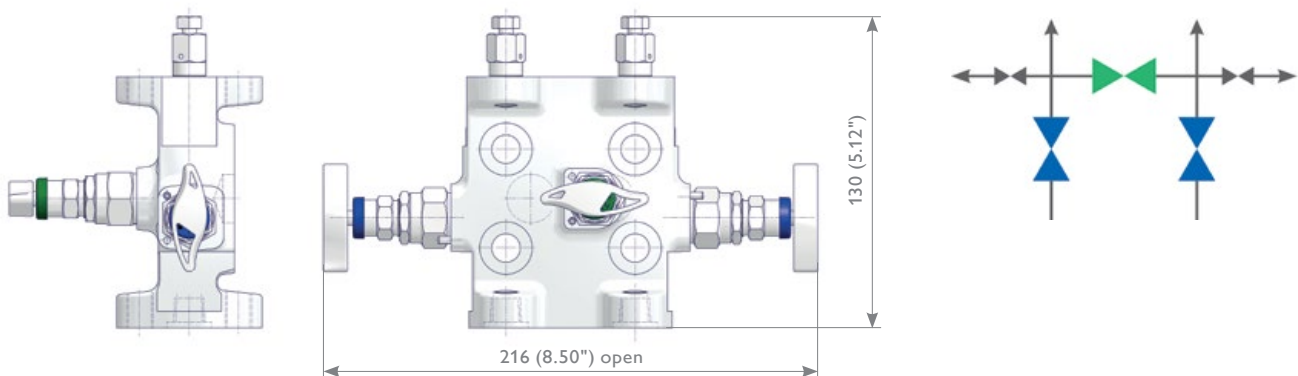

5 Valve Integral Manifolds

H5TB Type

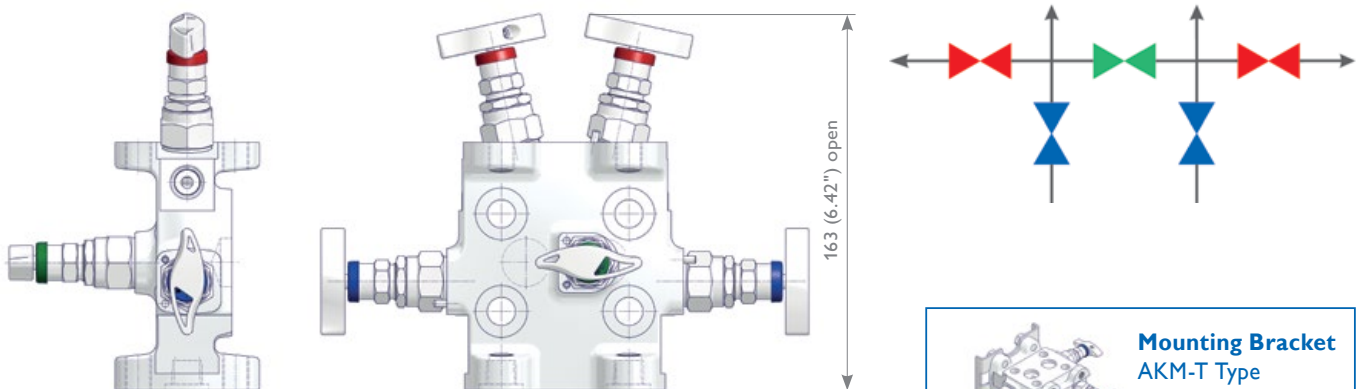

Direct Mount Manifolds

Ordering Information

	1	2	3	4	5	6	7	8	9	10	11	12	13	14	15	16	
	W	2	A	A	S	B	-	N	4	T	D	-	A	P	S		
W	Wafer Style Manifolds																
H	Traditional Style Manifolds																
Quantity Bonnets 2-5																	
Manifold Specifics																	
A	Standard - 2 Valve / 5 Valve Manifold with Vent Ports 1/4 NPT Female, 3 Valve Manifold without Vent Port																
B	Vent Ports 1/4 NPT Female - For 3 Valve Manifolds only																
C	Compact Design - 5 Valve Manifold with Vent Ports 1/4 NPT Female, 3 Valve Manifold without Vent Port																
D	Compact Design - 3 Valve Manifold with Vent Port 1/4 NPT Female																
E	Bottom Inlet Design																
G	Vent Ports on Bottom Face of the 5 Valve Manifold																
L	L-Shaped Bonnet Orientation																
R	Integral Manifold - Coplanar™ Style																
T	Integral Manifold - Traditional Style																
Inlet x Outlet Configuration																	
A	Female x Flanged																
B	Flanged x Flanged																
C	1/2 NPT with Tube Fitting x Flanged																
D	G 1/2 with Tube Fitting x Flanged																
Material																	
S	1.4401 / 1.4404 / 316 / 316L	F	Duplex UNS S31803		V	Alloy 625 UNS N06625											
M	Alloy 400 UNS N04400	D	Super Duplex UNS S32750		B	6Mo UNS S31254											
H	Alloy C-276 UNS N10276	2	Super Duplex UNS S32760		T	Titanium Grade 2											
Bonnet																	
A	PTFE	K	O-Ring FKM (FPM by ISO)														
B	Graphite	W	Carbon filled PTFE - TA-Luft														
D	ISO FE Series Type 1	2	Bellows sealed PN 100														
E	ISO FE Series Type 3	4	Bellows sealed PN 250														
Inlet																	
Thread Type			Fitting Type				Flange Interface										
N	NPT		C	Single Ferrule Tube Fitting			T	Flange Interface									
H	BSP Parallel (G) - DIN 3852		S	Swagelok													
			A	A-Lok													
			R	Rotarex													
Thread Size			Tube Fitting Sizes				Flange Interface										
2	1/4		4	12 resp. 12S			3	EN 61518 with 1/4 NPT Female - For Traditional Style Integral Manifolds									
4	1/2		5	14 resp. 14S			4	EN 61518 without 1/4 NPT									
			9	1/2"													
Outlet																	
Transmitter Interface																	
TD	DIN EN 61518-A																
TE	DIN EN 61518-B																
TF	Rosemount 2051/3051 Coplanar™ Pressure Transmitter																
Options - Specify in alphabetical order (digits first, then letters)																	
B	Cleaned and Lubricated for Oxygen Service - For PTFE Packing only																
F	PCTFE Soft Tip																
G	POM Soft Tip																
S	Stellite Valve Tip																
A	Vent Ports Plugged																
P	Power Piping ASME B31.1																
K	Arctic Operations (-55°C (-67°F)) - For PTFE Packing only																
M	Wetted Parts with 3.1 certificate																
Operation Options																	
T	Anti-Tamper Bonnet (Key to be ordered separately)																
R	Anti-Tamper Bonnet (1 Key supplied per Valve/Manifold)																
Q	AT-Key Lock Bonnet Design																
U	Padlock for Anti-Tamper Bonnet / AT-Key Lock Bonnet Design																
W	Stainless Steel Handwheel																
Accessory Kits for Manifold to Transmitter mounting according to DIN EN 61518 / IEC 61518																	
1	Hex Cap Screw 7/16-20 UNF, C.S., PTFE Seal Rings																
2	Hex Cap Screw 7/16-20 UNF, S.S., PTFE Seal Rings																
3	Hex Cap Screw 7/16-20 UNF, C.S., Graphite Seal Rings																
4	Hex Cap Screw 7/16-20 UNF, S.S., Graphite Seal Rings																
Mounting Bracket Kits																	
7	CST Mounting Bracket AKM-C or -D Type for 2" Pipe Mounting supplied separately - For Vertical Impulse Piping Installations*																
8	SST Mounting Bracket AKM-B, -C or -D Type for 2" Pipe Mounting supplied separately - For Vertical Impulse Piping Installations*																
9	SST Mounting Bracket AKM-H, -L, -T or -Y Type for 2" Pipe Mounting supplied separately - For Horizontal Impulse Piping Installations*																

* Relevant Bracket Type see Pages 28-35.

Wetted Parts according to a.m. material list are supplied according to NACE MR0175/MR0103 and ISO 15156 (latest issue) - except Titanium Grade 2.
Note: Not every configuration which can be created in the ordering information is feasible / available.

5 Valve Manifolds with Natural Gas Metering Pattern

5 Valve Manifolds with Natural Gas Metering Pattern

AS-Schneider is manufacturing various 5 Valve Manifold Designs with Natural Gas Metering Pattern for direct mounting to Differential Pressure Transmitters – either Transmitters with standard flange connection in accordance with IEC 61518 or alternatively to Rosemount 2051/3051 Coplanar™ Pressure Transmitters. The standard vent connection is 1/4 NPT female. Pipe plugs are not installed as standard. For plugged vent ports (factory installed) and other options see Page 38 – Ordering Information 5 Valve Manifolds with Natural Gas Metering Pattern. The standard test connection is 1/4 NPT female plugged. Accessories like Swivel Gauge Adaptors, Vent Valves etc. see Pages 44-49.

The dimensions shown apply only to the illustrated valves (1/2 NPT Threaded) – if you need the dimensions for your individual type or should you still not find your options at all please contact the factory.

5 Valve Manifolds - Instrument Connection acc. to. IEC 61518 5AAF Type

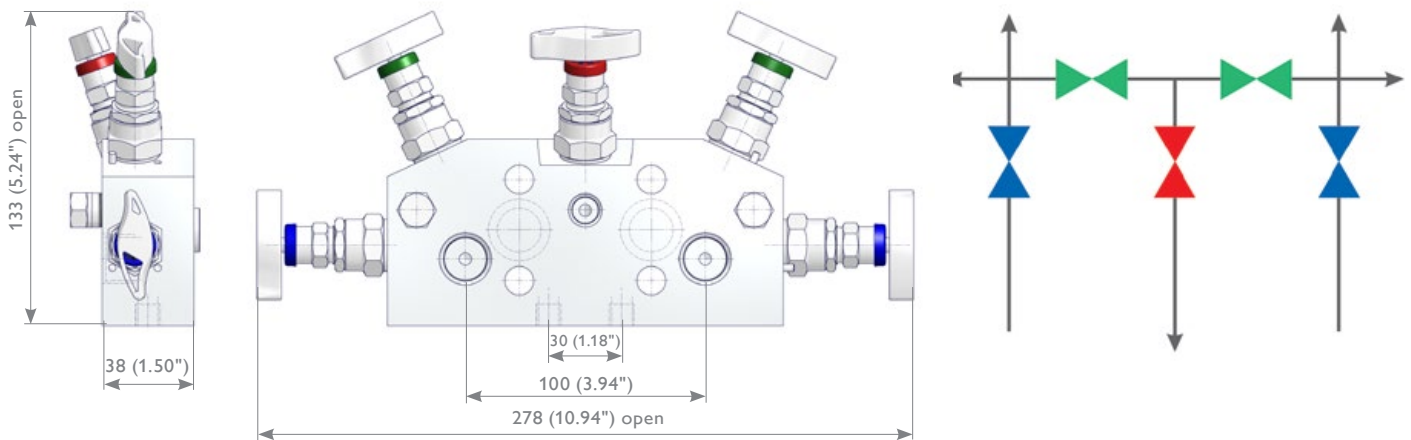

5 Valve Integral Manifolds - Instrument Connection for Rosemount 2051/3051 Coplanar™ Pressure Transmitter 5DAF Type

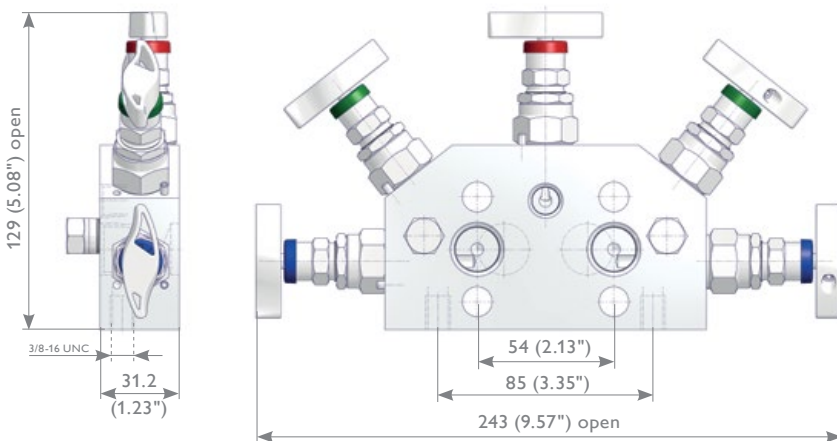

Manifold Type D (For Rosemount Coplanar™ Transmitter)



Manifold Type A (DIN EN 61518 / IEC 61518)



5 Valve Manifolds with Natural Gas Metering Pattern

Ordering Information

	1	2	3	4	5	6	7	8	9	10	11	12	13	14	15	16
	5	A	A	T	S	K	-	C	4	A	D	-	A	F	M	
5	5 Valve Manifolds with Natural Gas Metering Pattern															
Manifold Type																
A	Outlet DIN EN 61518-A - Test Connection 1/4 NPT - Vent Port 1/4 NPT - Inlet 1/2 NPT															
D	Outlet for Rosemount 2051/3051 Coplanar™ Pressure Transmitter - Test Connection 1/4 NPT - Vent Port 1/4 NPT - Inlet 1/2 NPT															
Vent Connection																
A	1/4 NPT Female	E	1/4 NPT with Single Ferrule Tube Fitting 12S													
C	1/4 NPT with Twin Ferrule Tube Fitting 12 mm															
Inlet																
F	Female															
T	Tube Fitting															
Material																
S	1.4401 / 1.4404 / 316 / 316L	F	Duplex UNS S31803	V	Alloy 625 UNS N06625											
M	Alloy 400 UNS N04400	D	Super Duplex UNS S32750	B	6Mo UNS S31254											
H	Alloy C-276 UNS N10276	2	Super Duplex UNS S32760	T	Titanium Grade 2											
Bonnet																
A	PTFE	K	O-Ring FKM (FPM by ISO)													
B	Graphite	W	Carbon filled PTFE - TA-Luft													
D	ISO FE Series Type 1	2	Bellows sealed PN 100													
E	ISO FE Series Type 3	4	Bellows sealed PN 250													
Inlet																
Thread Size																
N4	NPT	Fitting Type		Tube Fitting Sizes												
		C	Single Ferrule Tube Fitting	4	12 resp. 12S											
		S	Swagelok													
		A	A-Lok													
		R	Rotarex													
Test Connection																
A	1/4 NPT Female plugged															
Outlet																
Transmitter Interface																
D	DIN EN 61518-A															
F	Rosemount 2051/3051 Coplanar™ Pressure Transmitter															
Options - Specify in alphabetical order (digits first, then letters)																
B	Cleaned and Lubricated for Oxygen Service - For PTFE Packing only															
F	PCTFE Soft Tip															
G	POM Soft Tip															
S	Stellite Valve Tip															
A	Vent Ports Plugged															
P	Power Piping ASME B31.1															
K	Arctic Operations (-55°C (-67°F)) - For PTFE Packing only															
M	Wetted Parts with 3.1 certificate															
Operation Options																
T	Anti-Tamper Bonnet (Key to be ordered separately)															
R	Anti-Tamper Bonnet (1 Key supplied per Valve/Manifold)															
Q	AT-Key Lock Bonnet Design															
U	Padlock for Anti-Tamper Bonnet / AT-Key Lock Bonnet Design															
W	Stainless Steel Handwheel															
Accessory Kits for Manifold to Transmitter mounting according to DIN EN 61518																
1	Hex Cap Screw 7/16-20 UNF, C.S., PTFE Seal Rings															
2	Hex Cap Screw 7/16-20 UNF, S.S., PTFE Seal Rings															
3	Hex Cap Screw 7/16-20 UNF, C.S., Graphite Seal Rings															
4	Hex Cap Screw 7/16-20 UNF, S.S., Graphite Seal Rings															
Mounting Bracket Kits																
7	CST Mounting Bracket AKM-C or -D Type for 2" Pipe Mounting supplied separately - For Vertical Impulse Piping Installations															
8	SST Mounting Bracket AKM-B, -C or -D Type for 2" Pipe Mounting supplied separately - For Vertical Impulse Piping Installations															

Wetted Parts according to a.m. material list are supplied according to NACE MR0175/MR0103 and ISO 15156 (latest issue) - except Titanium Grade 2.

Note: Not every configuration which can be created in the ordering information is feasible / available.

Enclosure Manifolds (2, 3 and 5 Valve Manifolds)

AS-Schneider Enclosure Manifolds are manufactured for applications that require the transmitter to be mounted in an enclosure for environmental protection. The standard vent connection is 1/4 NPT female. Pipe plugs are not installed as standard. For plugged vent ports (factory installed) and other options see page 41– Ordering Information Enclosure Manifolds.

The dimensions shown apply only to the illustrated valves (1/2 NPT Threaded) – if you need the dimensions for your individual type or should you still not find your options at all please contact the factory.

2 Valve Manifolds

Transmitter Connection

Acc. to DIN EN 61518
E2AA Type

1/2 NPT Female
E2AC Type

Swivel Nut
E2AE Type

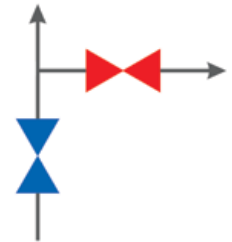
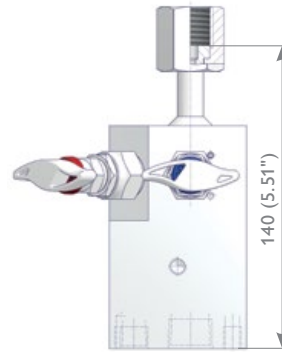
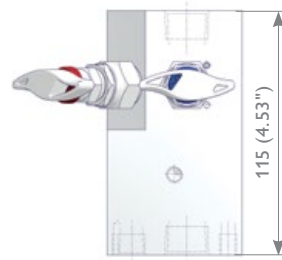
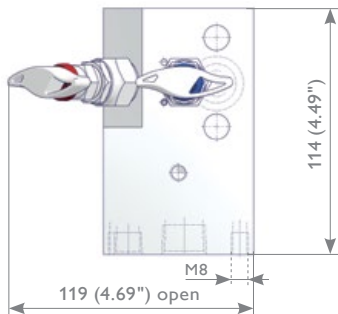
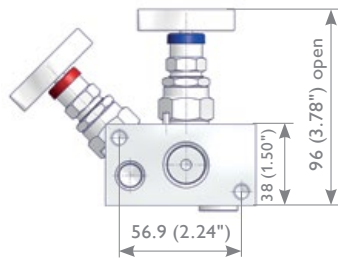

3 Valve Manifolds – Female x Flanged E3AA Type

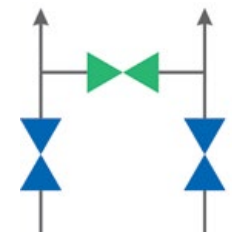
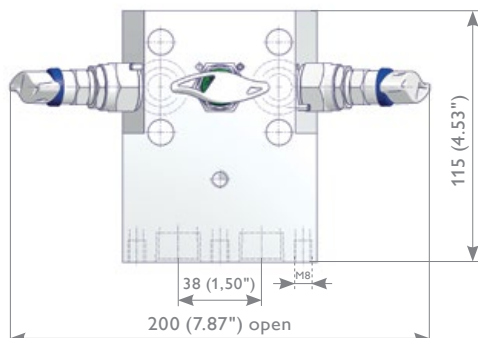
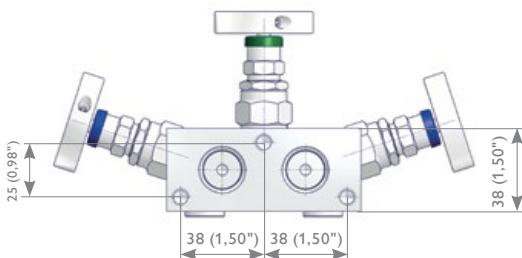

Enclosure Manifolds

5 Valve Manifolds – Female x Flanged

- Standard Flow Schematic → E5AA Type
- Upstream Vent Schematic → E5UA Type

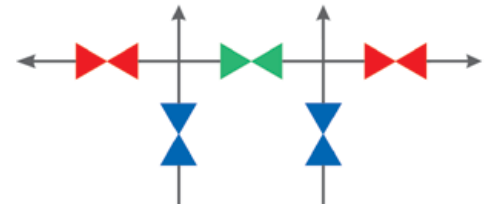
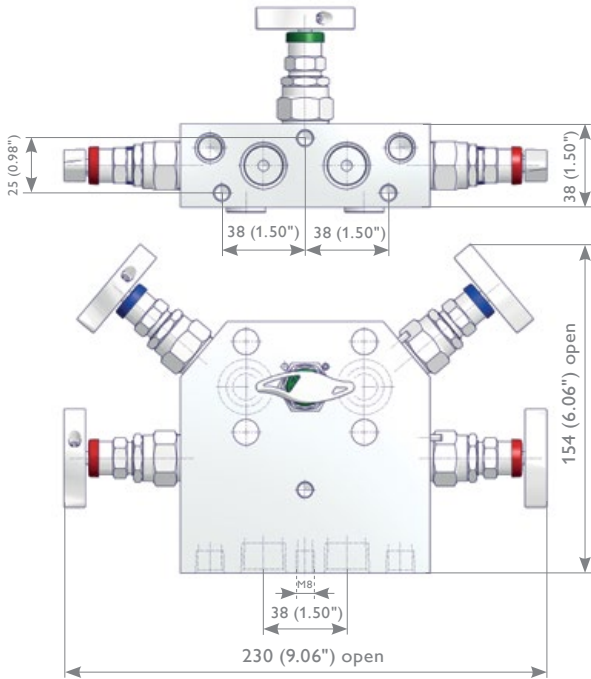

E5UA Type

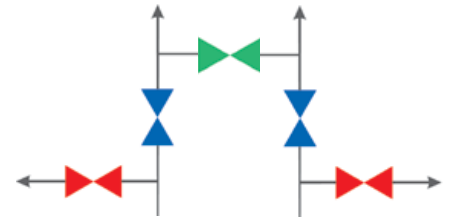

Enclosure Systems

AS-Schneider Enclosure Systems have been developed to provide a weatherproof barrier for every type of installation. Modern process measurement instrumentation needs protection not only from the effects of sun, rain, frost, aggressive atmosphere or dirt but also from accidental damage or unauthorized access.

The Enclosure Manifolds allow direct mounting to a baseplate or a back plate of the enclosures. A lot of accessories such as electrical heating systems, thermostats, junction boxes, grommets and pipestands are available. Designed and fitted out to customer's specifications AS-Schneider is supplying the complete solution - enclosure, manifolds and all accessories needed – for an easy on-site installation. For more details please contact the factory.

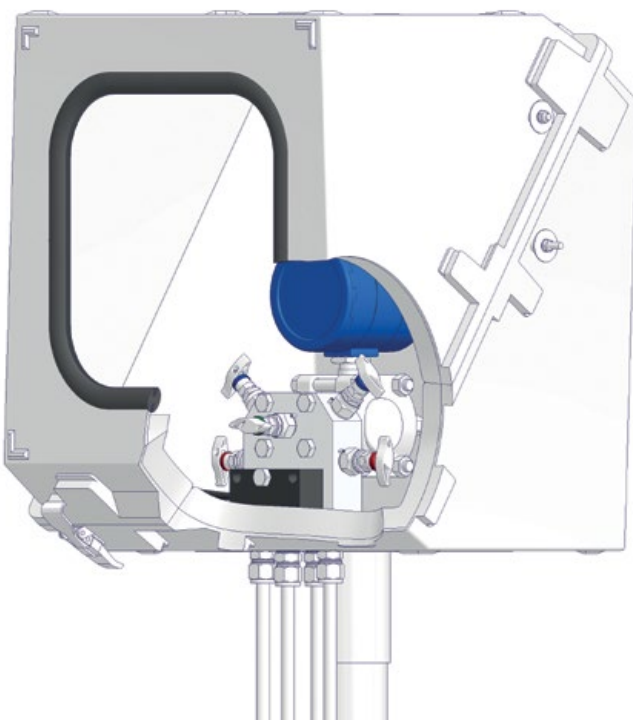

Manifold Mounting Options



Ordering Information

		1	2	3	4	5	6	7	8	9	10	11	12	13	14	15	16
		E	5	A	A	S	A	-	N	4	T	D	-	R			
E	Enclosure Manifolds																
	Quantity Bonnets 2-5																
	Manifold Specifics																
A	Standard - 2 Valve / 5 Valve Manifold with Vent Ports 1/4 NPT Female, 3 Valve Manifold without Vent Port																
B	Vent Ports 1/4 NPT Female - For 3 Valve Manifolds only																
C	Vent 1/4 NPT with Tube Fitting 12 mm																
U	Upstream Vent Type (5 Valve Manifold only)																
	Inlet x Outlet Configuration																
A	Female x Flanged	D	1/2 NPT with Tube Fitting x Female														
B	1/2 NPT with Tube Fitting x Flanged	E	Female x Swivel Nut														
C	Female x Female	F	1/2 NPT with Tube Fitting x Swivel Nut														
	Material																
S	1.4401 / 1.4404 / 316 / 316L	F	Duplex UNS S31803	V	Alloy 625 UNS N06625												
M	Alloy 400 UNS N04400	D	Super Duplex UNS S32750	B	6Mo UNS S31254												
H	Alloy C-276 UNS N10276	2	Super Duplex UNS S32760	T	Titanium Grade 2												
	Bonnet																
A	PTFE	K	O-Ring FKM (FPM by ISO)														
B	Graphite	W	Carbon filled PTFE - TA-Luft														
D	ISO FE Series Type 1	2	Bellows sealed PN 100														
E	ISO FE Series Type 3	4	Bellows sealed PN 250														
	Inlet																
	Thread Type																
N	NPT	C	Single Ferrule Tube Fitting														
		S	Swagelok														
		A	A-Lok														
		R	Rotarex														
	Thread Size																
2	1/4	4	12 resp. 12S														
4	1/2	5	14 resp. 14S														
		9	1/2"														
	Outlet																
	Thread Size - 2 Valve Manifolds only																
N4	1/2 NPT Female	TD	DIN EN 61518-A														
G4	G 1/2 Swivel Nut	TE	DIN EN 61518-B														
M4	M20x1.5 Swivel Nut	TF	Rosemount 2051/3051 Coplanar™ Pressure Transmitter														
	Options - Specify in alphabetical order (digits first, then letters)																
B	Cleaned and Lubricated for Oxygen Service - For PTFE Packing only																
F	PCTFE Soft Tip																
G	POM Soft Tip																
S	Stellite Valve Tip																
A	Vent Ports Plugged																
P	Power Piping ASME B31.1																
K	Arctic Operations (-55°C (-67°F)) - For PTFE Packing only																
M	Wetted Parts with 3.1 certificate																
	Operation Options																
T	Anti-Tamper Bonnet (Key to be ordered separately)																
R	Anti-Tamper Bonnet (1 Key supplied per Valve/Manifold)																
Q	AT-Key Lock Bonnet Design																
U	Padlock for Anti-Tamper Bonnet / AT-Key Lock Bonnet Design																
W	Stainless Steel Handwheel																
	Accessory Kits for Manifold to Transmitter mounting according to DIN EN 61518 / IEC 61518																
1	Hex Cap Screw 7/16-20 UNF, C.S., PTFE Seal Rings																
2	Hex Cap Screw 7/16-20 UNF, S.S., PTFE Seal Rings																
3	Hex Cap Screw 7/16-20 UNF, C.S., Graphite Seal Rings																
4	Hex Cap Screw 7/16-20 UNF, S.S., Graphite Seal Rings																

Wetted Parts according to a.m. material list are supplied according to NACE MR0175/MR0103 and ISO 15156 (latest issue) - except Titanium Grade 2.

Note: Not every configuration which can be created in the ordering information is feasible / available.

3 and 5 Valve Manifolds for Differential Pressure Gauges

Differential Pressure Gauge Manifolds

AS-Schneider Manifolds for Differential Pressure Gauges are available with a center to center distance of 37 mm or 54 mm as standard. The instrument connections are supplied with a Swivel Nut or a Swivel Male Connection. The standard vent connection is 1/4 NPT female. Pipe plugs are not installed as standard. For plugged vent ports (factory installed) and other options see Page 43 – Ordering Information Differential Pressure Gauge Manifolds. Accessories like Swivel Gauge Adaptors, Vent Valves etc. see Pages 44-48.

The dimensions shown apply only to the illustrated valves (G 3/8 Threaded) – if you need the dimensions for your individual type or should you still not find your options at all please contact the factory.

3 Valve Manifolds for Differential Pressure Gauges

D3 Type

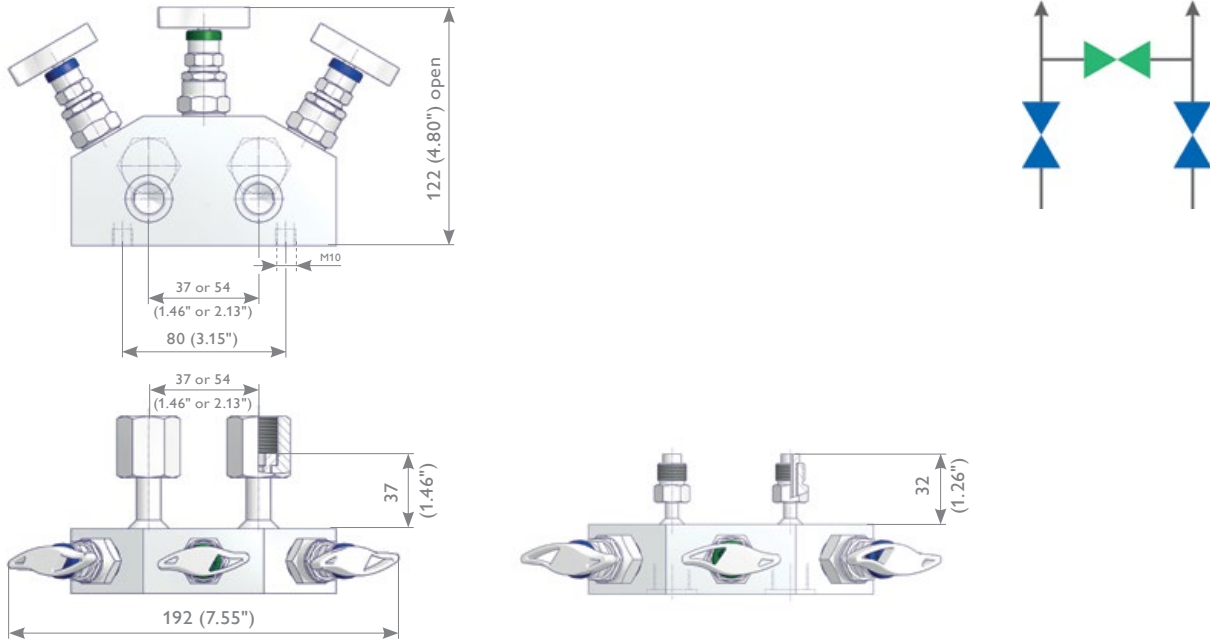

5 Valve Manifolds for Differential Pressure Gauges

D5 Type

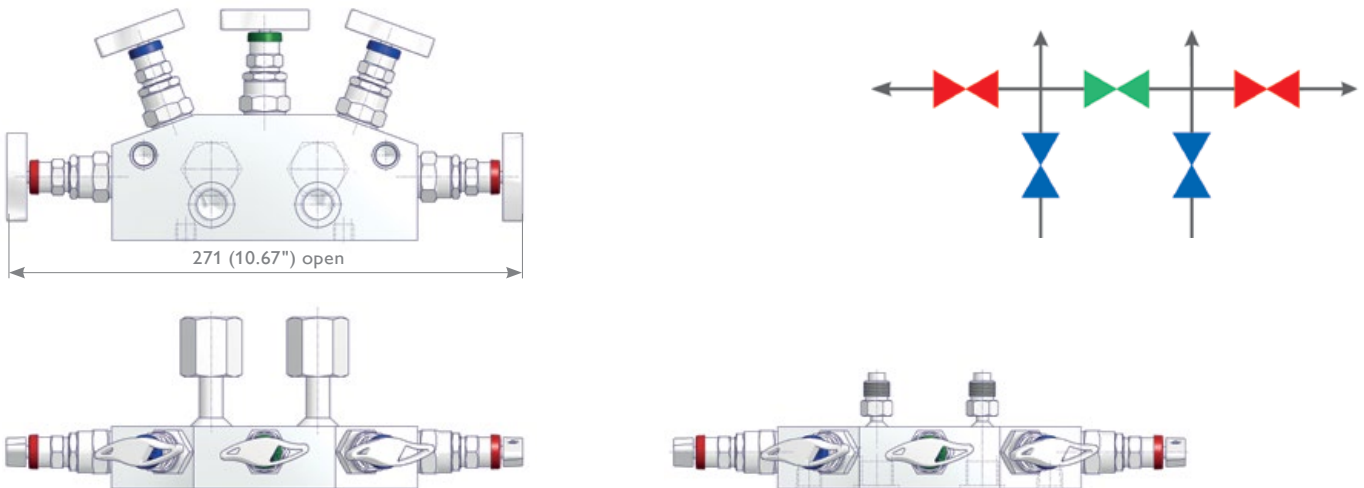

3 and 5 Valve Manifolds for Differential Pressure Gauges

Ordering Information

	1	2	3	4	5	6	7	8	9	10	11	12	13	14	15	16	
D	D	3	B	B	S	A	-	H	3	G	2	-	M	8			
D Differential Pressure Gauge Manifolds																	
Quantity Bonnets - 3 or 5																	
Manifold Specifics																	
Thread Size Inlet x Distance from Center to Center for Differential Pressure Gauge																	
A	G 3/8 x 37 mm				C	1/2 NPT x 37 mm											
B	G 3/8 x 54 mm				D	1/2 NPT x 54 mm											
Inlet x Outlet Configuration																	
A	Female x Swivel Nut				D	Tube Fitting x Swivel Male											
B	Female x Swivel Male				E	Male Connector x Swivel Nut											
C	Tube Fitting x Swivel Nut				F	Male Connector x Swivel Male											
Material																	
S	1.4401 / 1.4404 / 316 / 316L				F	Duplex UNS S31803				V	Alloy 625 UNS N06625						
M	Alloy 400 UNS N04400				D	Super Duplex UNS S32750				B	6Mo UNS S31254						
H	Alloy C-276 UNS N10276				2	Super Duplex UNS S32760				T	Titanium Grade 2						
Bonnet																	
A	PTFE				K	O-Ring FKM (FPM by ISO)											
B	Graphite				W	Carbon filled PTFE - TA-Luft											
D	ISO FE Series Type 1				2	Bellows sealed PN 100											
E	ISO FE Series Type 3				4	Bellows sealed PN 250											
Inlet																	
Thread Type																	
N4	1/2 NPT Female				C	Single Ferrule Tube Fitting				4	12 resp. 12S						
H3	G 3/8 Female - DIN 3852				S	Swagelok				5	14 resp. 14S						
G4	G 1/2 Male - EN 837-1				A	A-Lok				9	1/2"						
				R	Rotarex												
Outlet																	
Thread Type																	
G2	G 1/4 Swivel Male																
G4	G 1/2 Swivel Nut or Swivel Male																
M4	M20 x 1.5 Swivel Nut																
Options - Specify in alphabetical order (digits first, then letters)																	
B	Cleaned and Lubricated for Oxygen Service - For PTFE Packing only																
F	PCTFE Soft Tip																
G	POM Soft Tip																
S	Stellite Valve Tip																
A	Vent Ports Plugged																
H	10,000 psi (PN 700)																
P	Power Piping ASME B31.1																
K	Arctic Operations (-55°C (-67°F)) - For PTFE Packing only																
M	Wetted Parts with 3.1 certificate																
Operation Options																	
T	Anti-Tamper Bonnet (Key to be ordered separately)																
R	Anti-Tamper Bonnet (1 Key supplied per Valve/Manifold)																
Q	AT-Key Lock Bonnet Design																
U	Padlock for Anti-Tamper Bonnet / AT-Key Lock Bonnet Design																
W	Stainless Steel Handwheel																
Accessory Kits																	
7	CST Mounting Bracket AKM-D Type for 2" Pipe Mounting supplied separately - For Vertical Impulse Piping Installations																
8	SST Mounting Bracket AKM-D Type for 2" Pipe Mounting supplied separately - For Vertical Impulse Piping Installations																

Wetted Parts according to a.m. material list are supplied according to NACE MR0175/MR0103 and ISO 15156 (latest issue) - except Titanium Grade 2.

Note: Not every configuration which can be created in the ordering information is feasible / available.

Accessories – Mounting Bracket Kits

Mounting Bracket Kits for Vertical Impulse Piping Installations

AKM-S Type

For Valves and Manifolds with 1 1/4" Square Valve Body (Type H, G, M and S)

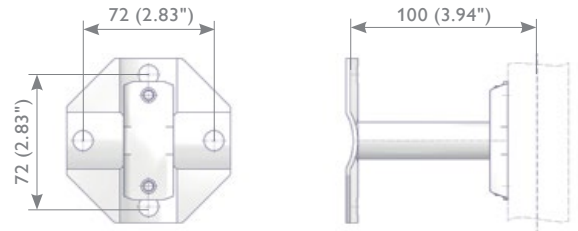
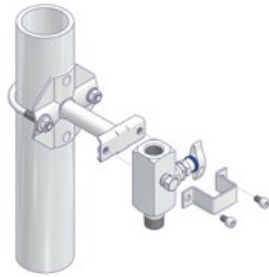

AKM-R Type

For Manifolds with 1 1/4" Flat Body (Type P and R)

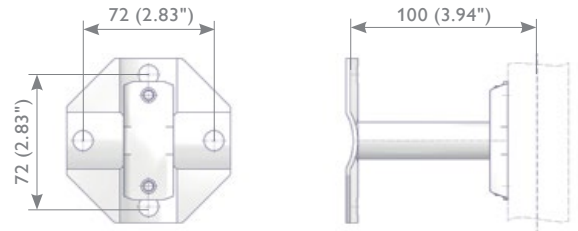
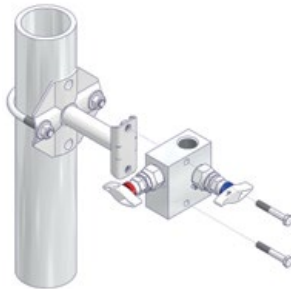

AKM-D Type and AKM-C Type

For Manifolds Type D, W and 5

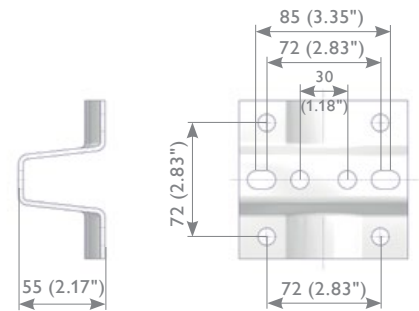
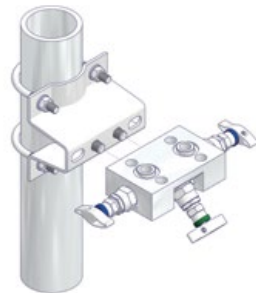

AKM-B Type

For Wafer Style Manifolds with Bottom Inlet Design

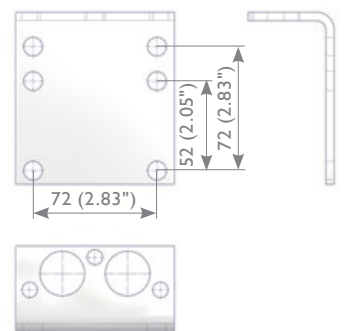
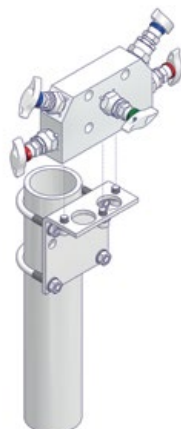

Mounting Bracket Kit

Mounting Bracket Kits on Page 44 and 45 are containing:

- Mounting Bracket
- 'U' Bolts*
- Washers – 8.4*
- Hexagon Nuts M8*
- Screws and Washers for Mounting the Manifold to the Bracket – if applicable

* Amount depending on bracket type. See illustrations.

Accessories – Mounting Bracket Kits

Mounting Bracket Kits for Horizontal Impulse Piping Installations

AKM-L Type

For Manifolds Type W and 5

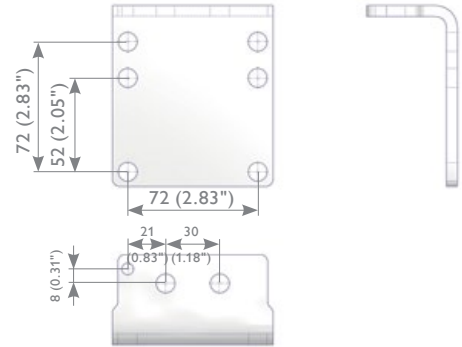

AKM-Y Type

For Direct Mount 2 Valve Manifolds with L-Shaped Bonnet Orientation

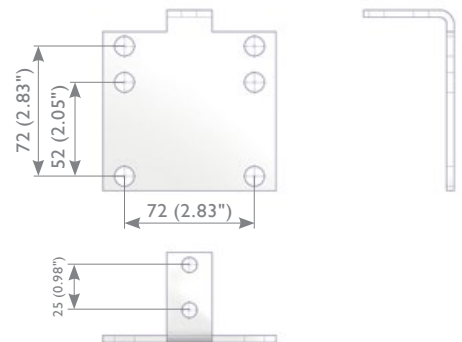

AKM-H Type

For Manifolds Type H

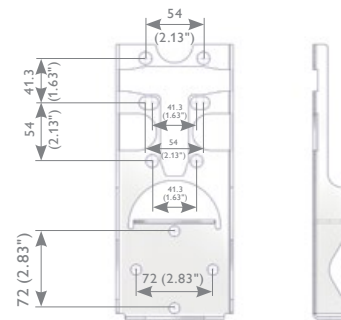

AKM-T Type

For Integral Manifolds – Traditional Style

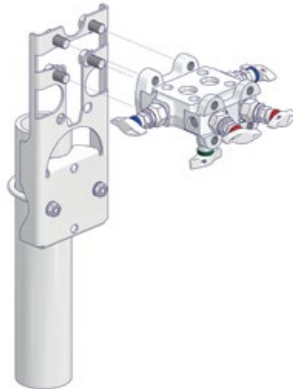

Ordering Information

1	2	3	4	5	6	7
A	K	M	-	S	P	S

AKM Mounting Bracket Kits

Mounting Bracket incl. screws for mounting the bracket to the manifold (if applicable)

S	Valves and Manifolds with 1 1/4" Square Valve Body (Type H, G, M and S)
R	Manifolds with 1 1/4" Flat Body (Type P and R)
D	Manifolds Type D, W and 5
L	L-Type Bracket for Manifolds Type W
H	Manifolds Type H (not for Integral Manifolds Traditional Style)
Y	L-Type Bracket for 2 Valve Manifolds with L-Shaped Bonnet Orientation
B	Wafer Style Manifolds with Bottom Inlet Design
C	Integral Manifolds - Coplanar™ Style
T	Integral Manifolds - Traditional Style

Mounting Method

P	2" Pipe Mounting - incl. 'U' Bolt, Nuts and Washers
---	---

Material

C	Carbon Steel zinc plated (only available Mounting Bracket Kit AKM-D and AKM-C)
S	Stainless Steel 300 Series

Accessories – Manifold to Transmitter Mounting acc. to DIN EN 61518

Accessory Kits for Manifold to Transmitter Mounting according to DIN EN 61518 / IEC 61518

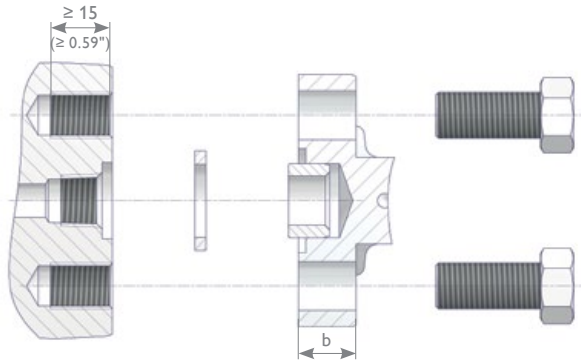

b = Depending on manifold thickness

Ordering Information

	1	2	3	4	5	6	7	8	9	10	11	12	13	14	15	16
	A	K	S	-	H	U	4	C	-	P	A	F	4	4		
AKS Transmitter Mounting Kit																
Type of Screw																
H	Hex Cap Screw															
S	Socket Head Cap Screw															
Thread Size																
U	7/16-20 UNF															
M	M10 - Max. Operating Pressure 160 bar (2,320 psi) - Screws supplied with Washer															
Number of Screws and Seal Rings																
2	2 Screws and 1 Seal Ring For 2 Valve Manifolds and Oval Flanges															
4	4 Screws and 2 Seal rings For Differential Pressure Manifolds															
5	4 Screws and 1 Seal Ring For 2 Valve Manifolds Type H2A - For Gauge/Absolute Pressure Transmitters															
8	4 Screws and 4 Seal Rings For Wafer Style Manifolds together with Oval Flanges - Screw Length 2 3/4"															
Material*																
C	Carbon Steel UNF Thread: Hex Cap Screw ASTM A449 - Type 1 Socket Head Cap Screw ASTM A574 Metric Thread: ISO 898-1 Class 8.8															
S	304 Stainless Steel UNF Thread: ASTM A193 B8 Class 2 Metric Thread: ISO 3506 A2-70															
M	316 Stainless Steel UNF Thread: ASTM A193 B8M Class 2 Metric Thread: ISO 3506 A4-70															
Seal Ring																
DIN EN 61518 Type A								DIN EN 61518 Type B								
PA	PTFE							PB	PTFE							
GA	Graphite							GB	Graphite							
FA	O-Ring FPM (FKM by ASTM)															
Screw Length																
UNF Thread								Metric Thread								
F25	1"							M25	25 mm							
F38	1 1/2"							M40	40 mm							
F44	1 3/4"							M45	45 mm							
F51	2"							M50	50 mm							
F70	2 3/4" (For Wafer Style Manifold c/w Oval Flange)															
F76	3" (For Rosemount 2051/3051 Coplanar™ Pressure Transmitter)															
Option																
B	Cleaned for Oxygen Service (only for PTFE Seal Ring → Carbon filled PTFE)															

 * IEC 61518 calls for the mentioned mechanical properties (for example B8 Class 2) because the flange connection is designed for high pressure service (up to 6,000 psi) and high temperature service. The usage of screws without the defined mechanical properties is critical and may lead to a sudden component failure which could cause a fatal accident!

Accessories – Pipe Plugs, Vent Valves, Adaptors

Vent Valves, Pipe Plugs and Pipe Fittings

Vent Valve
VS Type



Vent Valve
VT Type

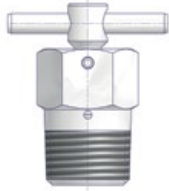

Pipe Plug
PP Type



Female to Male Adaptor
FM Type

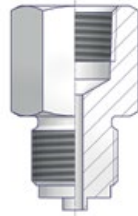

Hex Nipple
HN Type



Ordering Information - Pipe Plugs and Vent Valves

		1	2	3	5	6	7	8	9	10	11
		V	S	M	S	-	N	4	-	M	
PP	Pipe Plug										
VS	Vent Valve with Bleed Screw										
VT	Vent Valve with T Handle										
Connection											
M	Male										
Material											
S	1.4401 / 1.4404 / 316 / 316L	F	Duplex UNS S31803	V	Alloy 625 UNS N06625						
M	Alloy 400 UNS N04400	D	Super Duplex UNS S32750	B	6Mo UNS S31254						
H	Alloy C-276 UNS N10276	2	Super Duplex UNS S32760	T	Titanium Grade 2						
Threaded Connection											
N2	1/4 NPT										
N3	3/8 NPT										
N4	1/2 NPT										
Options - Specify in alphabetical order (digits first, then letters)											
B	Cleaned for Oxygen Service										
M	Wetted Parts with 3.1 certificate										

Wetted Parts according to a.m. material list are supplied according to NACE MR0175/MR0103 and ISO 15156 (latest issue) - except Titanium Grade 2

Ordering Information - Pipe Fittings

		1	2	3	4	5	6	7	8	9	10	11 - 16
		F	M	S	-	M	4	N	4	-	M	
FM	Female to Male Adaptor											
HN	Hex Nipple - Connections to be specified in alphabetical resp. ascending order. For example HNS-G4N4 (and not HNS-N4G4) resp. HNS-G2G4 (and not G4G2).											
Material												
S	1.4401 / 1.4404 / 316 / 316L	F	Duplex UNS S31803	V	Alloy 625 UNS N06625							
M	Alloy 400 UNS N04400	D	Super Duplex UNS S32750	B	6Mo UNS S31254							
H	Alloy C-276 UNS N10276	2	Super Duplex UNS S32760	T	Titanium Grade 2							
Inlet - FM Type Female Thread												
Thread Type		Inch Size		Metric Size								
N	NPT	2	1/4	4	M20x1.5							
G	BSP Parallel (G) - EN 837-1	4	1/2									
M	Metric similar to EN 837-1											
Outlet												
Thread Type		Inch Size		Metric Size								
N	NPT	2	1/4	4	M20x1.5							
G	BSP Parallel (G) - EN 837-1	4	1/2									
M	Metric similar to EN 837-1											
Options - Specify in alphabetical order (digits first, then letters)												
B	Cleaned for Oxygen Service											
M	3.1 certificate											

Part according to a.m. material list is supplied according to NACE MR0175/MR0103 and ISO 15156 (latest issue) - except Titanium Grade 2.

Accessories – Swivel Gauge Adaptors

Swivel Gauge Adaptors

The Swivel Gauge Adaptors enable the easy positioning of the pressure instrument in any direction through 360°. The dimensions shown apply only to the illustrated components – if you need the dimensions for your individual type please contact the factory.

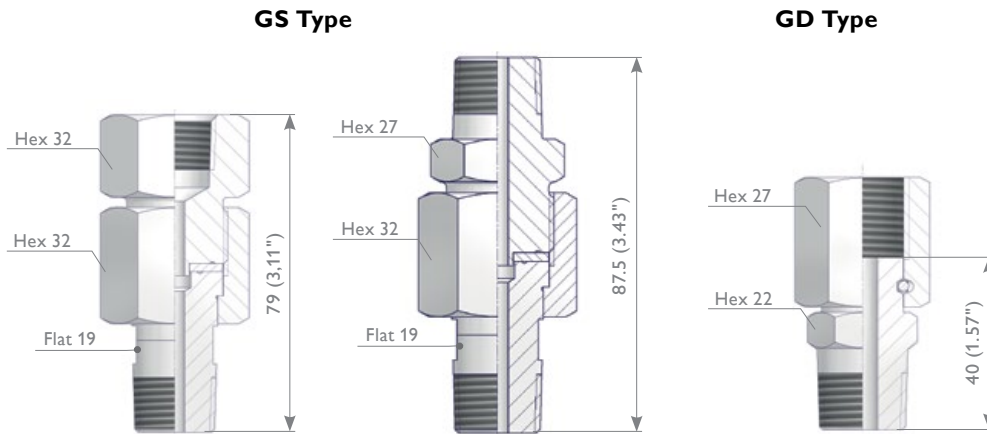

Ordering Information - Swivel Gauge Adaptors

				1	2	3	4	5	6	7	8	9	10	11	12	13	14	15	16
				G	S	-	M	M	S	P	-	N	4	N	4	-	B		
GS	Swivel Gauge Adaptors - Screwed Design																		
GD	Swivel Gauge Adaptors - Wire Design																		
Inlet																			
M	Male	F	Female																
Outlet																			
M	Male	S	Swivel Nut (GD Type)																
F	Female																		
Material																			
S	1.4401 / 1.4404 / 316 / 316L	F	Duplex UNS S31803	V	Alloy 625 UNS N06625														
M	Alloy 400 UNS N04400	D	Super Duplex UNS S32750	B	6Mo UNS S31254														
H	Alloy C-276 UNS N10276	2	Super Duplex UNS S32760	T	Titanium Grade 2														
Seal Ring																			
P	PTFE (only GS Type*)																		
S	Same Material as threaded components (only GS Type*)																		
A	No Seal Ring required (only GD Type)																		
Inlet																			
Thread Type		Thread Size																	
N	NPT	2	1/4																
G	BSP Parallel (G) - EN 837-1	4	1/2																
H	BSP Parallel (G) - DIN 3852	6	3/4																
Outlet																			
Thread Type		Thread Size																	
N	NPT	2	1/4																
G	BSP Parallel (G) - EN 837-1	4	1/2																
		6	3/4																
Options - Specify in alphabetical order (digits first, then letters)																			
B	Cleaned for Oxygen Service																		
H	10,000 psi (PN 700)																		
M	Wetted Parts with 3.1 certificate																		

* Only GS Type: Standard at 1/4 and 1/2 NPT Threaded Options.

Wetted Parts according to a.m. material list are supplied according to NACE MR0175/MR0103 and ISO 15156 (latest issue) - except Titanium Grade 2.

Accessories – Oval Flanges, Anti-Tamper Key

Oval Flanges KF Type

Transmitter Interface EN 61518-A Code TD

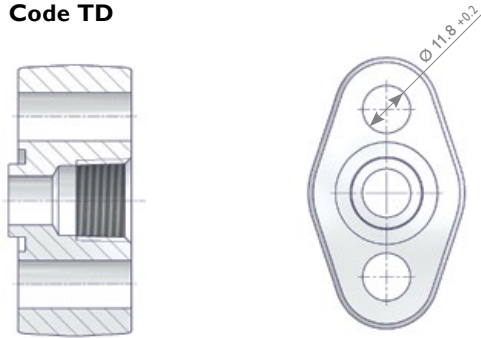

Transmitter Interface EN 61518 Code T4

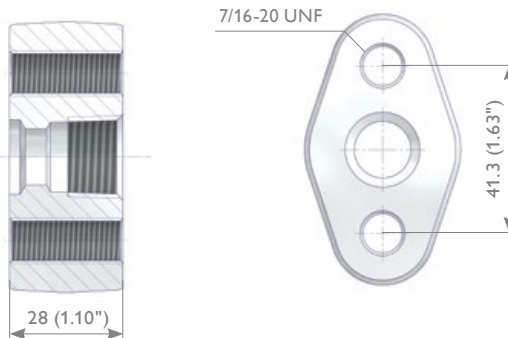

Ordering Information - Oval Flange (Kidney Flange, Futbol)

		1	2	3	4	5	6	7	8	9	10	11	12
		K	F	F	S	-	N	4	T	D	-	-	1
KF Oval Flange													
Inlet													
F	Female												
Material													
S	1.4401 / 1.4404 / 316 / 316L	F	Duplex UNS S31803	V	Alloy 625 UNS N06625								
M	Alloy 400 UNS N04400	D	Super Duplex UNS S32750	B	6Mo UNS S31254								
H	Alloy C-276 UNS N10276	2	Super Duplex UNS S32760	T	Titanium Grade 2								
Material Option S as forging, all other materials made from flat bar													
Inlet													
Thread Type		Thread Size											
N	NPT	3	3/8										
H	BSP Parallel (G) - DIN 3852	4	1/2 (NPT Thread only)										
Outlet (Flange Connection)													
TD	Transmitter Interface DIN EN 61518-A												
T4	Transmitter Interface DIN EN 61518												
Options - Specify in alphabetical order (digits first, then letters)													
B	Cleaned for Oxygen Service (if ordered with Transmitter Mounting Kit - only with PTFE Seal Ring available)												
Accessory Kits for Oval Flange to Manifold/Transmitter mounting according to DIN EN 61518 (Not for Assembly c/w Wafer Style Manifolds)													
1	2 Hex Cap Screws 7/16-20 UNF, Carbon Steel A449 - Type 1, 1 PTFE Seal Ring												
2	2 Hex Cap Screws 7/16-20 UNF, Stainless Steel A193 B8 Cl.2, 1 PTFE Seal Ring												
3	2 Hex Cap Screws 7/16-20 UNF, Carbon Steel A449 - Type 1, 1 Graphite Seal Ring												
4	2 Hex Cap Screws 7/16-20 UNF, Stainless Steel A193 B8 Cl.2, 1 Graphite Seal Ring												

Wetted Parts according to a.m. material list are supplied according to NACE MR0175/MR0103 and ISO 15156 (latest issue) - except Titanium Grade 2.

Anti-Tamper Key ATK Type

ATK-ES Type



Check Valves

Check Valves CV Type

AS-Schneider Check Valves (Non-Return Valves) are designed for a cold working pressure rating of 10,000 psi (689 bar). The Check Valve allows flow in one direction only, closing when flow reverses. Should you still not find your option please contact the factory.

Features

- Soft Seated – O-Rings use-d are RGD (Rapid Gas Decompression) resistant
- Cracking Pressure: < 11 psi (0.75 bar)
- Re-Seal Pressure: < 20 psi (1.38 bar)
- Temperature Rating: -50°C up to +200°C (-58°F up to +392°F), depending on seal materials used
- 100% Pressure Tested – hydrostatically at 1.5 times the maximum working pressure
- Cv-Value: 0.3

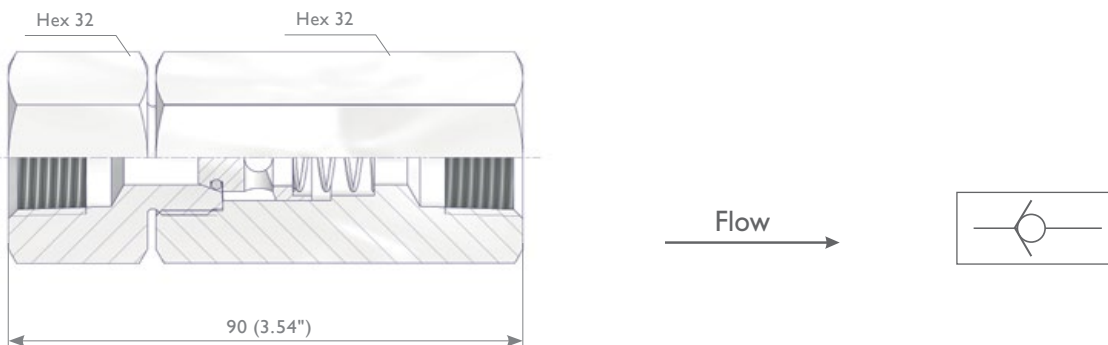

Ordering Information - Check Valves

	1	2	3	4	5	6	7	8	9	10	11	12	13	14
	C	V	F	F	S	K	-	N	4	N	4	-	M	
CV Check Valve														
Inlet														
M Male														
F Female														
Outlet														
F Female														
Material														
S 1.4401 / 1.4404 / 316 / 316L														
F Duplex UNS S31803														
M Alloy 400 UNS N04400														
D Super Duplex UNS S32750														
H Alloy C-276 UNS N10276														
2 Super Duplex UNS S32760														
V Alloy 625 UNS N06625														
B 6Mo UNS S31254														
T Titanium Grade 2														
Seal Ring														
K FKM - Fluorocarbon Rubber														
N HNBR - Hydrogenated Nitrile Butadiene Rubber														
P FFKM - Perfluorinated Rubber														
Inlet														
N2 1/4 NPT														
N4 1/2 NPT														
Outlet														
N2 1/4 NPT														
N4 1/2 NPT														
Options - Specify in alphabetical order (digits first, then letters)														
M Wetted Parts with 3.1 certificate														

Wetted Parts according to a.m. material list are supplied according to NACE MR0175/MR0103 and ISO 15156 (latest issue) - except Titanium Grade 2.

Note: Check Valves which are not actuated for a period of time may initially crack at a higher pressure than above stated.

Complementary Products

In this catalogue the following products are not described in detail because they are covered in catalogue AS-0201:

Gauge Protectors

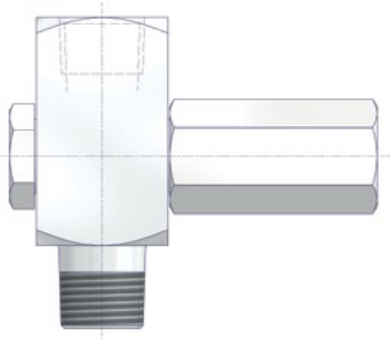

Gauge Snubbers



Compact Syphons

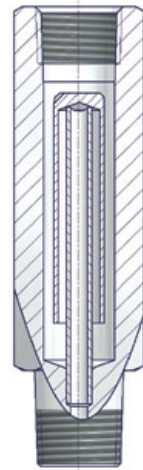

Coil Type Syphons / Pigtail Syphons

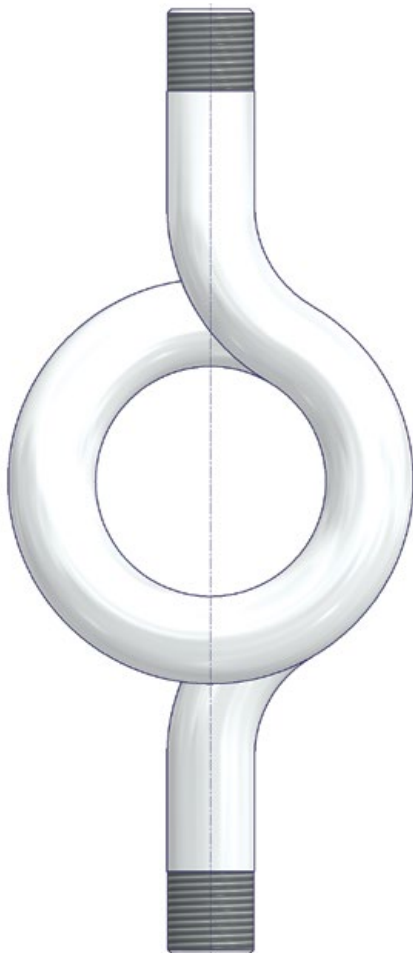

Elbows

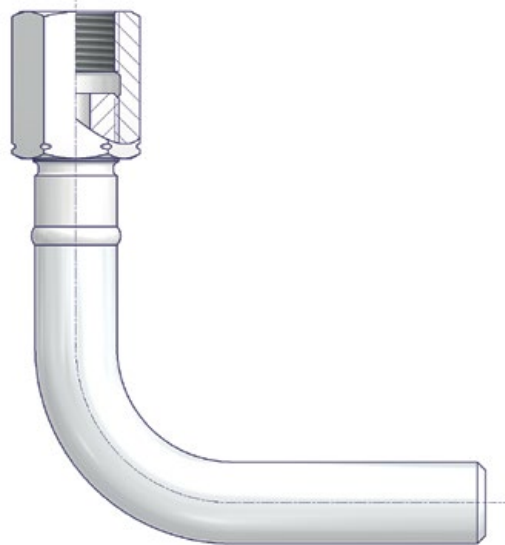



schneider

Tailored to Your Business



Armaturenfabrik Franz Schneider GmbH+Co. KG

Bahnhofplatz 12 | 74226 Nordheim
Deutschland / Germany

Tel: +49 71 33 101-0

Fax: +49 71 33 101-148



www.as-schneider.com



AS-Schneider Asia-Pacific Pte. Ltd.

970 Toa Payoh North, #02-12/14/15
Singapore 318992

Tel: +65 62 51 39 00

Fax: +65 62 51 39 90



www.as-schneider.sg



Armaturenfabrik Franz Schneider SRL

Sales Office:
Str. Basarabilor, Nr. 7 | 100036 Ploiesti
Romania

Tel: +40 244 384 963

Fax: +40 244 384 963

Production Plant:
Str. Mihai Viteazu, Nr. 327i | 507085 Harman
Jud. Braşov | Romania

Tel: +40 368 41 40 25

Fax: +40 368 41 40 26



www.as-schneider.ro



AS-Schneider Middle East FZE

P.O. Box 18749 | Dubai
United Arab Emirates

Tel: +971 4 880 85 75

Fax: +971 4 880 85 76



www.as-schneider.ae



AS-Schneider America, Inc.

17421 Village Green Dr | Houston, TX 77040
United States of America

Tel: +1 281 2 58 42 63

Fax: +1 281 5 06 79 35



www.as-schneider.com