

LISTEN.
THINK.
SOLVE.®

Product Data Sheet

Power Distribution Terminal Blocks
Catalog Number: 1492-50YF



Ratings:

175 Amps
600 Volts AC/DC
Panel Mount

Wire Range:

Line Side: (1) 2/0 - #14 AWG
Load Side: (1) ¼ - 20 Tapped Hole

Agency Approvals:

- UL Recognized, UL 1059 Terminal Block Standard – File #XCFR2.E40735
- CSA Certified, CSA C22.2 No. 158 (Wire Class B & C only)
- CE Compliant to IEC 60947-7-1
- RoHS Compliant

Electrical Ratings:

- 175 Amp Copper Wire (Based on NEC Table 310-16, 75°C Column)
- 600 Volts AC/DC (UL 1059 Class C, User Group – General Industrial)
- Factory and Field Wiring

Mechanical Ratings:

Mounting Information:

- Panel Mount: #10 Fastener, Torque to 25-30 in-lbs
- Terminal Keys Needed: 5/16"

Thermal Information*:

- Storage Temperature range:
 - -35°C to 110°C (-31°F to 230°F)

- Max. Insulator base temperature: 150°C (302°F) UL RTI
- Flammability rating of insulator base and base plate: UL 94 V-0

* Use outside these ratings needs to be judged in the end-use application.

Materials:

- Connector: High Conductivity Aluminum, Tin-Plated
- Insulator Base: Phenolic
- Terminal Set Screws: Aluminum, Tin-Plated
- Connector Mounting Screw: Steel, Zinc-Plated

Accessories:

- Clear Protective Plastic Cover. Catalog Number: 1492-PBC4
- Marking Strip: White vinyl strip to mark circuits (Supplied with block)



Product Data Sheet

Power Distribution Terminal Blocks
Catalog Number: 1492-50YF

Short Circuit Current Ratings (Copper Wire Only): Default Rating 10kA.

Wire Approvals:

Line Side Wire Approvals:

- Wire Strip Length, Line Side Tap – 3/4"



| Wire Size (AWG) | Torque (In-lbs) | UL Copper Wire Stranding Classes - Number of Strands | | | | | | |
|-----------------|-----------------|--|---------|---------|---------|---------|---------|---------|
| | | Solid | Class B | Class C | Class G | Class H | Class I | Class K |
| 2/0 | 120 | | 19 | 37 | | | | |
| 1/0 | 120 | | 19 | 37 | | | | |
| 1 | 120 | | 19 | 37 | 133* | 259* | 210* | 836* |
| 2 | 120 | | 7 | 19 | 49* | 133* | 161* | 665* |
| 4 | 120 | | 7 | 19 | 49* | 133* | 105* | 420* |
| 6 | 120 | | 7 | 19 | 49* | 133* | 63* | 266* |
| 8 | 40 | | 7 | 19 | 49* | 133* | 41* | 168* |
| 10 | 35 | 1 | 7 | 19 | | | 27* | 104* |
| 12 | 35 | 1 | 7 | 19 | | | 19* | 65* |
| 14 | 35 | 1 | 7 | 19 | | | 19* | 41* |

* Quantity of wire stands for classes G, H, I, K may vary by manufacturer

Load Side Wire Approvals:

- Wire Strip Length, Load Side Tap – 3/4"
- 1/4 - 20 Tapped Hole

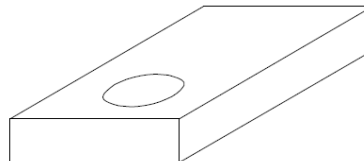



Product Data Sheet

Power Distribution Terminal Blocks
Catalog Number: 1492-50YF

Product Dimensions / Drawings:

| | |
|---|--|
| <p>1 1/8 [28.60]</p> <p>2 7/8 [73.03]</p> | <p>1492-50YF POWER BLOCK, TAP WITH BINDING SCREW BLOCK, 1 POLE 1 LINE-1 LOAD, 115 AMPS</p> |
| <p>1 25/32 [45.24]</p> | |